



SOLD

STUNNING VIEWS, STEEP DRIVEWAY, SET ON 1542M2, IN MAPLETON VILLAGE.

WOW! Here's a piece of heaven up a steep driveway in beautiful Mapleton Village. You can walk to everything that the village has to offer, with one huge difference. THE STUNNING VIEWS from the Deck, Lounge room, Main and 3rd bedroom. There are 3 good sized bedrooms, main with ensuite plus a study or 4th bedroom. The lounge/dining area is spacious with an open kitchen leading to a laundry with large walk in pantry. The deck that looks out to the Ocean Views and Hinterland Vistas is ideal for all weather entertaining. Being a North East aspect it's perfect for the cool breezes in this very private setting. Added to all this is a 11 x 7 two roller door powered shed. A bore that can be recommissioned and heaps (two tanks) of water storage. Oh! did I mention the house is Steel Framed and its septic (not pump-out). Come and inspect (by appointment only) as it won't last long.

3 BED | 2 BATH | 4 CAR

PRICE:
\$560,000

OPEN FOR INSPECTION:
N/A



Len Geary
0418221281
len.geary@atrealty.com.au
www.atrealty.com.au

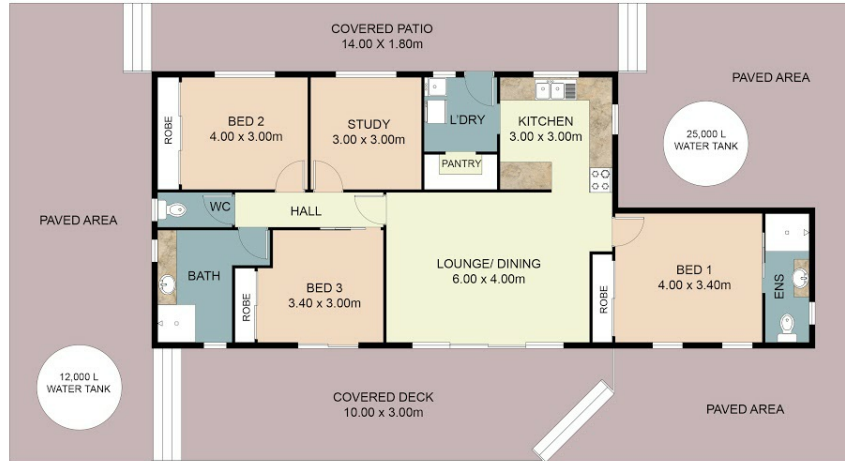
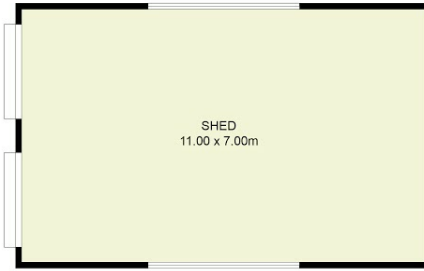

FLOOR PLAN

This floor plan including furniture, fixture measurements and dimensions are approximate and for illustrative purposes only. Boxbrownie.com gives no guarantee, warranty or representation as to the accuracy and layout. All enquiries must be directed to the agent, vendor or party representing this floor plan.

Disclaimer: Please note this floor plan is for marketing purposes and is to be used as a guide only. All dimensions are estimates only and may not be exact measurements.