

SOLD

PROPERTY SOLD PRIOR TO AUCTION CONTACT MICHELLE TOPPER

Approx. 300m To Coolangatta Beach. Only 1 of 8 apartments on 1012m2 development land is located within metres to Coolangatta, Cafes and Restaurants. Live and enjoy the beachside lifestyle or for the astute investor, a perfect investment.

Features include:

Positioned on the first floor, with a northerly aspect.

This fantastic apartment has an open plan lounge and dining area opening to the sunroom and the rear garden.

The kitchen has plenty of cupboard and bench space with electric appliances.

A spacious, light and airy master bedroom, built-in wardrobe and opens to the sunroom.

The second bedroom is also spacious, with a built-in wardrobe.

The main bathroom has been tastefully renovated with combined laundry and a separate toilet.

A large double garage with a remote garage door.

There is plenty of storage with two double linen cupboards within the apartment and plenty of storage room in the garage.

All this within a small block of only 8 apartments in the secure building with intercom security, low body corporate fees, and just a stroll to Coolangatta beaches.

Outgoings:

Body Corp: approx. \$59pw

Land Rates: approx. \$1620pa

Water Rates: approx. \$938pa

2 BED | 1 BATH | 2 CAR

PRICE:
\$541,000

OPEN FOR INSPECTION:
N/A



Michelle Topper
0400362639

michelle.topper@atrealty.com.au

www.atrealty.com.au

1/50 McLean Street, Coolangatta

MICHELLE TOPPER
REAL ESTATE
0400 362 639



2 1 2

internal: 109 m² | garage: 37 m² | total: 146 m²

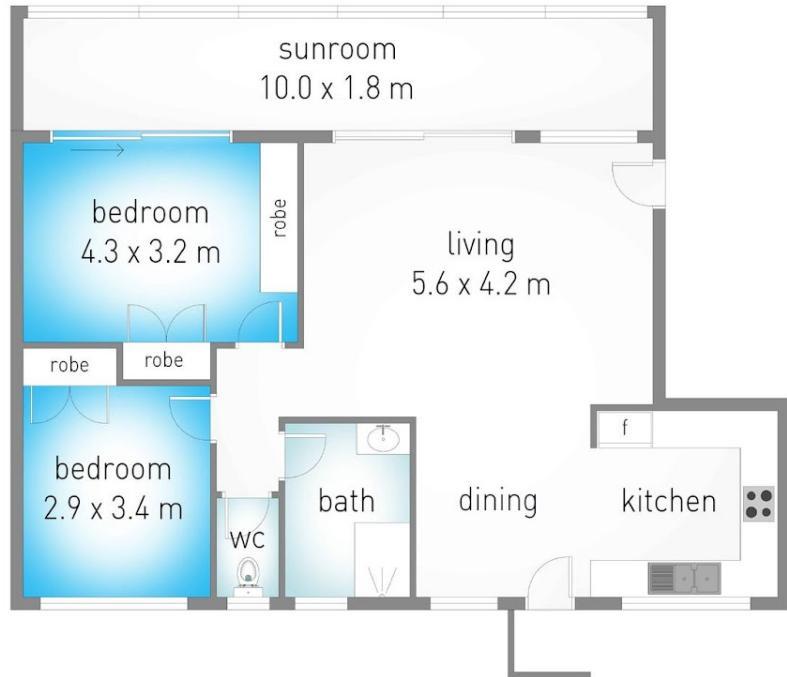
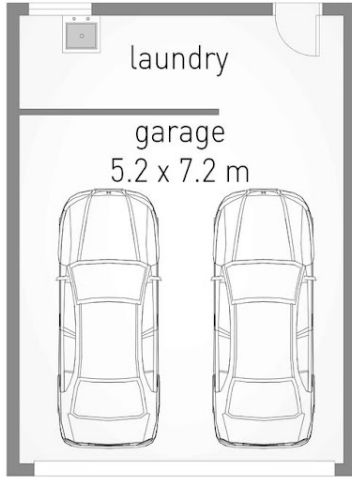

Dimensions are approximate. All information contained herein is gathered from sources we believe to be reliable. However we cannot guarantee its accuracy and interested persons should rely on their own enquiries.

Disclaimer: Please note this floor plan is for marketing purposes and is to be used as a guide only. All dimensions are estimates only and may not be exact measurements.

Michelle Topper
0400362639
michelle.topper@atrealty.com.au
www.atrealty.com.au

