



FOR SALE

AFFORDABLE WATERFRONT LIFESTYLE

This beautifully presented, private, waterfront property is nestled behind a large fence and secure gate. With high visibility location, an oversized garage and secure off street parking for an additional 3 vehicles, this home offers the unique opportunity to combine home, work and play.

The large, in-ground pool with separate spa and side shed is surrounded by tropical gardens and can easily be viewed from the modern open plan kitchen and dining area. With Caesar stone bench tops, a glass splash back, stainless steel appliances, and a 900mm cooker with 5 burner gas cook top and gas oven, this kitchen is the heart of the home.

The house offers 4 well sized bedrooms and 2 modern bathrooms with pebbled tiles. The private Master Bedroom enjoys stunning water views, an en - suite bathroom, plantation shutters and air conditioning. The house is also fitted with solar panels

The two fully tiled living areas are air conditioned, have 10ft ceilings and have beautiful water views. A third additional air conditioned living area, with private side access can be used as a 2nd TV room, office, play room or for dual income purposes.

The large waterside wooden deck includes a stunning Bali Hut and water feature for entertaining, relaxing and enjoying the breathtaking scenery. There is a substantial pontoon with electric winch and dry - doc facility for mooring a sizeable boat. This home boasts an 18m frontage to clear canal with white sandy beach and easy boating access to the Broadwater and beyond.

If you have dreamed of owning a unique waterfront property – step in and be amazed!

Affordable Waterfront Lifestyle

- Waterfront Private Property
- 18m frontage to clear canal
- Well Presented
- 4 bedrooms
- Separate Main en-suite
- 2 Bathrooms
- Garage + 3 car spaces
- Large In-ground Pool

4 BED | 2 BATH | 4 CAR

PRICE:

\$996,000 - CONTACT AGENT

OPEN FOR INSPECTION:

N/A



Ingrid Taylor

0406994911

ingrid@mandate2.com.au

mandate2.com.au

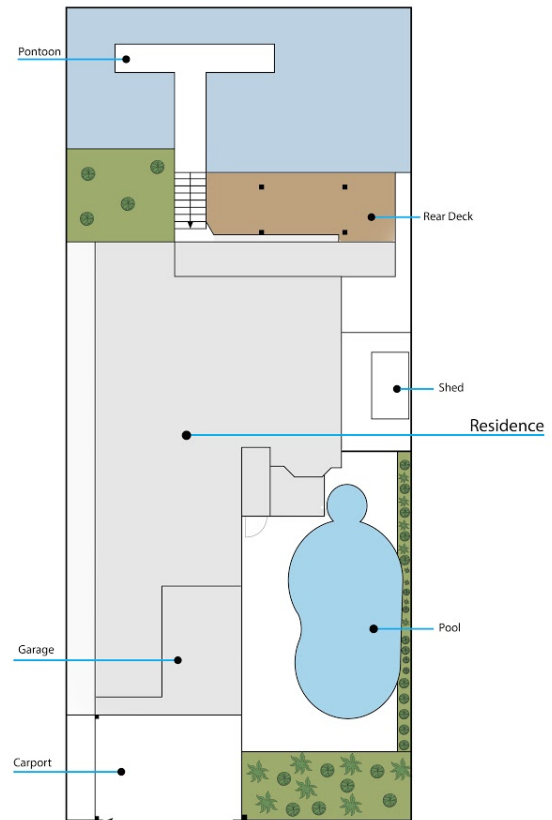

72 Oxley Drive, Paradise Point QLD, Australia

Internal 185m²

@realty

Disclaimer: Please note this floor plan is for marketing purposes and is to be used as a guide only. All dimensions are estimates only and may not be exact measurements.