



FOR SALE

RESORT STYLE APARTMENT AND FLAT WALK TO KIRRA BEACH

OPEN HOME AT 10.00-10.30AM

Living at Kirra is all about lifestyle. Only 400m to Kirra Beach from the resort style apartment on the 1st floor looking over the swimming pool.

This 2 bedroom, 2 bathroom unit in an exceptionally well presented complex of only 15 residential units in Kirra.

With a delightfully sunny balcony off the living room facing NE across the pool and swaying palms, you can enjoy this blissful lifestyle without having any neighbouring balconies or other buildings looking in at you.

There are many features this property has to offer:

- * Spacious sunny NE facing balcony for dining or relaxing
- * Open plan living area with direct balcony access
- * Renovated galley style kitchen with ample cupboard storage
- * Generous master bedroom with its own private balcony and ensuite bathroom
- * Good size second bedroom with built-in robes and loads of natural light
- * Spacious main bathroom plus separate laundry
- * Secure basement car space PLUS generous lock up storage cage
- * Beautiful residents pool and landscaped surrounds
- * Short flat walk to Kirra beach, shops, university and airport
- * Airconditioned.

Be quick to organise an inspection as a property of this calibre, so close to the beach, shops and other amenities won't last long in this hot market!

2 BED | 2 BATH | 1 CAR

PRICE:
\$525,000

OPEN FOR INSPECTION:
N/A



Michelle Topper
0400362639
michelle.topper@atrealty.com.au
www.atrealty.com.au

8/5 Ocean Street, Coolangatta

2 2 1

internal: 82 m² | external: 19 m² | total: 101 m²

MICHELLE TOPPER
REAL ESTATE
0400 362 639

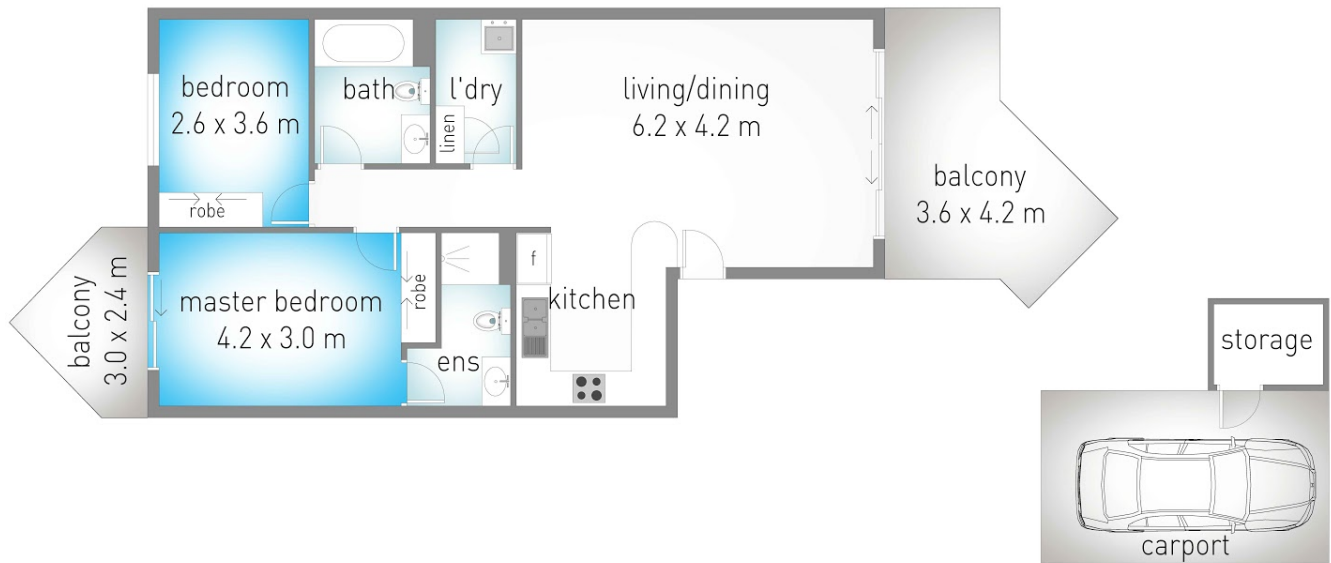

Dimensions are approximate. All information contained herein is gathered from sources we believe to be reliable. However we cannot guarantee its accuracy and interested persons should rely on their own enquiries.

Disclaimer: Please note this floor plan is for marketing purposes and is to be used as a guide only. All dimensions are estimates only and may not be exact measurements.