

88 CONDELL PARK ROAD WILTON



FOR SALE

FAMILY HOME WITH SWEEPING VIEWS IN BINGARA GORGE

This magnificent home has been cleverly designed with family living in mind. Spread over an impressive floorplan with three spacious living areas, each room flows seamlessly into the next and is accommodating to the whole family. The use of space has been maximised to encompass practicality and comfort. Quality features and inclusions can be admired at every turn and the sweeping views across the street can be admired all year round.

Features Include:

- Paved front porch, perfect to relax & soak in the views
- Boasting four generously proportioned bedrooms with built in robes
- The master suite includes a walk in robe & an ensuite
- Formal lounge to the front of the home
- Media room
- Family room
- Dining room
- Study
- Galley style kitchen with ample cupboard & bench space
- Walk in pantry
- Gas cooking
- Stainless steel dishwasher
- Breakfast bar overlooking the family room
- Main bathroom includes a bathtub & floor to ceiling tiling
- Ample amount of internal storage
- Ducted air conditioning
- LED Downlights
- Paved alfresco with ceiling fan
- Fantastic sized, low maintenance backyard
- Side access to backyard
- Double garage with remote & internal access
- 581sqm block

This wonderful home is conveniently located within walking distance to the local shops at Wilton Plaza, the local school & child friendly playgrounds. Bingara Gorge is a prestigious estate

4 BED | 2 BATH | 2 CAR

PRICE:

\$779,000 - \$799,000

OPEN FOR INSPECTION:

N/A



Adam Bryant

0455672323

adam@atrealty.com.au

www.atrealty.com.au

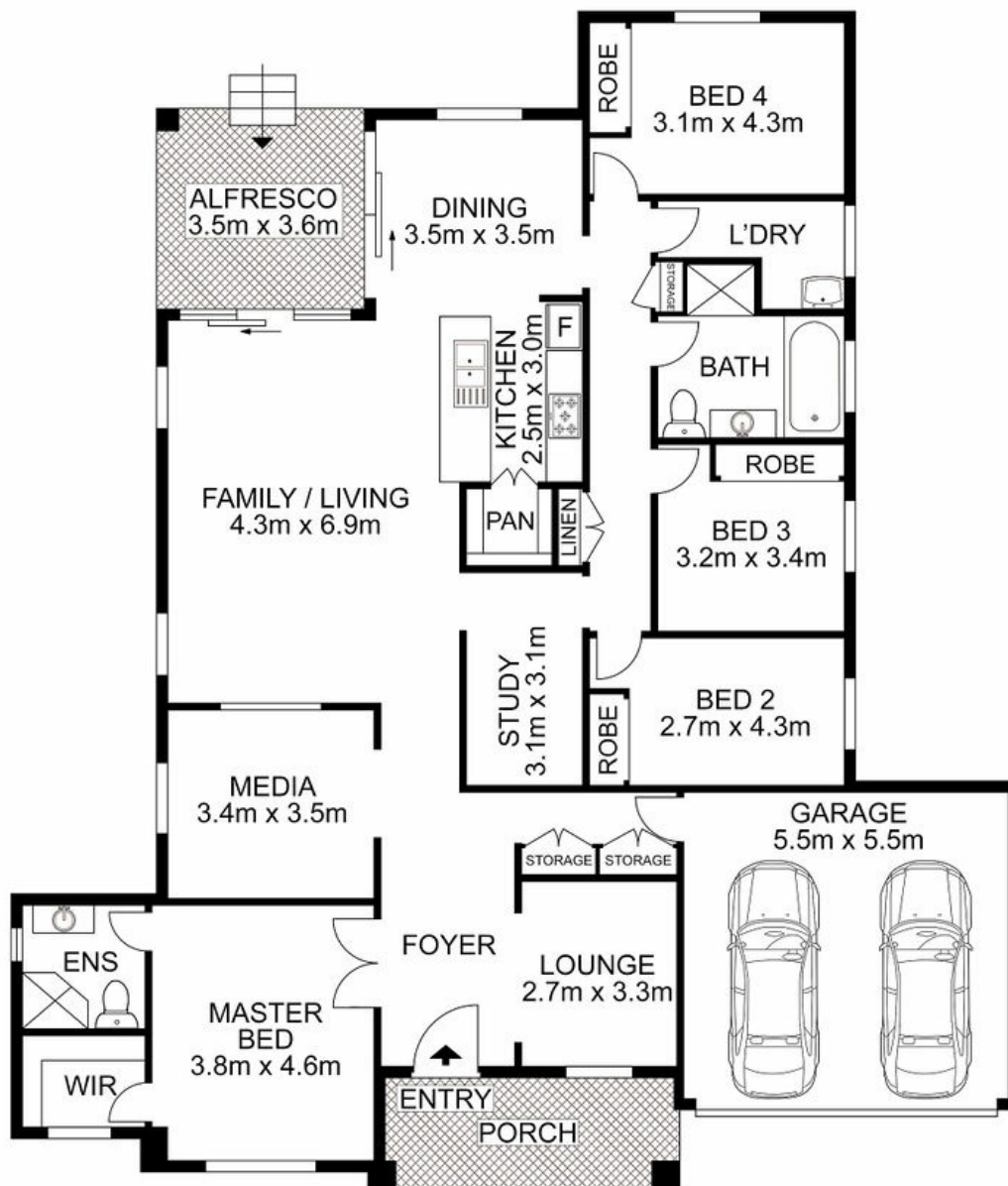

AGENCY

Disclaimer: Please note this floor plan is for marketing purposes and is to be used as a guide only. All dimensions are estimates only and may not be exact measurements.

88 Condell Park Road, Wilton

Adam Bryant
 0455672323
 adam@atrealty.com.au
www.atrealty.com.au

