



# FOR SALE

## BEACHFRONT APARTMENT PRICE REDUCED

A rare opportunity to purchase this sizeable 124m<sup>2</sup> – 3-bedroom beach front apartment directly opposite Kirra Beach. Sensational views, never to be built out and designed to allow the breezes to flow through from front to the back of this apartment. All this within a small block of only 20 apartments.

### Features include:

- Ocean views from the living and master suite opening to the balcony.
- There is an abundance of space in the living and dining areas.
- Open plan kitchen, electrical appliances and there is plenty of cupboard and bench space.
- The master bedroom has views of Kirra beach and opens to the beachside balcony. There is a walk-in robe and an ensuite to complete the master suite.
- There are two additional bedrooms both with built-ins and views of the mountains. The third bedroom has a private balcony to the rear of the apartment, perfect area to dry the washing.
- The main bathroom offers a bath, shower, and vanity with a separate toilet.
- Large separate laundry.
- Secure basement carpark.
- Only 20 apartments within this beachfront Centre Court building, and only 4 apartments per floor.
- Sparkling residents pool and a spacious landscaped terrace to relax in the sun.
- There is a lift in building plus a secure intercom access.
- Privately positioned above Kirra café precinct.

Beachfront living from this 124m<sup>2</sup> original 3 bedroom apartment. Superbly positioned in the heart of Kirra.

Alfresco dining, trendy cafes, shops, walkways, and bike tracks are all right at your doorstep, with the airport and university only minutes away.

Currently rented for \$550.00 pw until 28/04/2021.

Body Corporate Fees: \$123.85pw

3 BED | 2 BATH | 1 CAR

PRICE:  
\$839,000

OPEN FOR INSPECTION:  
N/A



**Michelle Topper**  
**0400362639**  
michelle.topper@atrealty.com.au  
[www.atrealty.com.au](http://www.atrealty.com.au)

# 19/32 Musgrave Street, Coolangatta

3 2 1

internal: 112 m<sup>2</sup> | external: 12 m<sup>2</sup> | total: 124 m<sup>2</sup>

MICHELLE TOPPER  
REAL ESTATE  
0400 362 639

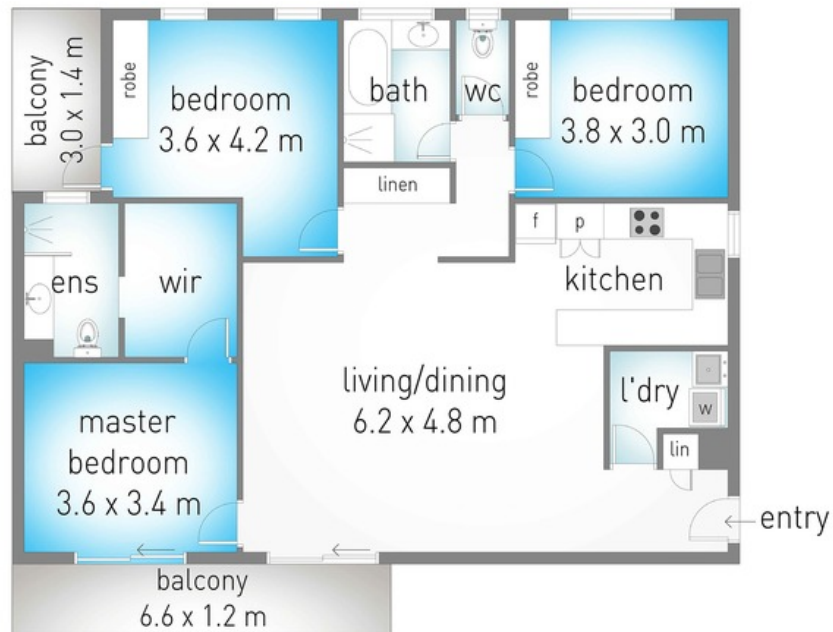

Dimensions are approximate. All information contained herein is gathered from sources we believe to be reliable. However we cannot guarantee its accuracy and interested persons should rely on their own enquiries.

Disclaimer: Please note this floor plan is for marketing purposes and is to be used as a guide only. All dimensions are estimates only and may not be exact measurements.