



SOLD

SPACIOUS, VERSATILE AND WONDERFULLY SERENE

Presenting to the market an architecturally designed four bedroom plus study elevated home on a sizable 1,282m² block with caravan and boat pad down the side, the underneath of this home houses the "shed" of all sheds... accommodating cars, workshop, toys for all ages, storage storage and more storage! Meticulously kept and located in the sought after Greenwood's Estate of Cashmere this home represents value for money!

As you enter through the impressive double entry doors you are greeted with gorgeous high ceilings and polished timber floors with the study off to your left, the home quite literally unfolds before you and welcomes you into the social entertaining hub. Galley style kitchen with electric cooktop, 600mm oven, built in microwave, dishwasher and an amazing amount of storage and pantry space. The air-conditioned, open plan living and dining seamlessly lead to the oversized alfresco entertaining deck – whether it's first thing in the morning with a cuppa or relaxing at the end of the day with a glass of bubbles this is a space that will get used all year round, the green outlook will never get tiresome.

Back inside you will discover the four bedrooms, all generous in size with built in robes and ceiling fans with the Master retreat offering a walk in robe, air-conditioning and ensuite with a separate corner spa bath for those days where you just need that little bit extra relaxation before retiring for the night!

If your tick list includes a shed, caravan parking, pool... look no further... we have the shed well and truly covered, caravan/boat parking tick x 3, pool – plenty of room for one! This home is immaculate and will not last long, don't delay call Natalie today on 0419689309.

At a Glance:

- Well positioned 1,282m² Block
- 4 Bedrooms + Study
- Caravan and Boat Parking at side
- Large Alfresco Deck
- High Ceilings
- Air Conditioning
- Solar – 3kw

4 BED | 2 BATH | 5 CAR

PRICE:
\$850,500

OPEN FOR INSPECTION:
N/A



Natalie Johnston
0419689309
natalie@atrealty.com.au
[Natalieatrealty](#)

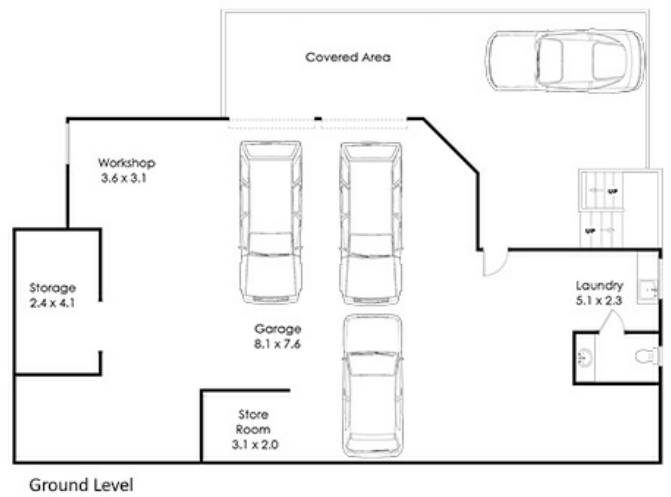
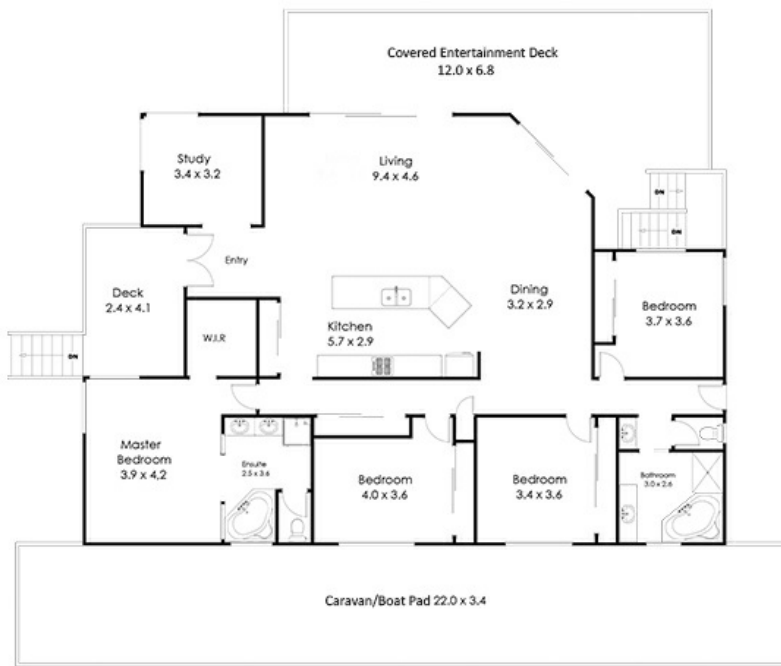

Total Living area plus ground level: 350.sqm

3 Pardalote Place Cashmere 4500

Whilst every attempt has been made to ensure the accuracy of the floor plan contained here, measurements of doors, windows rooms and any other items and structures are approximate and no responsibility is taken for any error, omission or mis-statement. Bathroom and kitchen fittings, cupboards and door types and laundry appliances and windows are taken and approximate the actual fitting installed.
This plan is for illustrative purposes and should be used as such by any prospective buyer.
Plan drawn by Eagle Eye Photography Service, www.eagleeyehq.com.au Copyright 2020.
All rights reserved.
No reproduction without licence, contact photographer for more information.

@realty

Disclaimer: Please note this floor plan is for marketing purposes and is to be used as a guide only. All dimensions are estimates only and may not be exact measurements.