

6 WEST END STREET, MURWILLUMBAH, NSW, 2484

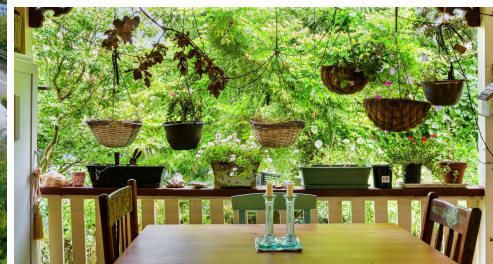

SOLD

HISTORICAL HEART... TOWN CENTRAL

You will be enchanted by this original 102 year old period piece in the heart of Murwillumbah. From the moment you set eyes on this beautiful old dame you will feel the impulse to embrace her charms and will most likely fall in love all over again.

Upon stepping through the gate and wandering down the rustic pathway to her open arms you will be drawn to the entry stairwell leading you onto the private wraparound timber deck which allows several access points to this lovingly maintained home.

Her unique features of original vj boards, polished timber floors, high ceilings and ornate stained glass windows and doors will have you reminiscing about simpler times.

The current owners have kept true to the homes original character with their tasteful refurbishments and furnishings giving the impression of stepping back in time.

Situated privately in a sought after position within walking distance to all the historic town of Murwillumbah has to offer with its newly energized arts and foodie scene you will feel very much at home in the heart of town.

Call for further information or book your private inspection.

Disclaimer

All information (including but not limited to the property area, floor size, price, address and general property description) is provided as a convenience to you and has been provided to Northern Rivers Property Group / @realty by third parties.

This Information should not be relied upon alone and you should make your own enquiries and seek legal advice in respect to all information about the property contained in this advertisement.

3 BED | 1 BATH | 1 CAR

PRICE:
\$666,666

OPEN FOR INSPECTION:
N/A



Paul Stobbie
0448191351
paulstobbie@atrealty.com.au
northernriverspropertygroup

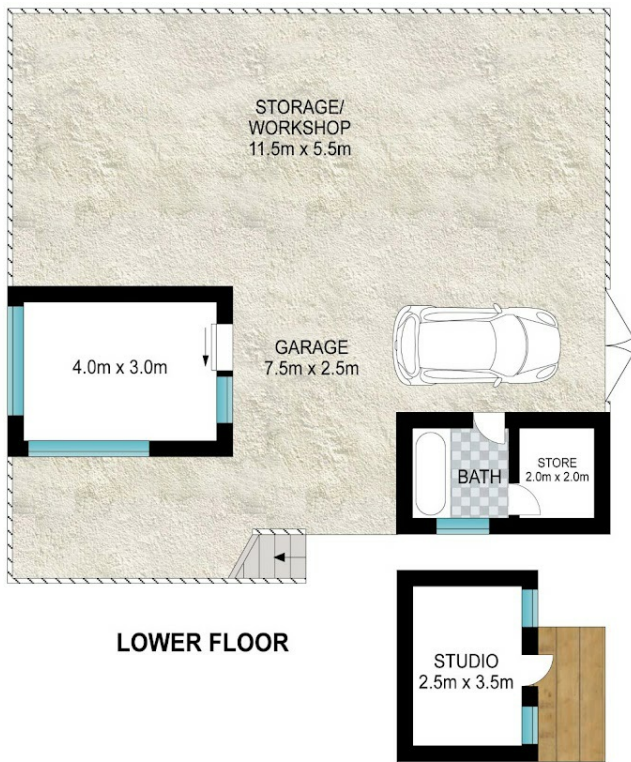

Scale in metres. Indicative only. Dimensions are approximate. All information contained herein is gathered from sources we believe to be reliable. However, we cannot guarantee its accuracy and interested persons should rely on their own enquiries.

INT: 88 m²
EXT: 50 m²

6 West End Street, Murwillumbah



Disclaimer: Please note this floor plan is for marketing purposes and is to be used as a guide only. All dimensions are estimates only and may not be exact measurements.

Paul Stobbie
0448191351
paulstobbie@atrealty.com.au
northernriverspropertygroup

