



**SOLD**

## BUY IT, BETTER IT, BENEFIT!

With good bones this home is just screaming at you "Potential" and can become whatever your imagination allows it to be! For an entry level home, its very rare to find a property that offers 4 bedrooms and 2 bathrooms in this price range. Even though it needs some love, its a fully functional home, where you can live in comfortably, whilst you renovate over time. With the standard "post war" design of the 1950's, and angled roof line, this property would look so amazing and modern with a rendered exterior.

Strong and sturdy with a floor plan of approximately 162m2 in size, this home offers plenty of room for larger families. A wide entrance hall leads you into the home with a spacious separate lounge to the right, which receives plenty of light, and a huge bedroom to the left.

The well equipped kitchen has plenty of counter and cupboard space and steps down into the dining area. Off the dining area is private main bedroom, complete with corner robes that then leads into the ensuite. Bedroom 2, 3, the laundry and main bathroom are all connected by the main hallway.

The yard is fully fenced, with plenty of off street parking. a carport and garage with roller door.

There are tenants currently in residence at the property on a month by month lease, which gives the opportunity for both owner occupiers and investors to secure this home.

Please note that this property is only available to view at the schedules open home times.

**4 BED | 2 BATH | 2 CAR**

**PRICE:**  
**\$385,000**

**OPEN FOR INSPECTION:**  
**N/A**



**Nikki Moller**  
**0408924765**  
nikkimoller@atrealty.com.au  
[www.atrealty.com.au](http://www.atrealty.com.au)

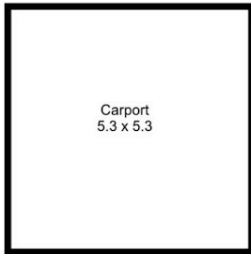
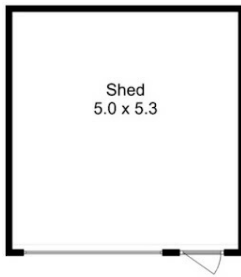

House Floor Area approx: 162sqm

All measurements are internal and approximate  
This plan is a sketch for illustration not valuation  
Produced by open2view.com

Disclaimer: Please note this floor plan is for marketing purposes and is to be used as a guide only. All dimensions are estimates only and may not be exact measurements.