



SOLD

ANOTHER SOLD BY GEOFF TUTT

This is a great home built on a large 729 sqm block and overlooking a natural setting. It is located approximately 150 metres from the beautiful waters of Pumicestone Passage and a short walk to the shopping centre and bowling club. Close by you will find great park facilities along the esplanade, perfect for a barbecue, gathering or some outdoor exercise, plus the opportunity of seeing beautiful wildlife including kangaroos just metres from your front door. It is also a short distance to the island's national park.

The home features three bedrooms, open plan kitchen/living, separate lounge/dining, one bathroom, separate toilet and double garage. The main bedroom is spacious and has access to a 2-way bathroom, with the other two bedrooms being a good size and all with built-in wardrobes. The living area leads out through sliding doors to a large covered outdoor patio overlooking the sparkling saltwater swimming pool and lush tropical gardens. Look at these additional features:

- 1.5 kws solar power & ceiling fans
- Recent roof restoration
- Side access for a trailer or small boat
- Plantation shutters to main bedroom and living room
- Spear pump
- Reverse cycle air conditioning to main bedroom
- Garden shed
- Well-maintained gardens

This is a great opportunity, so don't miss out, give Geoff (your local agent) a call on 0414 230 130 to arrange your private inspection today.

3 BED | 1 BATH | 2 CAR

PRICE:
\$555,000

OPEN FOR INSPECTION:
N/A



Geoff and Rose Tutt
0414230130
geoff@atrealty.com.au
www.atrealty.com.au

This floor plan should be used as a guide only

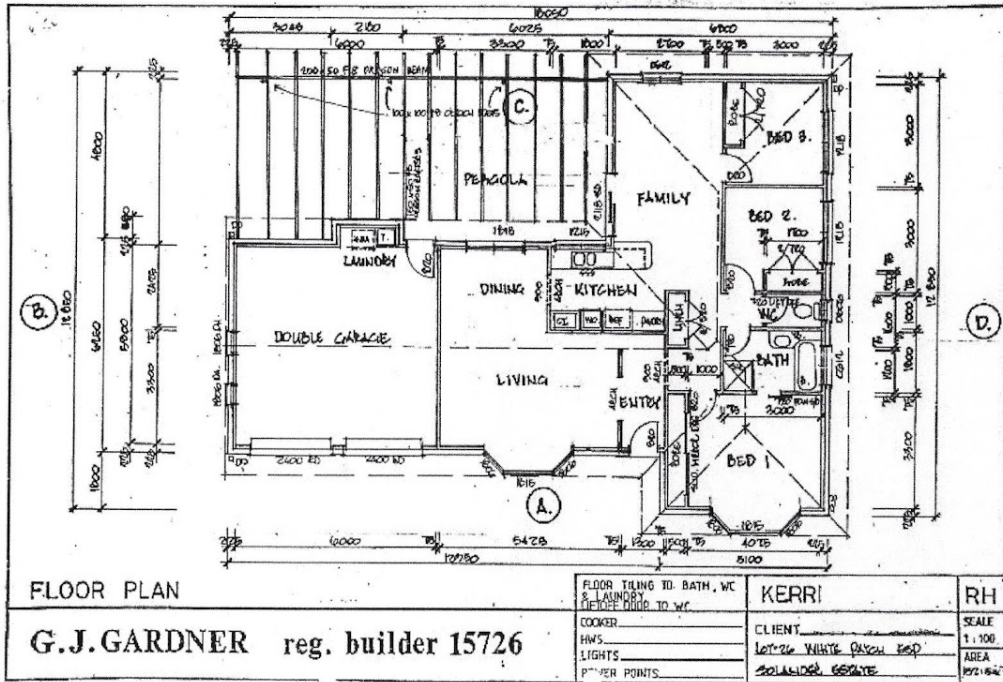

Disclaimer: Please note this floor plan is for marketing purposes and is to be used as a guide only. All dimensions are estimates only and may not be exact measurements.