



# SOLD

## UNDER CONTRACT STUNNING 3 BEDROOM NORTH FACING APARTMENT KIRRA

This stunning 3-bedroom private apartment offers a sea change and tree change. Positioned on the 2nd floor of this boutique apartment block with the peaceful ambiance of the trees and bird life from the balcony and only a short flat walk of 150m to Kirra Beach.

Kirra / Coolangatta beaches are renowned worldwide for sun, surf, crystal-clear waters, and endless stretch of sandy beaches. This could be your new backyard. Take it all in from the seaside cafes or the convenience of your beach-side living.

### Property Specifications:

The high ceilings and stacker doors add to the design with an open plan lounge, dining, and kitchen areas, opening to the wide north facing under cover balcony which stretches the width of the apartment. The balcony feels like an extension from the living area, where you will spend many hours enjoying the ambiance of the tranquil surrounds.

The kitchen is light and airy, and the design is complimented with a glass splash back, stone bench tops, island breakfast bar and plantation shutters. There are gas hotplates, an integrated oven, microwave, and a dishwasher.

The master suite is light and airy with built-in wardrobes and a private ensuite. The second and third bedrooms has built ins.

The main bathroom is designed in neutral tones and is centrally located to bedroom 2 and bedroom 3.

There is the convenience of a separate laundry, 2 tandem car spaces within a secure car parking area.

Southbeach Apartments is a small residential apartment block of only 16 apartments positioned in a quiet cul-de-sac of this beach side suburb of Kirra / Coolangatta.

The residence enjoys the convenience of the resort style pool with the decking next to the tree line park. Convenience of rear gate access to the parkland and direct to the beach.

3 BED | 2 BATH | 2 CAR

PRICE:  
\$915,000

OPEN FOR INSPECTION:  
N/A



**Michelle Topper**  
**0400362639**  
 michelle.topper@atrealty.com.au  
[www.atrealty.com.au](http://www.atrealty.com.au)



internal: 108 m<sup>2</sup> | external: 17 m<sup>2</sup> | total: 125 m<sup>2</sup>

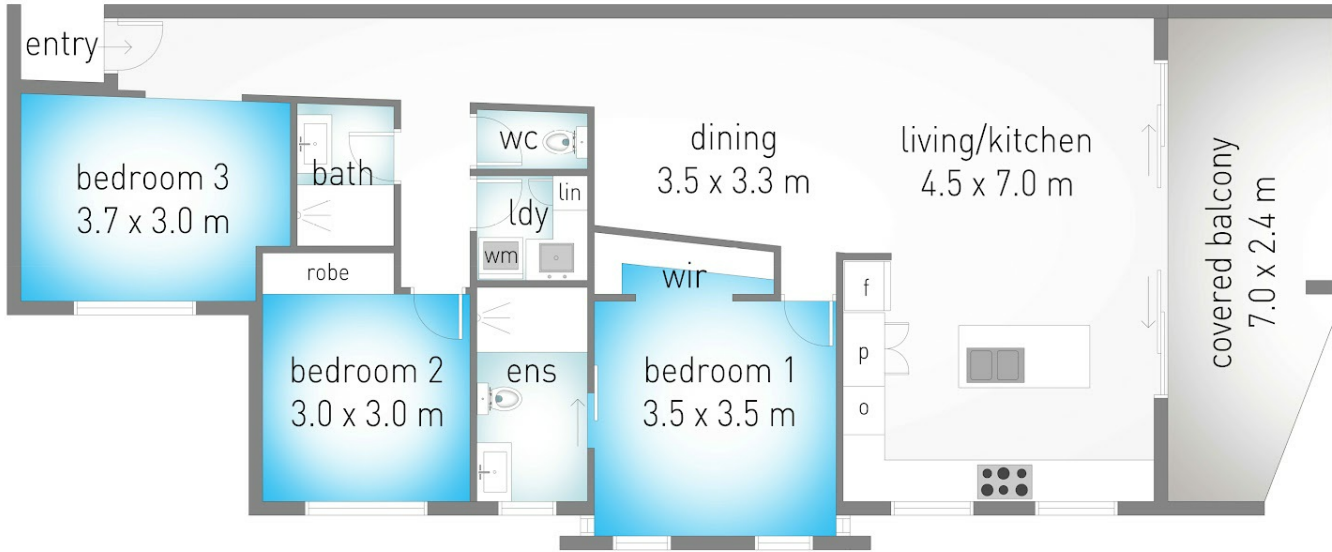

Dimensions are approximate. All information contained herein is gathered from sources we believe to be reliable. However we cannot guarantee its accuracy and interested persons should rely on their own enquiries.



Disclaimer: Please note this floor plan is for marketing purposes and is to be used as a guide only. All dimensions are estimates only and may not be exact measurements.