

SOLD

3335M2 OF PRIVACY AND SPACE FOR THE FAMILY!

3335m2 Block gently sloping with Landscaped Gardens and plenty of privacy on offer. Great Location and Only minutes to the Bruce Highway.

The Features Include;

- * 4 Built in Bedrooms - Master Bedroom with Ensuite & Walk through Robe
- * Formal Lounge & Dining
- * Well appointed kitchen & Family room
- * Slate Floors & High ceilings
- * Split System Air conditioning
- * Massive full length Outdoor Entertainment area with Balcony at the Front of Home
- * Double Lock up Garage & Single Carport on House
- * Shed approx. 9m x 6m with 6m x 3m awning
- * Water Tanks
- * Insulated with Cool N Cosy
- * Side Access

This is a lovely home and with a few nips and tucks could be absolutely beautiful. The gardens are just so serene and there is still room to add your own touches.

For further information, please Contact GAIL BERNARDIN on 0418 645 506

4 BED | 2 BATH | 6 CAR

PRICE:
\$658,000

OPEN FOR INSPECTION:
N/A



Gail Bernardin
0418645506
gail@creedonpropertygroup.com
www.gailbernardin.com.au

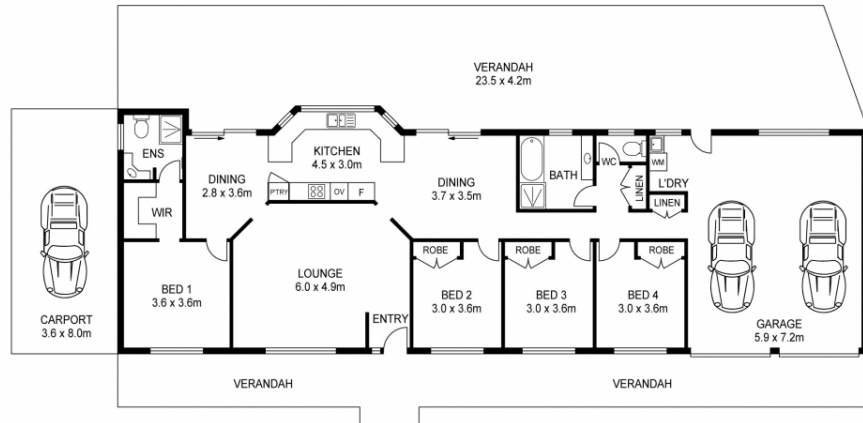
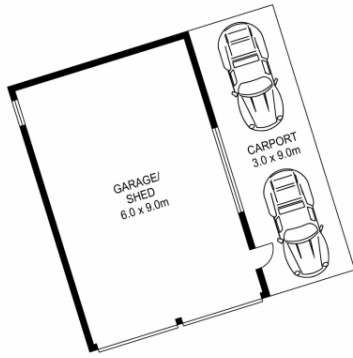

0m 2m 4m 6m 8m **SCALE (METRES)**

PLANS SHOWN ONLY INDICATIVE OF LAYOUT. DIMENSIONS ARE APPROXIMATE.

Disclaimer: Please note this floor plan is for marketing purposes and is to be used as a guide only. All dimensions are estimates only and may not be exact measurements.