



## FOR SALE

### EXTRAS ARE A PLENTY

Positioned in a popular Southern Suburb in walking distance to Woodcroft Collage, Woodcroft Shopping Centre and transport, sits this spacious home in a no through road. Solar Panels, undated roof and Guttering, Roller Shutters are some of the bonuses on offer. Comprising of a separate entrance and 2 spacious living areas allowing the family to spread out. The master bedroom is large enough to accommodate a King sized bed with a walk in robe and ensuite. Bedrooms 2 and 3 are big enough to home double beds and have built-in robes. The kitchen has new stainless steel appliances and a new modern backsplash overlooking the undercover entertaining area. If you work from home or have a hobby there is an extra valuable space with a lined shed/ rumpus room with power. Possible extra access for a caravan or trailer. Ducted evaporative cooling, gas heating for year round comfort makes this home complete. Come and add your own touches!

3 BED | 2 BATH | 2 CAR

**PRICE:**  
\$359,000-389,000

**OPEN FOR INSPECTION:**  
N/A



**Tricia Kernahan**  
**0457314206**  
tricia@atrealty.com.au  
[tfkrealestate.com.au](http://tfkrealestate.com.au)  
RLA: 269823

# 5 Muirfield Place, Morphett Vale

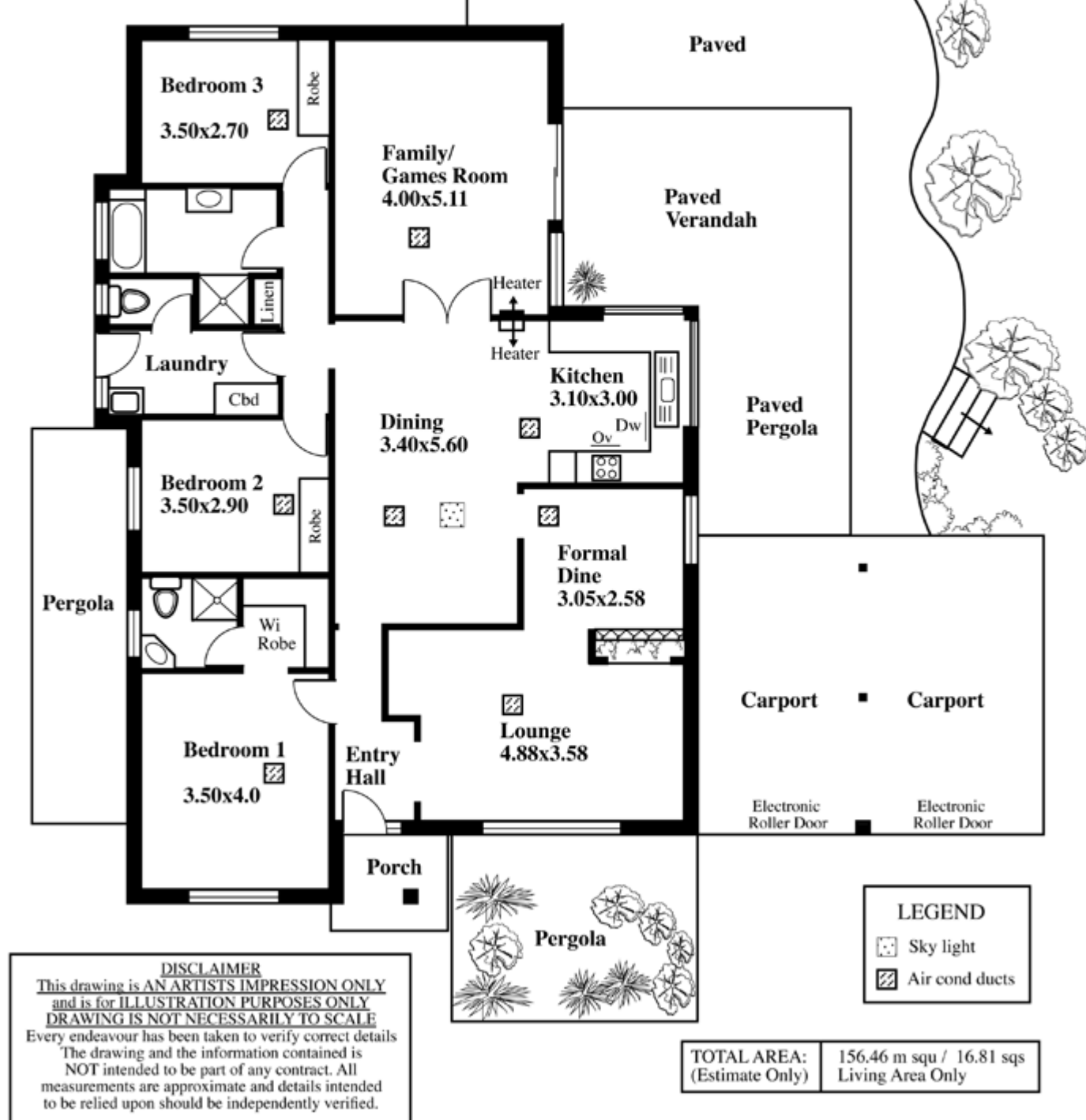

Disclaimer: Please note this floor plan is for marketing purposes and is to be used as a guide only. All dimensions are estimates only and may not be exact measurements.