



**SOLD**

## PRIVATE RARE SETTING IN EXCLUSIVE ESTATE

This large family home in Bangalow Nth NSW is on one of 8 rare large blocks backing onto a creek and farmland. It is currently tenanted so we cannot get any internal photos but you can look on Domain.com.au and check them out from when it was last listed.

The home is custom designed and built with nothing spared to cater for a the most discerning buyer. Granite kitchen bench tops, high ceilings, large rooms, and storage to burn. The home flows seamlessly from entrance to rear and caters for covered/uncovered out door alfresco dining with views to the bush.

The owners carefully thought out the back yard with retaining walls and intricate water features leading down to a grassy clearing by the creek where they had many happy summer drinkies/BBQs with their kids and friends

What an amazing offering at this time when people are leaving the big cities for a tree change. Escape to the country is right on with this property. Big house..big land..big opportunity, with room for a pool, trampoline, flying fox to the creek and much much more.

Bangalow is such a great place to call home as the weather is devine. Walk to town for a coffee and close enough to Byron Bay or Lennox Head for a surf and just up the freeway is Snapper Rocks and the Gold Coast.

Be quick to inspect and buy as the vendors are motivated and priced to sell. Call Vaino from @realty realestate on 0487026765 or email to vaino@atrealty.com.au

\* DISCLAIMER. The photos of inside the house are prior to the tenants moving in. It now looks different with their furniture, styling and personal belongings.

- Large block – very private – 1600m2 approx
- Mauri Creek on rear boundary
- Architect designed and master built
- House fully insulated on both external and internal walls
- Extra large double garage with separate storage
- Landscaped gardens with water features
- 4 bedrooms – 3 with robes
- Ensuite to main bedroom and walk in robe
- Main bathroom with spa bath
- Separate powder room off living area
- High ceilings
- Extra wide hallway

4 BED | 3 BATH | 4 CAR

PRICE:  
\$1,472,500

OPEN FOR INSPECTION:  
N/A



**Vaino Lillioja**  
**0487026765**  
vaino@atrealty.com.au  
Lennox Head Prestige Property

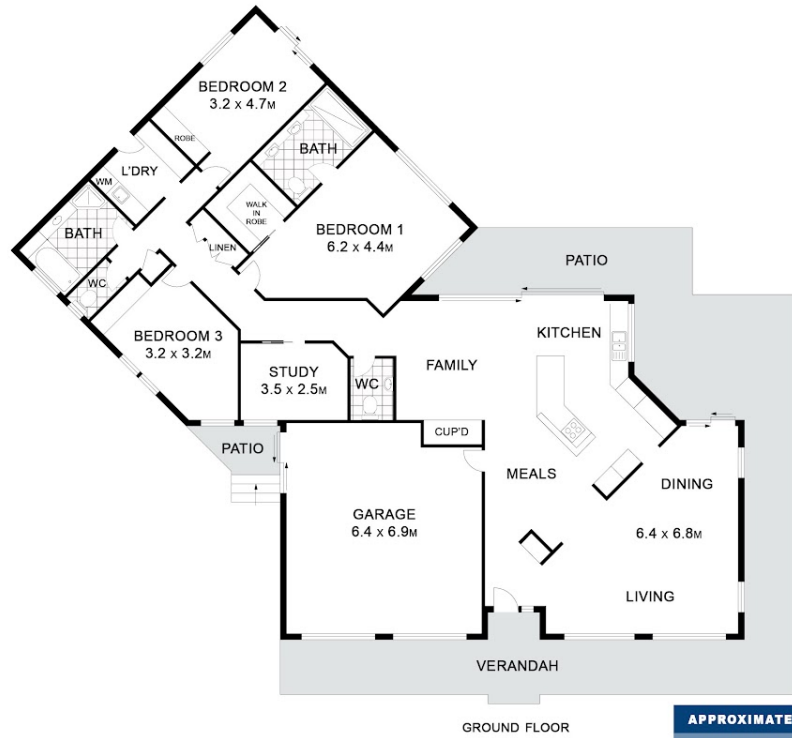

**2 Palm Lily Crescent BANGALOW**

Floor Plan Disclaimer: Media Drive (MD) floor plans / site plans are intended as an approximate guide only. No representations or warranties of any nature are given or intended and any person using this information other than as a guide should always rely on their own enquiries. Media Drive property marketing services / 0413979054 / Photography, Floor plans, Video, Aerial photography / www.mediadrive.com.au

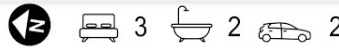

APPROXIMATE AREAS @realty	
INTERNAL FLOOR SPACE	- 202m <sup>2</sup>
EXTERNAL FLOOR SPACE	- 88m <sup>2</sup>
GARAGE	- 44m <sup>2</sup>

Disclaimer: Please note this floor plan is for marketing purposes and is to be used as a guide only. All dimensions are estimates only and may not be exact measurements.