

## FOR SALE

### EASY LIVING... IDEAL DOWNSIZER OR WEEKENDER

Life is simple in Reflections Coffs Harbour Holiday Park. As only one of three permanent sites, this home is ideal for someone seeking a quiet, relaxed lifestyle with endless perks of living in this secure and secluded location.

This home has been stunningly transformed, renovated with brand new, state-of-the-art appliances and only the best quality materials - from new carpet in the main living area and master bedroom, to wood-look vinyl flooring in the kitchen and private bathroom. There is ample storage and lots of natural light available.

In a secluded and safe environment, this home is accessible via one entrance which from 9-5 Monday to Friday and for a small time on weekends is under constant supervision. Walking distance to Coffs CBD filled with cafes, restaurants, the CEX Club and Restaurant, Bakery and Woolworths, and also around the corner from the Coffs Harbour Memorial Pool everything you need is within reach.

#### Key features:

- Renovated one bedroom home with brand new kitchen and appliances.
- Air-conditioning and undercover alfresco area.
- NBN connected.
- Lots of natural light.
- No immediate neighbours, secure and private.
- \$116 per week site rental fee, all utilities included.
- Private vehicle access via the main entrance, passcode required.
- Prominent inner city location, walking distance to Coffs CBD.
- 8 minute walk to Woolworths.
- 6 minute walk to Coffs Mall.
- 5 minute walk to Coffs RSL.
- 2 minute walk to Coffs Harbour Memorial Pool.
- 250 metre walk to Coffs Police Station.
- Bus Bay located directly outside Park.

Call today to book your viewing on 0447 099 106.

1 BED | 1 BATH | 0 CAR

PRICE:  
\$175,000

OPEN FOR INSPECTION:  
N/A



**Jack Anderson**  
0447099106  
jackanderson@atrealty.com.au  
[www.atrealty.com.au](http://www.atrealty.com.au)

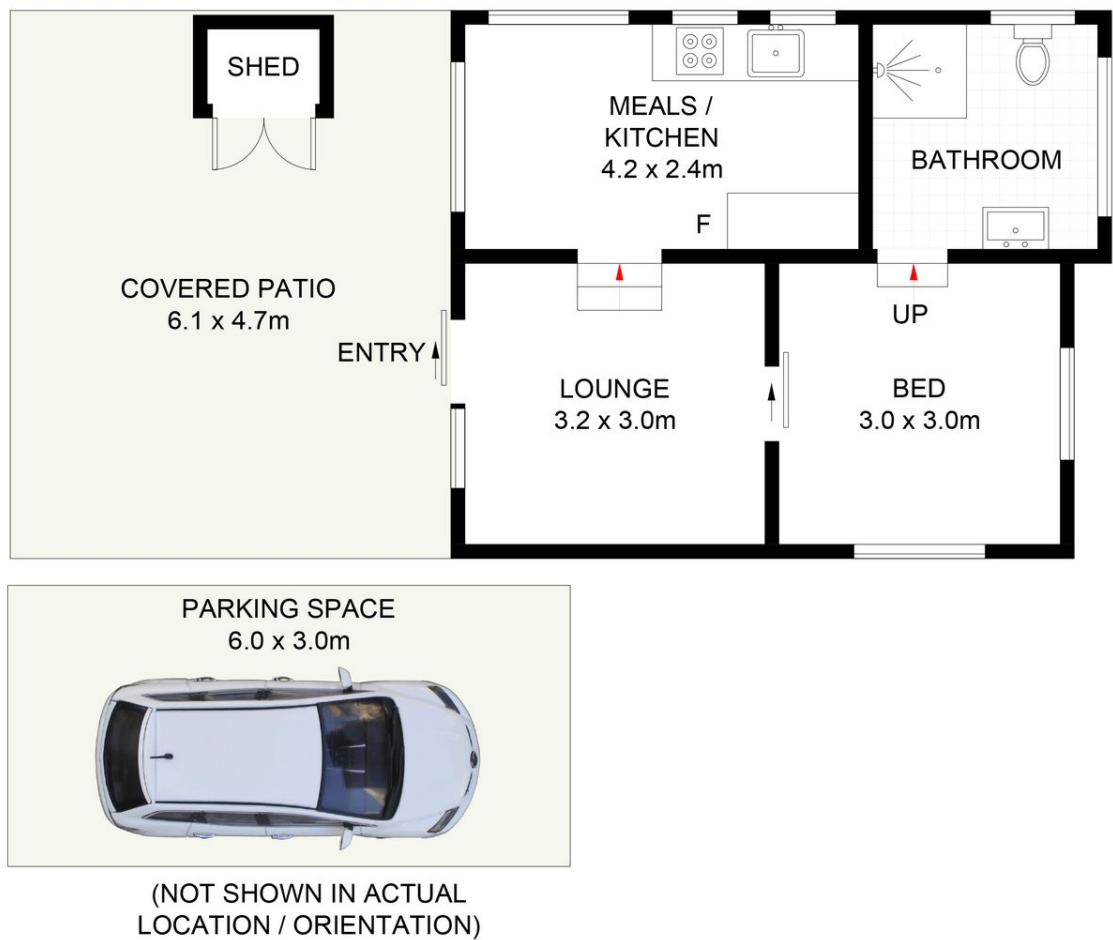

32/123 Pacific Highway, Coffs Harbour, NSW 2450

DISCLAIMER: PLANS SHOWN ARE FOR PRESENTATION PURPOSES AND ARE NOT PART OF ANY LEGAL DOCUMENT. ALL MEASUREMENTS AND FIGURES ARE APPROXIMATE.

Disclaimer: Please note this floor plan is for marketing purposes and is to be used as a guide only. All dimensions are estimates only and may not be exact measurements.