



**SOLD**

## ANOTHER SOLD BY GEOFF TUTT

You can't go past this stunning residence built by Mark Wust offering spacious luxurious living and located in a quiet cul-de-sac on an 815 sqm block. Just a short distance to the Esplanade on the Pumicestone passage, this is the ideal location for families or those wanting lots of space to entertain family and friends.

The home comprises four living areas with open plan kitchen/dining/living, family room, rumpus room with slow combustion fire, media room, large office suite and four spacious bedrooms. The king-size master suite features a walk-in robe and en-suite with spa bath. The other three bedrooms are spacious with built-in wardrobes. Outside you will find multiple undercover living areas and Bali hut, a great place to relax and entertain. Look at these additional features:

- Reverse-cycle air-conditioning to all rooms & ceiling fans
- Large office with its own outside access (home business potential)
- 6KW Solar PV array and Fronius inverter
- Double lock up garage with storage space and rear roller door access
- Caravan/Boat hardstand
- Wide refrigerator space with plumbing
- Lots of storage space

This is the perfect home in the perfect location and will not last long on the market. Call Geoff on 0414 230 130 today.

**4 BED | 2 BATH | 2 CAR**

**PRICE:**  
**\$825,000**

**OPEN FOR INSPECTION:**  
**N/A**



**Geoff and Rose Tutt**  
**0414230130**  
geoff@atrealty.com.au  
[www.atrealty.com.au](http://www.atrealty.com.au)

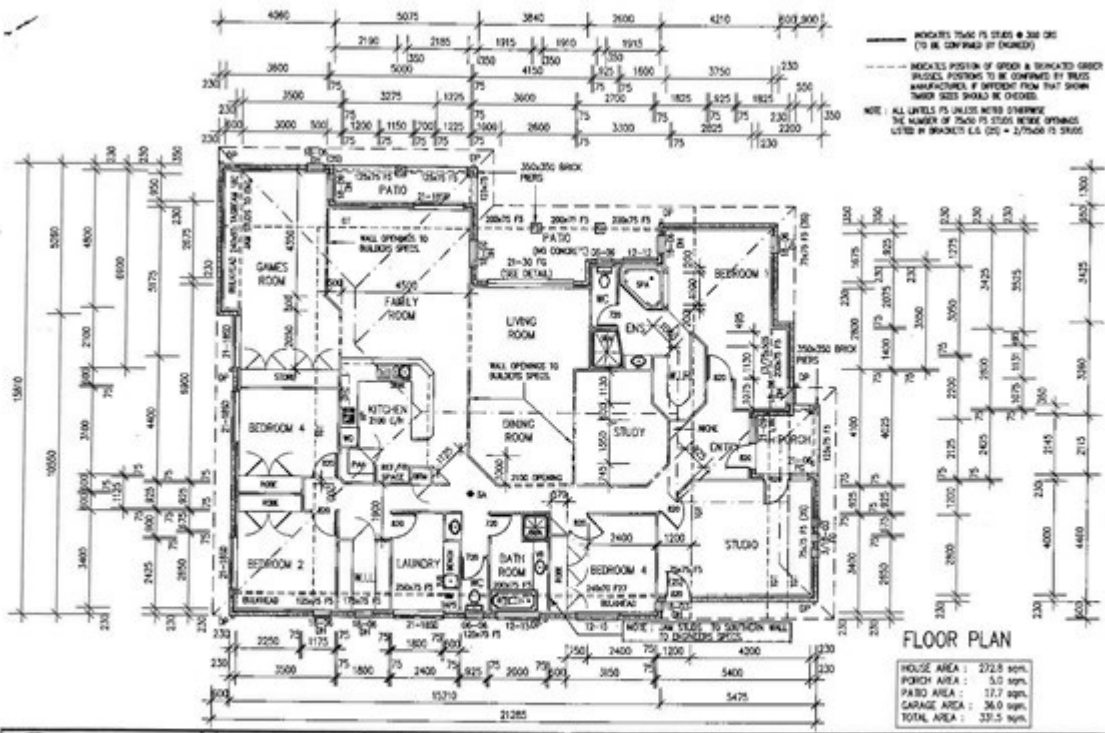

<p>300, TONGUE ROAD, LAWINTON, QLD, 4501        PH 0755 74 9627 FX 0755 288 842 FAX 0755 288 846</p>	<p>NO. REVISIONS</p>	<p>CONTRACTOR</p>	<p>R.A. &amp; L.J. DARLINGTON        PROPOSED DWELLING        LOT 44 TEAL BOULEVARD        BANKSIA BEACH</p>	<p>SCALE</p> <p>1:100</p>	<p>PROJECT NO.</p> <p>02189-1</p>	<p>DATE</p> <p>08/7/02</p>	<p>DATE</p> <p>N3 AUG '02</p>	<p>COPYRIGHT ©</p> <p>ALL RIGHTS RESERVED TO        COMISKEY DESIGN &amp; DRAFTING        IN ALL COUNTRIES        NO PART OF THIS DOCUMENT        MAY BE REPRODUCED OR        TRANSMITTED IN ANY FORM        WITHOUT PERMISSION</p>	<p>REGISTERED ARCHITECT</p>
	<p>DATE</p> <p>08/7/02</p>								

Disclaimer: Please note this floor plan is for marketing purposes and is to be used as a guide only. All dimensions are estimates only and may not be exact measurements.