



**SOLD**

## SOLD BY KRIS SUTCLIFFE & AMANDA ROBERTS

The Kris Sutcliffe & Amanda Roberts Team are proud present 36 Country Court to the market for sale.

A clever fusion of luxury features and family flexibility highlight the stunning design of this outstanding acreage home. Set on a gorgeous 3051sqm block within the exclusive Kings Country Park Estate, this home is sure to impress the most discerning buyer.

Built by Superior Homes, this amazing 363sqm home has an abundance of desirable features including:

- 5 large bedrooms with built in robes + study / home office
- Enormous master suite with walk in robe and luxurious ensuite bathroom
- Multiple living areas including a media room (wired for 7.2 speaker surround sound), kids lounge plus a large open plan living and dining
- Ultra-modern kitchen with ceasar stone benches, glass splash backs, one touch to open joinery, quality cooking appliances, dishwasher and walk in pantry
- Main bathroom with a large shower, full size bath and separate toilet
- Huge laundry with built in cabinetry and easy clothesline access
- Ceiling fans + zone ducted air-conditioning throughout
- Ducted vacuum, TV, phone and data points throughout
- Porcelain tiles with marble features + high quality carpet and underlay
- Quality block out roller blinds
- Low power LED downlights fitted throughout
- 8.5ft ceiling height with insulation and sarking in the ceiling and walls
- Large solar hot water system as well as 6kw solar power
- 2 x 5,000ltr water tanks (one of which is plumbed into the house for toilets and laundry)

But the features don't stop there!

You, your family, and your friends will love the fire pit setting, "kids fortress" cubby house and impressive outdoor kitchen. Measuring 12m x 8.5m in size, the kitchen is complete with a built-in gas BBQ, bench and cupboard space, range hood, 2 x fridges, lighting and even ceiling fans!

Last but by no means least; a brand new cement driveway spans the side boundary providing

**5 BED | 2 BATH | 6 CAR**

**PRICE:**  
**\$876,000**

**OPEN FOR INSPECTION:**  
**N/A**



**Kris Sutcliffe**  
**0437338665**

[kris.sutcliffe@atrealty.com.au](mailto:kris.sutcliffe@atrealty.com.au)  
[www.atrealty.com.au](http://www.atrealty.com.au)

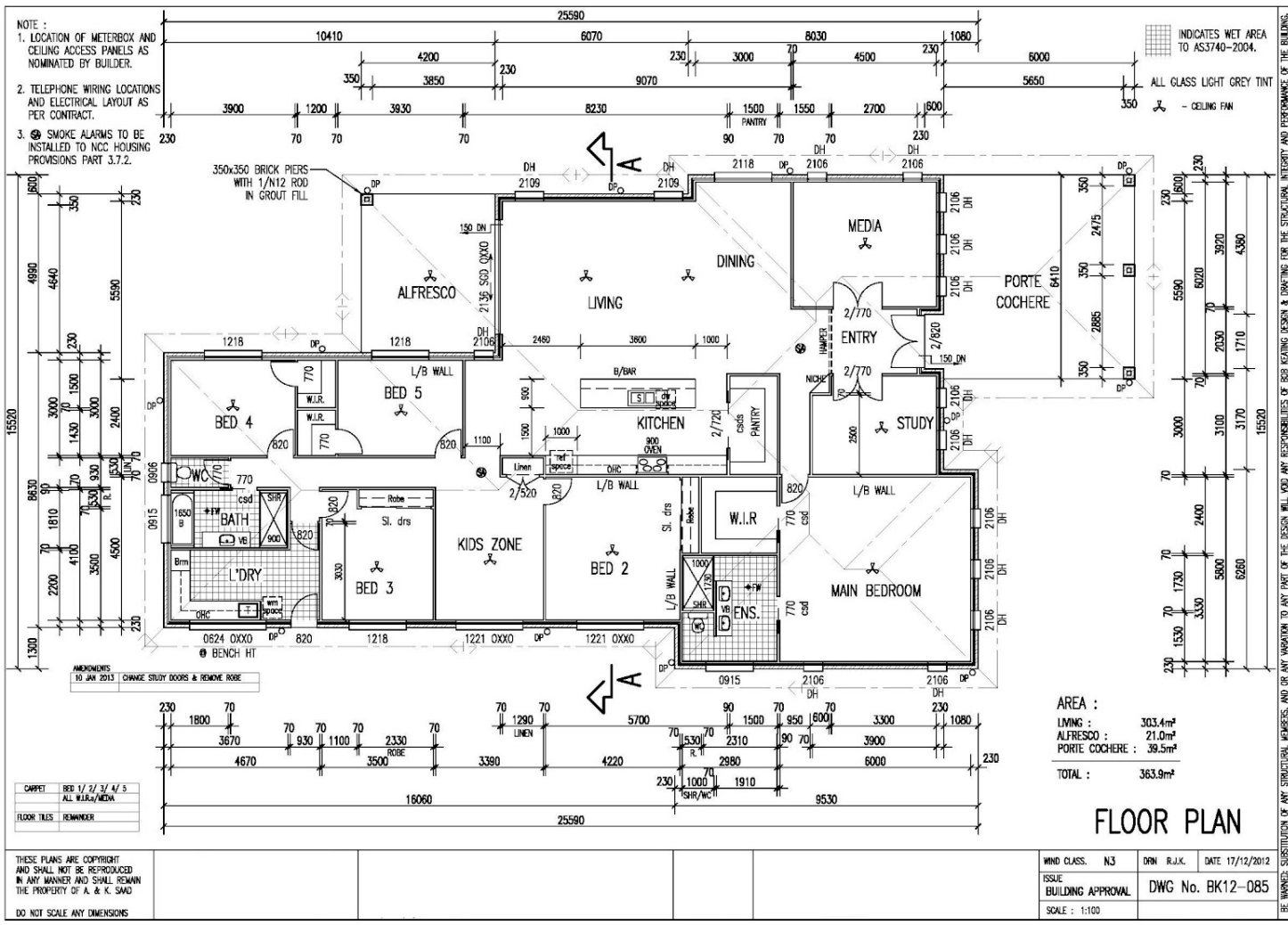

Disclaimer: Please note this floor plan is for marketing purposes and is to be used as a guide only. All dimensions are estimates only and may not be exact measurements.