



**SOLD**

## AN ENTICING FAMILY PACKAGE

Located in the highly desirable Clydevale Estate, this well thought out two year old home, has been custom designed for family living and lovingly maintained to excellent standards. Conveniently zoned areas accommodate the whole family with separate living at the front of the home which leads through to the centrally located stunning kitchen, any home chef would envy. Featuring beautiful extra wide stone benchtops and gleaming white cabinetry with so much storage including walk in pantry. Adjacent to the kitchen is a generous family/dining room and study nook. Other attractions for this home are the four oversized bedrooms all with plenty of storage and master with full ensuite, as expected. Other inclusions that enhance this home are zoned refrigerated air-conditioning, ducted heating, internal access to the large garage all situated on a low maintenance parcel of land close to Ramleigh Family and Community Centre the newly opened Ramleigh Park Primary school and many other educational options available within the area. Public transport is available close by as well as local shopping centres, Selandra Rise and Eden Rise, many parks to enjoy with easy access to major arterials.

This home is sure to impress so be quick to inspect, call today.

**4 BED | 2 BATH | 2 CAR**

**PRICE:**  
**\$671,000**

**OPEN FOR INSPECTION:**  
**N/A**



**Vincent Haupt**  
**0409704667**  
vin@atrealty.com.au  
[www.atrealty.com.au](http://www.atrealty.com.au)

# 20 Great Banjo Street CLYDE NORTH

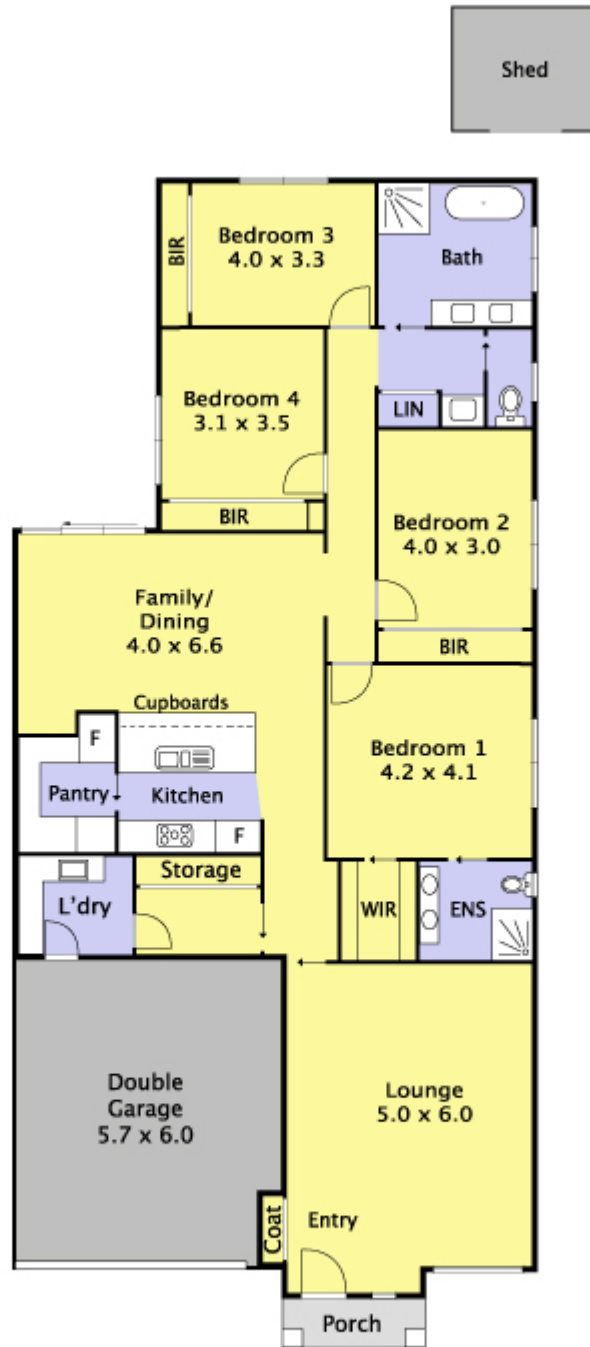

\*While every precaution has been taken to verify this information, it does not constitute any representation by the agent or vendor\*.

Disclaimer: Please note this floor plan is for marketing purposes and is to be used as a guide only. All dimensions are estimates only and may not be exact measurements.