



SOLD

MASSIVE 425M2 HOME ALL SET ON A RARE 1/3RD OF AN ACRE BLOCK + HUGE 84M2 SHED WITH WORKSHOP FROM HOME POTENTIAL!

Impeccably positioned in the exclusive and highly sort after Greenwoods Estate, I proudly present to you this surprising & well rounded family gem that ticks every box!

Perfectly set at the end of quiet Cul de Sac and ensconced in tranquil surrounds is this rare as hens teeth opportunity boasting a sprawling 425m2 of living space set on a huge 1/3rd of an acre allotment all ready for you and your family to start your exciting next chapter!

The home has been meticulously designed, boasting multiple living areas, 5 bedrooms, an expansive master suite including a handy study area and finished with a huge 64m2 alfresco dining space, all making this a home providing enviable size and separation ready to accommodate even the largest of modern day families!

Offering a fantastic 84m2 shed with 3 phase power, gated access and finished with its own bitumen driveway, this property certainly represents an opportunity not to be missed, so be quick and don't delay and ring for inspection times & bookings today!

Features include;

- * Ultimate new family lifestyle opportunity that is as rare as hen's teeth to come across
- * Hard to find and highly sort after 1/3rd of an acre relatively flat block allotment
- * Heaps of room for the kids to get out of the house and off the electronics to run amok & really be kids!!

- * Positioned in the exclusive & intimate Greenwoods Estate – surrounded by a selection of further contemporary & high quality homes
- * Whisper quiet end of Cul de Sac position
- * Only 30mins from the Brisbane CBD

- * Situated in an ultra convenient location only 2mins to the Cashmere Village Shopping Complex – providing IGA shopping, a chemist, a vet, a dentist, a bakery, a fitness center & a selection of

5 BED | 2 BATH | 5 CAR

PRICE:
\$1,227,000

OPEN FOR INSPECTION:
N/A



Patrick D'Arrigo
0447381869
pdarrigo@atrealty.com.au
www.atrealty.com.au



SHED NOT SHOWN IN ACTUAL LOCATION

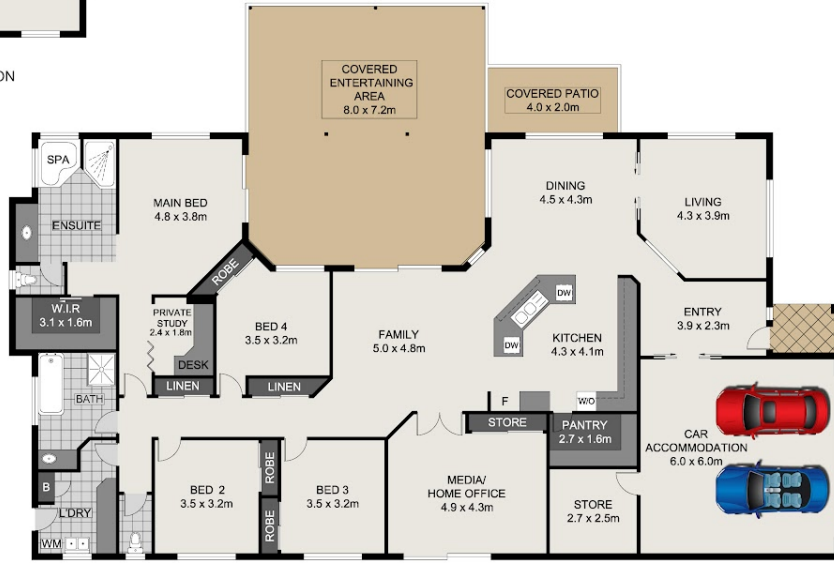

INT : 235.88m²
 EXT : 69.22m²
 SHED/CAR ACCOM. : 120.00m²
 TOTAL : 425.10m²

Scale in metres, indicative only. Dimensions are approximate. All information contained herein is gathered from sources we believe to be reliable. However, we cannot guarantee its accuracy and interested persons should rely on their own enquiries.

17 Grandis Court, Cashmere

Disclaimer: Please note this floor plan is for marketing purposes and is to be used as a guide only. All dimensions are estimates only and may not be exact measurements.