



**SOLD**

## YOUR DREAM AWAITS...!

Set on a very private 2.5 acres this stunning property is very well positioned on the foothills to the National Park. The most idyllic and relaxed lifestyle opportunity...

Pulling up in the driveway... is just breathtaking.

This gorgeous home is very solidly built, with high ceilings and a steel frame construction it's sure to impress. Absolutely stunning bush views from all windows.

Looking out from the beautiful kitchen and dining space, the expansive bush scape is magnificent to say the least.

Entertaining in style, enjoy being surrounded by views some only ever get to dream of.

Set the scene... we are only a very short 15 minute drive to many award winning restaurants and cafes on the shores of Jervis Bay and Sussex Inlet river, enjoy an refreshing cocktail whilst you take in the fresh ocean air. If it is shopping you love beautiful boutiques are also close by. If bush is your thing, a plethora of options await you for magnificent walks in nature and adventures in the National Park

Surfing at Berrara beach, enjoying a relaxing dip at the famous Hyams Beach or a swim in a private secluded crystal clear cove... from the position of this property your options are limitless.

This homestead also comes complete with many living options. There is an oversized 'American style' barn, with full bathroom, studio/workshops and plenty of space for all the toys.

Indulge in your own fresh produce from the nashi pear tree, peach trees, fig tree, lemon tree and mandarin tree.

Picturesque dam on the property and with totally private surrounds this home has everything you could ever dream of.

Feel rejuvenated, breathe and know you are home.

**5 BED | 3 BATH | 5 CAR**

**PRICE:**  
\$1,451,043

**OPEN FOR INSPECTION:**  
N/A



**Jessica Bruns**  
**0430117048**  
pearlpropertyagents@atrealty.com.au  
[www.atrealty.com.au](http://www.atrealty.com.au)

# 43 A Hayward Road, Wandandian

**PEARL PROPERTY AGENTS** 

Please note:  
Floorplan measurements are a guide only.  
All dimensions are approximate in their distance and volume.  
Floorplan is an indication of layout only.

 www.digital1.com.au

Jessica Bruns - LREA  
0430 117 048  
pearlpropertyagents@atrealty.com.au

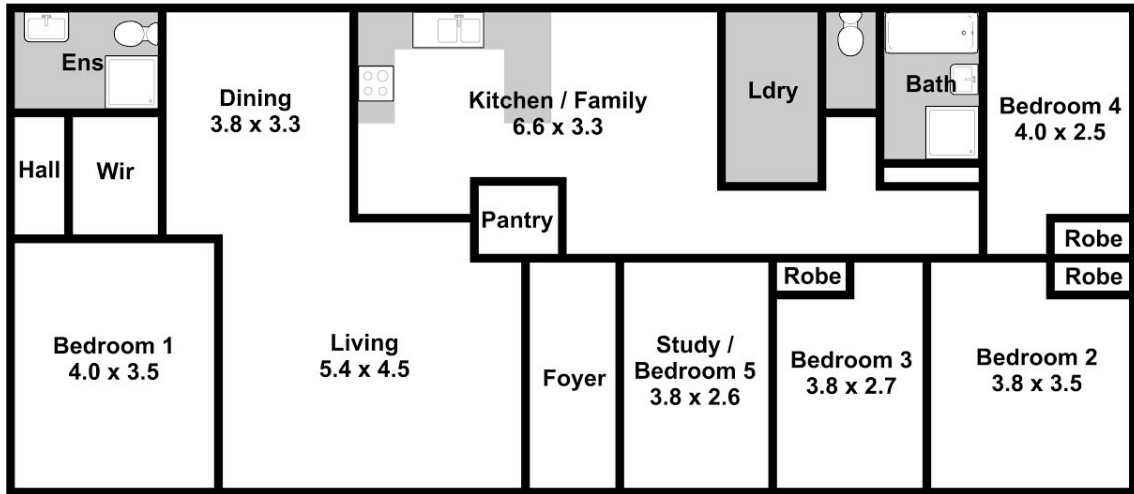

-  5
-  3
-  4

Disclaimer: Please note this floor plan is for marketing purposes and is to be used as a guide only. All dimensions are estimates only and may not be exact measurements.

Jessica Bruns  
0430117048  
pearlpropertyagents@atrealty.com.au  
[www.atrealty.com.au](http://www.atrealty.com.au)

