

SOLD

160M2 GROUND FLOOR APARTMENT PLUS DOUBLE LOCK UP GARAGE

Huge 160m2 Apartment, positioned on the ground floor within walking distance to Coolangatta Cafes, Restaurants and Beaches.

Features:

- This apartment offers 160m2, with a generous living and dining areas.
- Functional kitchen with electrical appliances.
- Private Master suite with ensuite and walk in robe opening to the terrace.
- 2 other bedrooms, both good size with built-in wardrobes.
- Main bathroom with separate toilet.
- Two entry points to the apartment.
- Covered terrace area, leading to the resort style pool.
- Double remote controlled lock up garage.

Park Place Apartment Complex:

- Building of 21 Apartments.
- Built in 1991.
- Secure intercom system to the building.
- 2023m2 of land.
- Underground secure car parking.
- Resort style pool.
- Rear access to Goodwin park and easy level walk to Coolangatta shops and beaches.

Location:

Approx. 500m to Coolangatta CBD.
Close to shops, schools and clubs.
Within minutes to Gold Coast Airport.

Body Corp Fees: \$106.50pw \$5,538.00pa

Land Rates: \$1,851.18pa

Water Rates and Usage: \$1,606.04pa

3 BED | 2 BATH | 2 CAR

PRICE:
\$780,000

OPEN FOR INSPECTION:
N/A



Michelle Topper
0400362639

michelle.topper@atrealty.com.au

www.atrealty.com.au

4/54 Dutton Street, Coolangatta

3 2 2

internal: 140 m² | external: 20 m² | garage: 28 m² | total: 188 m²

MICHELLE TOPPER
REAL ESTATE
0400 362 639

@realty

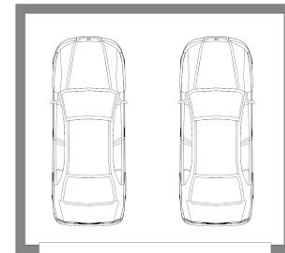
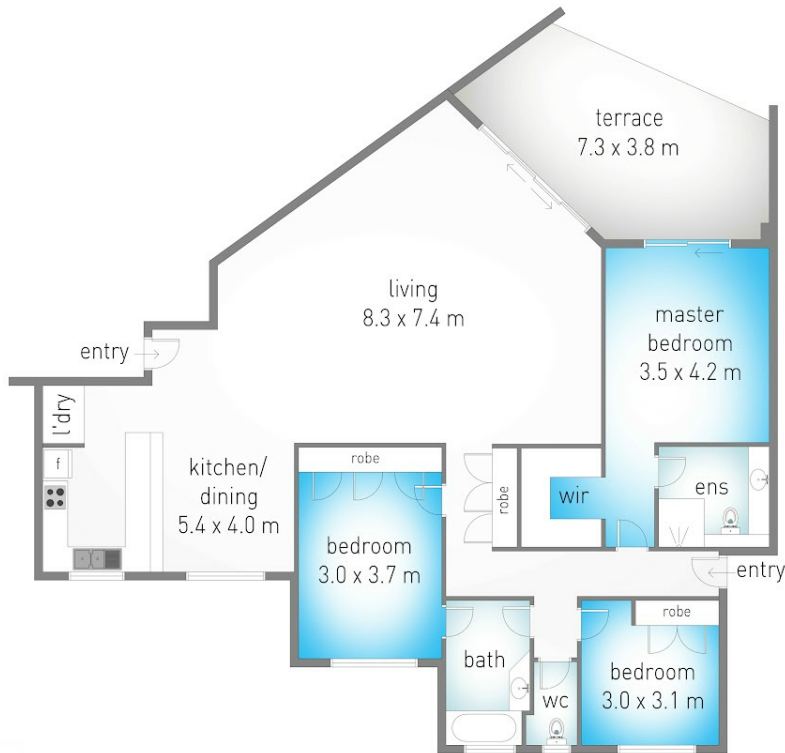

garage
5.6 x 5.0 m



Dimensions are approximate. All information contained herein is gathered from sources we believe to be reliable. However we cannot guarantee its accuracy and interested persons should rely on their own enquiries.

Disclaimer: Please note this floor plan is for marketing purposes and is to be used as a guide only. All dimensions are estimates only and may not be exact measurements.

Michelle Topper
0400362639
michelle.topper@atrealty.com.au
www.atrealty.com.au

@realty