



**SOLD**

## GRAND MASTERPIECE IN AWARD WINNING GOLF ESTATE

A rare and brilliant beauty awaits you.

This magnificent showpiece has been architecturally designed, masterfully built and with sensational modern living in mind...

Welcome home, when you arrive, you are greeted by the calming sounds of water and nature. This home really is a blissful paradise and a true modern masterpiece!

The home theatre is taken to a new level here, a true cinematic experience blissfully evokes a relaxation mindset. Encompassing state of the art equipment. This home theatre has it all.

STUNNING GOLF COURSE ESTATE ALSO COMPRISES OF YOUR VERY OWN ACCESS TO THE LARGE MAGNIFICENT POOL, LUXURIOUS TREE LINED GROUNDS OF THE GOLF COURSE AND THE ESTATE TENNIS COURT.

All of these amazing features come as a brilliant bonus of purchasing this masterpiece home.

Another one of the amazing attributes of this home is the state of the art security system along with the Estate itself having advanced security features, making this property the ultimate in secure family living, privacy and safety.

Set in the most perfect position, not to mention the view over the course!

Relax and enjoy a drink looking over the 16th green from the best vantage point, your own balcony

So, if you fancy a round of golf, unwinding by the fire, or enjoying pizzas from your very own outdoor kitchen - magnificent alfresco options await you

Contact Jessica Bruns of Pearl Property Agents directly on 0430117048 for a viewing

**6 BED | 4 BATH | 12 CAR**

**PRICE:**  
\$3,565,000

**OPEN FOR INSPECTION:**  
N/A



**Jessica Bruns**  
**0430117048**

pearlpropertyagents@atrealty.com.au  
[www.atrealty.com.au](http://www.atrealty.com.au)

# 27 Twin Creeks Drive, Luddenham



Please note:  
Floorplan measurements are a guide only.  
All dimensions are approximate in their distance and volume.

www.digital1.com.au

Jessica Bruns - LREA  
0430 117 048  
pearlpropertyagents@atrealty.com.au

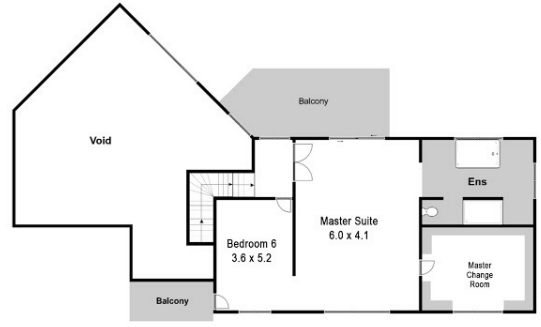
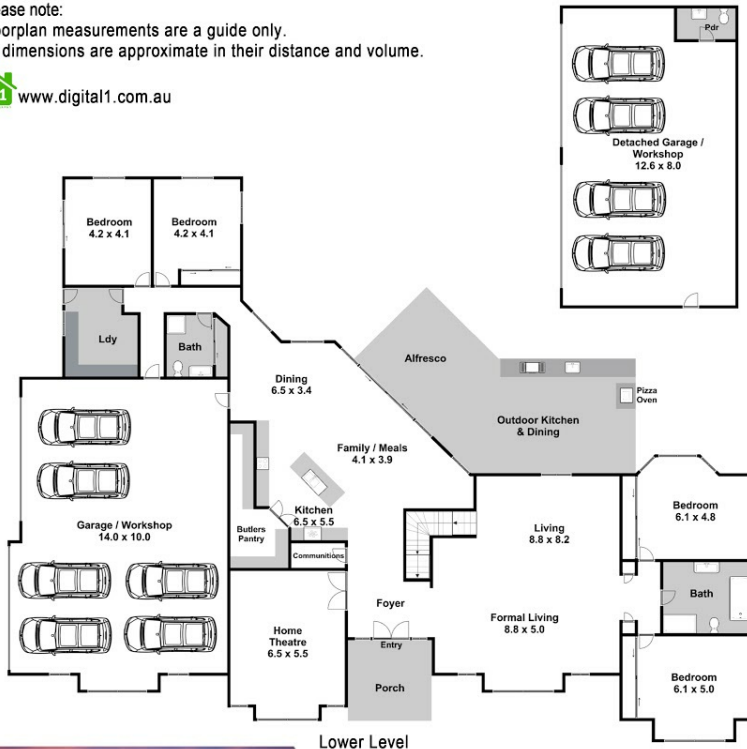

Lower Level

Upper Level



- 6
- 3.5
- 12

Disclaimer: Please note this floor plan is for marketing purposes and is to be used as a guide only. All dimensions are estimates only and may not be exact measurements.

Jessica Bruns  
0430117048  
pearlpropertyagents@atrealty.com.au  
www.atrealty.com.au

