



SOLD

POSITION, CHARM AND QUALITY

Showcasing a perfect blend of traditional features and modern design, this quality-built, family residence is full of character and charm. The solid, brick and tile home has exceptional street appeal, from the sandstone façade and landscaped gardens to the bullnosed verandah and stained-glass entry.

The split-level floorplan is ideal for a large family with a multitude of spacious living areas, presenting plenty of options to relax and entertain. The large formal lounge and dining area features a traditional fireplace and beautiful, warm timber flooring. The open plan kitchen, family living area and rumpus/media room, open to the covered pergola overlooking the sparkling swimming pool; perfect for entertaining!

Accommodation includes a private, generous master bedroom with ensuite and walk-in-robe, plus three double sized bedrooms with built-in robes, all serviced by a family bathroom and separate toilet.

This fantastic property is situated in one of Brisbane's most prestigious and popular neighbourhoods at the heart of Brookfield's family-friendly community. The area is known best for its country-atmosphere with city conveniences, only 15km drive to the Brisbane CBD.

Within a 4 minute drive is everything Brookfield has to offer including the historic showgrounds and hall where the local residents come together to enjoy pony club, the annual show, farmers' markets and regular social events.

Nature enthusiasts can appreciate and enjoy the acres of surrounding parklands and acreage properties and the nearby Mt Coot-tha walking and cycling tracks.

Also within close proximity are some of Brisbane's finest schools including Brookfield State School which is only a 3 minute drive, Our Lady of the Rosary Catholic Primary School which is a 6 minute drive, and renowned Kenmore State High School which is only a 6 minute drive or a 30 minute walk for the active teen.

4 BED | 2 BATH | 2 CAR

PRICE:
\$1,192,000

OPEN FOR INSPECTION:
N/A



Jill O'Grady
0414518026
jillogrady@atrealty.com.au
www.atrealty.com.au

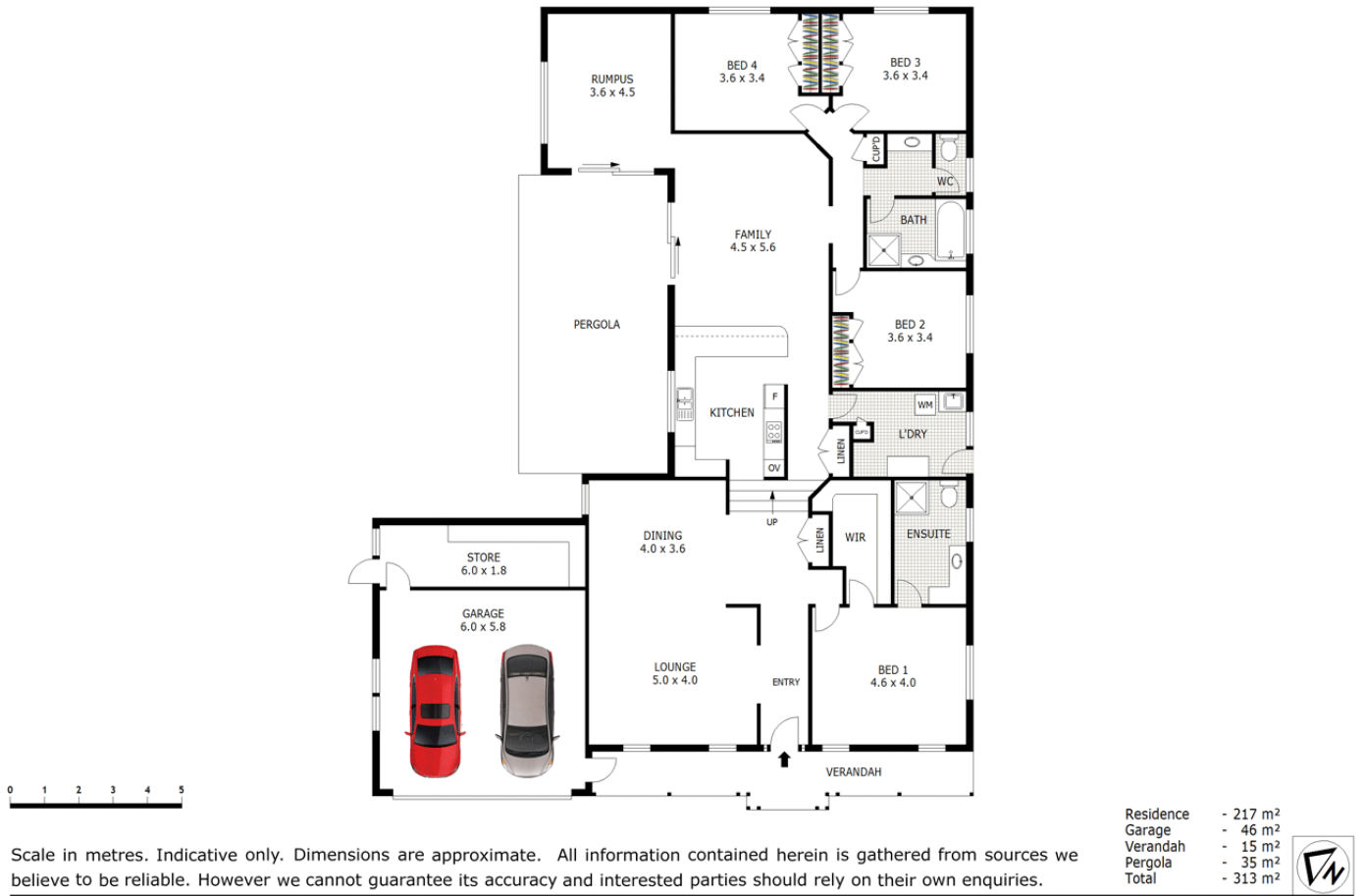

12 Drysdale Crescent, Brookfield

Disclaimer: Please note this floor plan is for marketing purposes and is to be used as a guide only. All dimensions are estimates only and may not be exact measurements.