



SOLD

FANTASTIC 6TH LEVEL APARTMENT WITH SWEEPING BROADWATER VIEWS

FANTASTIC 6TH FLOOR APARTMENT WITH SWEEPING BROADWATER VIEWS

6th level light filled, open plan apartment. Open plan living/dining area with floor-to-ceiling windows to large balcony

- * The kitchen - stainless steel appliances - gas cooktop, oven, range hood & dishwasher.
- * Good-sized master bedroom - extra-large triple robes, two-way bathroom, private study/occasional guest bedroom.
- * Audio Intercom System to each apartment
- * Ducted & zoned air-conditioning
- * Secure underground parking - 1 car space
- * Low body Corp fees - \$95pw
- Silvershore Features Include
 - * Spacious lobby
 - * 24-hour on-site managers
 - * 25m Heated lap pool
 - * Large heated spa
 - * 2 x Large undercover BBQ areas
 - * Private Gym & Sauna
 - * Residents Lounge
 - * Security access to all floor levels
 - 2 x Lifts in building
 - * Ample visitor car parking

1 BED | 1 BATH | 1 CAR

PRICE:
\$535,000

OPEN FOR INSPECTION:
N/A



Francine Setchell
0408143464
francine@atrealty.com.au
www.atrealty.com.au

FLOOR PLAN | LEVELS 1-8 | TYPE A BROADWATER



Type A7	Type A8	Type A9
Internal 65 m ²	Internal 65 m ²	Internal 65 m ²
Balcony 15 m ²	Balcony 15 m ²	Balcony 23 m ²
Total 80 m²	Total 80 m²	Total 88 m²

No of Bedrooms - 1 + Study
 No of Bathrooms - 1
 No of Car Parks - 1

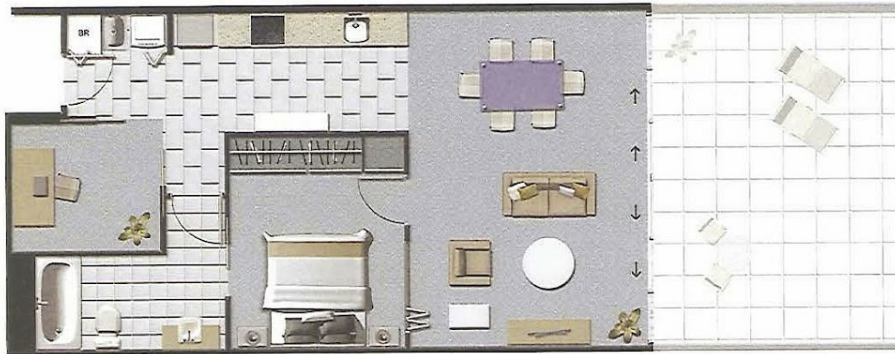

Note - Typical floor plan shown, balcony shapes & sizes vary.

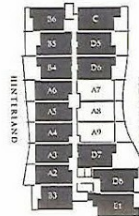

Balcony Shape Variations

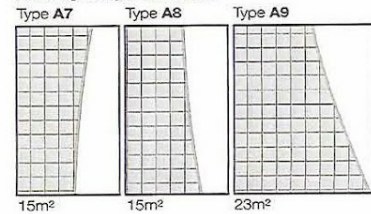

The particulars in this document are set out as a general outline only. This is representative as a guide only and does not constitute an offer or a contract. Intending purchasers are advised to carry out their own investigations of the correctness of each description or reference. All details were correct at the time of printing and are subject to change without notice.

Disclaimer: Please note this floor plan is for marketing purposes and is to be used as a guide only. All dimensions are estimates only and may not be exact measurements.