



SOLD

LARGE PARKSIDE, CORNER BLOCK

Build your dream home in this unparallel parkside block.

This elevated 449 m2 is truly a rare find. Centrally located in a quiet neighborhood of Eight Mile Plains, you can enjoy a peaceful lifestyle with the convenience of easy park access as well as the great transport options on offer.

Make your move in this booming market. Choice of land only or our desirable house&land package (double storey, 4 bedrooms+Rumpus+two living areas + double car garage + 2.5 bathrooms).

Highlights at a glance:

1. Large 449m2 land with a flexible building envelope. Both project and custom designs would suit the block.
2. Corner position with Parkview and easy park access.
3. Choice of driveway locations on both street frontages*.
4. ~5 mins drive to Market Square Sunnybank, Runcorn Plaza, M1, M2 & M3 gateway Motorways.
5. ~6 mins drive to Westfield Garden City.
6. ~15 mins drive to Brisbane CBD.
7. All services will be connected at settlement, ready to build.

*Subject to council approval.

0 BED | 0 BATH | 0 CAR

PRICE:
\$535,000

OPEN FOR INSPECTION:
N/A



Tony Xu
0421861668
tonyxu@atrealty.com.au
www.atrealty.com.au

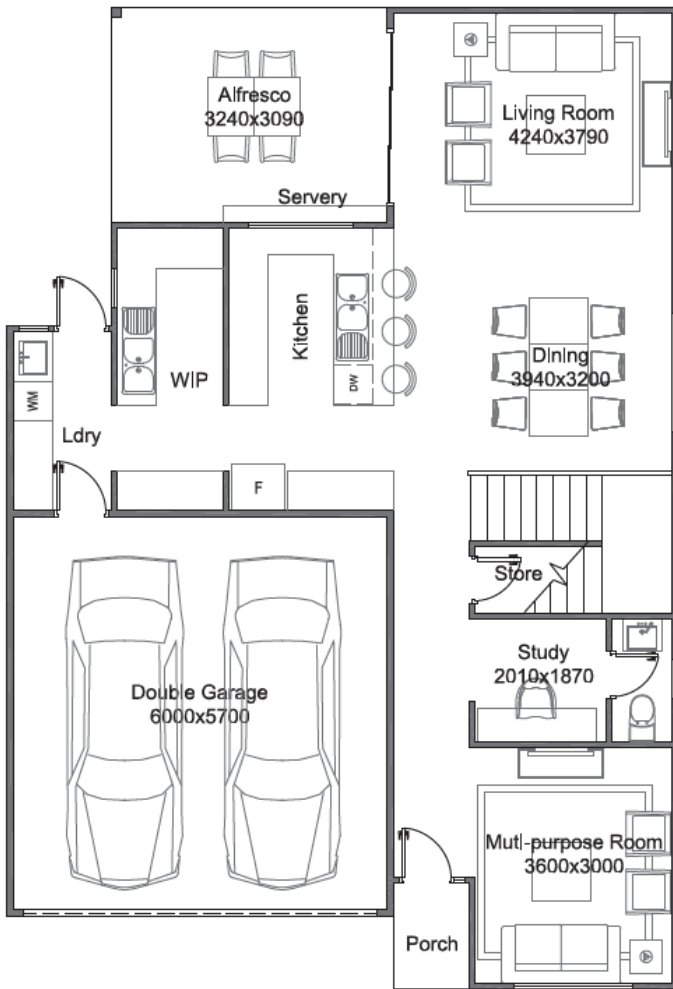

Ground Floor

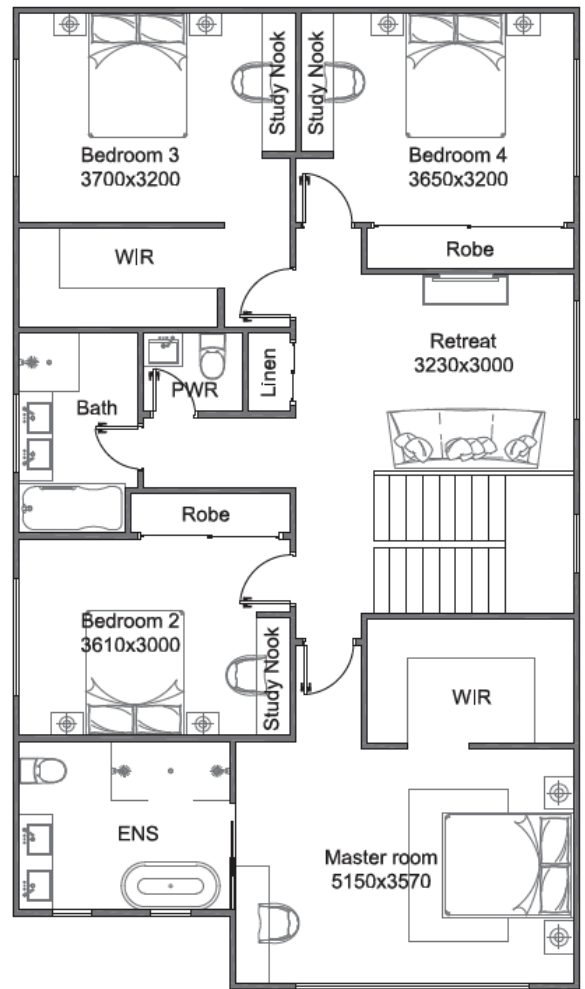

First Floor

Disclaimer: Please note this floor plan is for marketing purposes and is to be used as a guide only. All dimensions are estimates only and may not be exact measurements.