



SOLD

LIVE THE SEMI RURAL LIFESTYLE DREAM

This immaculate family home is located in Wilton Village, a family friendly & tightly held community surrounded by a relaxing semi rural atmosphere with sounds of nature echoing through streets adorned by the beautiful tree lined perimeter. The home is spread over an impressive floor plan on a huge block of land and is the perfect location to raise a family and make many memories with all it has to offer.

Features Include:

- Wrap around veranda
- Wide entry
- Four well proportioned bedrooms with built in robes to three
- Master suite is generously proportioned & includes and ensuite
- Expansive open plan lounge & dining room
- Built in combustion fireplace to lounge room
- Well appointed kitchen with ample cupboard & bench space
- Gas cooking
- Stainless steel dishwasher
- Island bench breakfast bar
- Conveniently situated bathroom includes bathtub
- Internal laundry with backyard access
- Linen closet
- Ducted air conditioning
- Downlights
- Undercover alfresco
- Stunning inground swimming pool includes timber decking & is semi undercover
- Fantastic sized backyard
- Double garage
- Side access
- 1,018sqm Block of land

This ideal home is located away from the hustle and bustle of city life but still within close proximity should you wish to venture out. Local schools, shops & parks are all close by and access to the Hume Motorway is only a short drive away. You are directly opposite Hannaford Oval, a convenient 25 minute drive from the beautiful beaches of Wollongong & in the opposite direction, a 25 minute drive where you are spoilt for choice for popular shopping destinations as

4 BED | 2 BATH | 2 CAR

PRICE:
\$950,000

OPEN FOR INSPECTION:
N/A



Bobby Reynolds
0432173566
bobby.reynolds@atrealty.com.au
agencycentralwilton.com.au

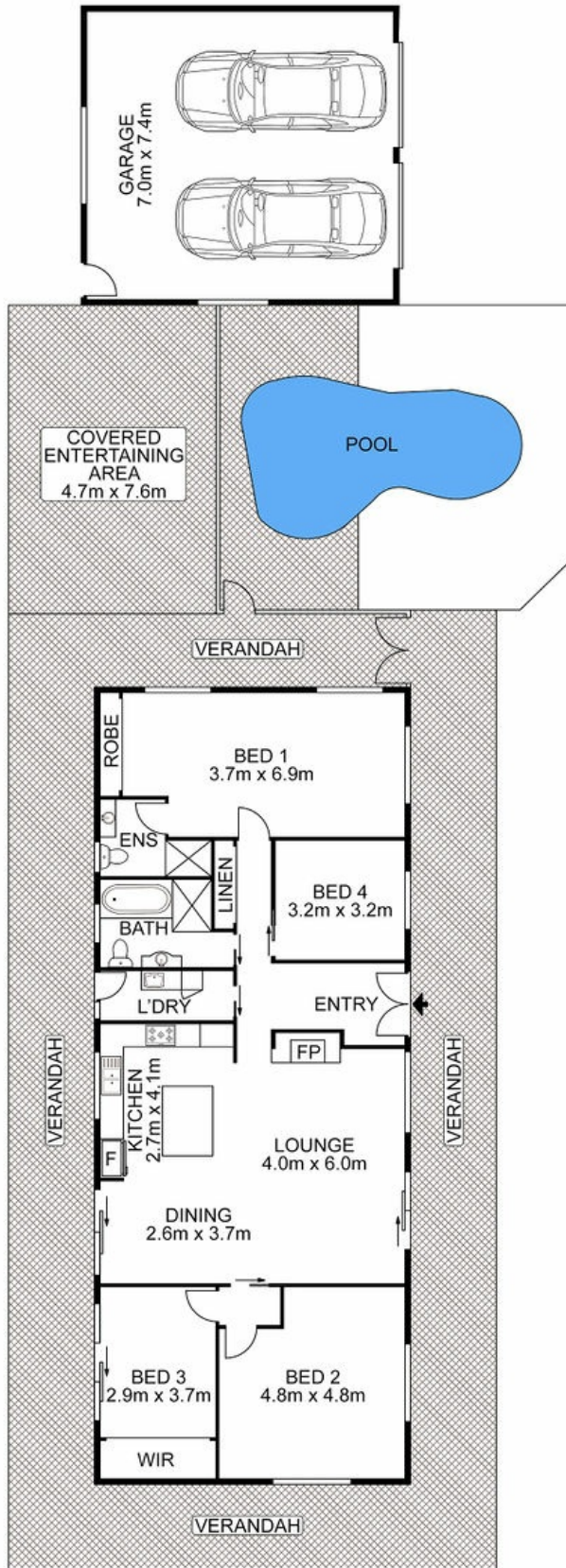

 AGENCY

Disclaimer: Please note this floor plan is for marketing purposes and is to be used as a guide only. All dimensions are estimates only and may not be exact measurements.

1125 Argyle Street, Wilton

Bobby Reynolds All measurements are approximate • Drawn for marketing purposes only
 0432173566
 bobby.reynolds@atrealty.com.au
 agencycentralwilton.com.au

