



SOLD

UPMARKET FIRST HOME OR HIGH END INVESTMENT!

This property is situated in upmarket newer area of Casino and has all services required. Home would suit forever home for first home owners starting out or high end investment property for the astute investor.

- * 4 spacious bedrooms Master with walk in robe and full ensuite.
- * kitchen is open, spacious and looks out over park land to rear of property.
- * polished timber floors to all living areas and carpet to bedrooms, all with high 2.7 ceilings.
- * large bathroom with bath situated in centre of home.
- * lounge, dining and kitchen form large open living area enjoyed by whole family.
- * large laundry with ironing area and 3rd separate toilet.
- * double garage with remote roller door and entrance to living area.
- * fully fenced rear yard with double gates access to park land at rear and good sized garden shed.

This home would suit most purchasers requiring a forever home or at moment has an excellent tenant on month to month happy to continue if purchased by investor. There is only a hand full of properties in this area that have this unique access and views to a great park area.

Call your Local Atrealty Agent today to organize your inspection.
David, 0400026181 or davidhenderson@atrealty.com.au.

Agent declares interest.

4 BED | 2 BATH | 2 CAR

PRICE:
\$530,000

OPEN FOR INSPECTION:
N/A



David Henderson
0400026181
davidhenderson@atrealty.com.au
www.atrealty.com.au

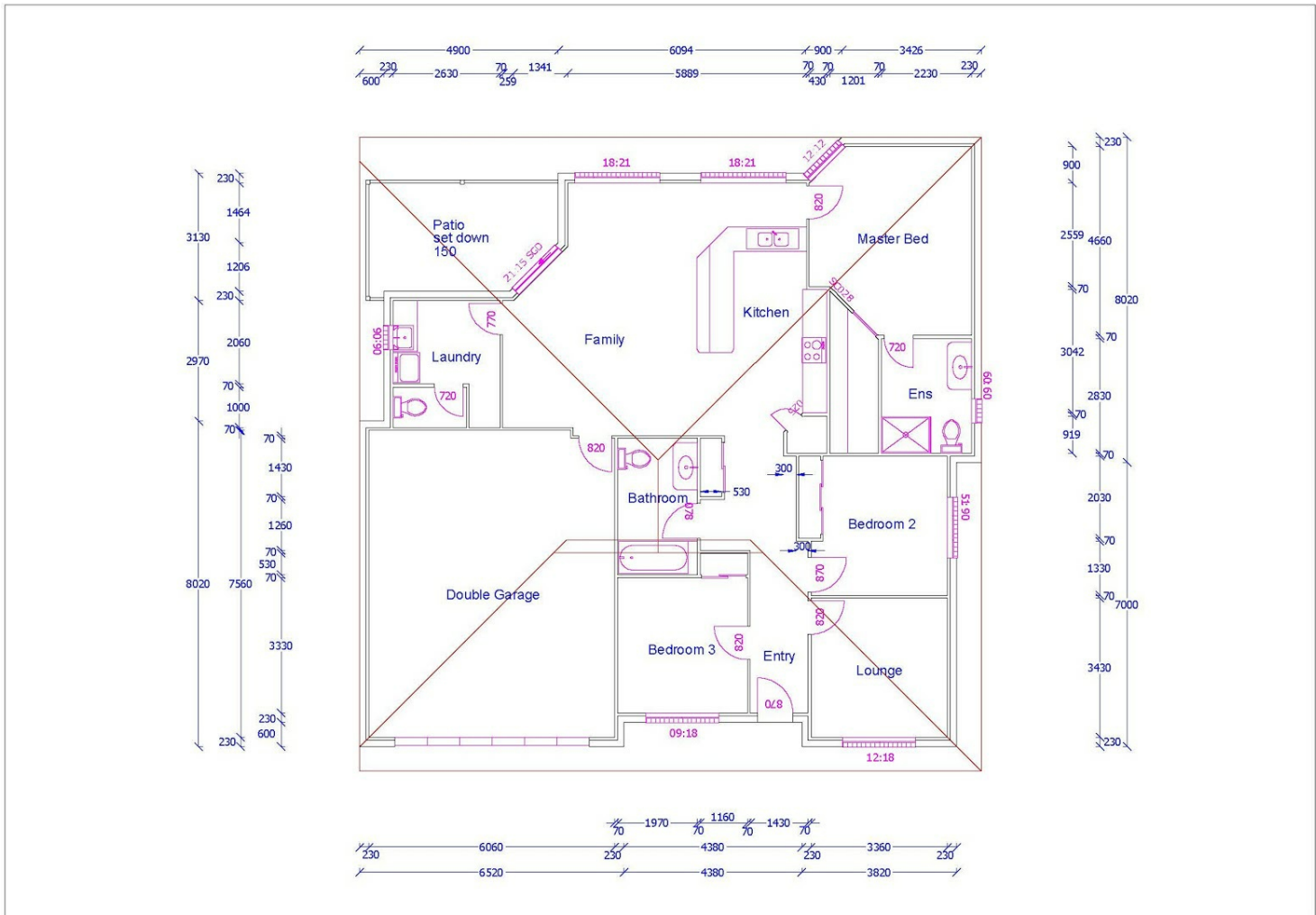

Disclaimer: Please note this floor plan is for marketing purposes and is to be used as a guide only. All dimensions are estimates only and may not be exact measurements.