



**SOLD**

## CEDAR POCKET CATTLE BREEDING PROPERTY

142.5 acres with rolling hills down to irrigated flats with improved pasture and 7 dams ( two of which are spring fed) across the property meaning water is not an issue. Making this an ideal breeding block with a carrying capacity of 60 breeders and progeny.

At the top of the hill there is a perfect second house site to give 360-degree views of the surrounding valleys and hills.

The home is spacious and in very good condition.

3 bedroom timber home with built-ins in all bedrooms and ceiling fans in 2 bedrooms, there is a single garage attached to the house as well as 3 bay besser block shed for more parking. There is also 3 kilowatts of solar on the carport. Two more sheds for tractors and implement and feed storage. The cattle yards are next to the sheds and have laneways leading from multiple paddocks into the yards allowing easy handling of the cattle. Water is gravity fed to the water tanks & troughs via a two inch line around the yards and sheds from the dams in the valley above.

Properties of this calibre in this area do not last long so don't hesitate or you may miss another one. Taking private inspection bookings now.

- 142.5 acres
- 3 Bedroom Home
- 4 Sheds
- 3 Kw of solar
- Cattle Yards
- 7 Dams ( 2 spring fed)
- Multiple paddocks
- Improved Pastures, Kikuyu, Rhodes, Blue grass, Setaria & Clover.
- Underground irrigation and some easy shifts to go with the property.
- 11 klms to Kin Kin
- 20 klms to Gympie
- 40 klms to Tewantin

Properties of this calibre in this area do not last long so don't hesitate or you may miss this one. We are taking private inspection bookings now.

**3 BED | 1 BATH | 11 CAR**

**PRICE:**  
\$970,000

**OPEN FOR INSPECTION:**  
N/A



**Wes Farnham**  
**0439388015**

wes@atrealty.com.au

[wesandkaylenefarnhamrealestate.com](http://wesandkaylenefarnhamrealestate.com)

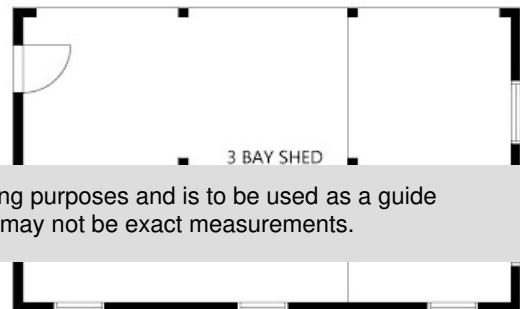
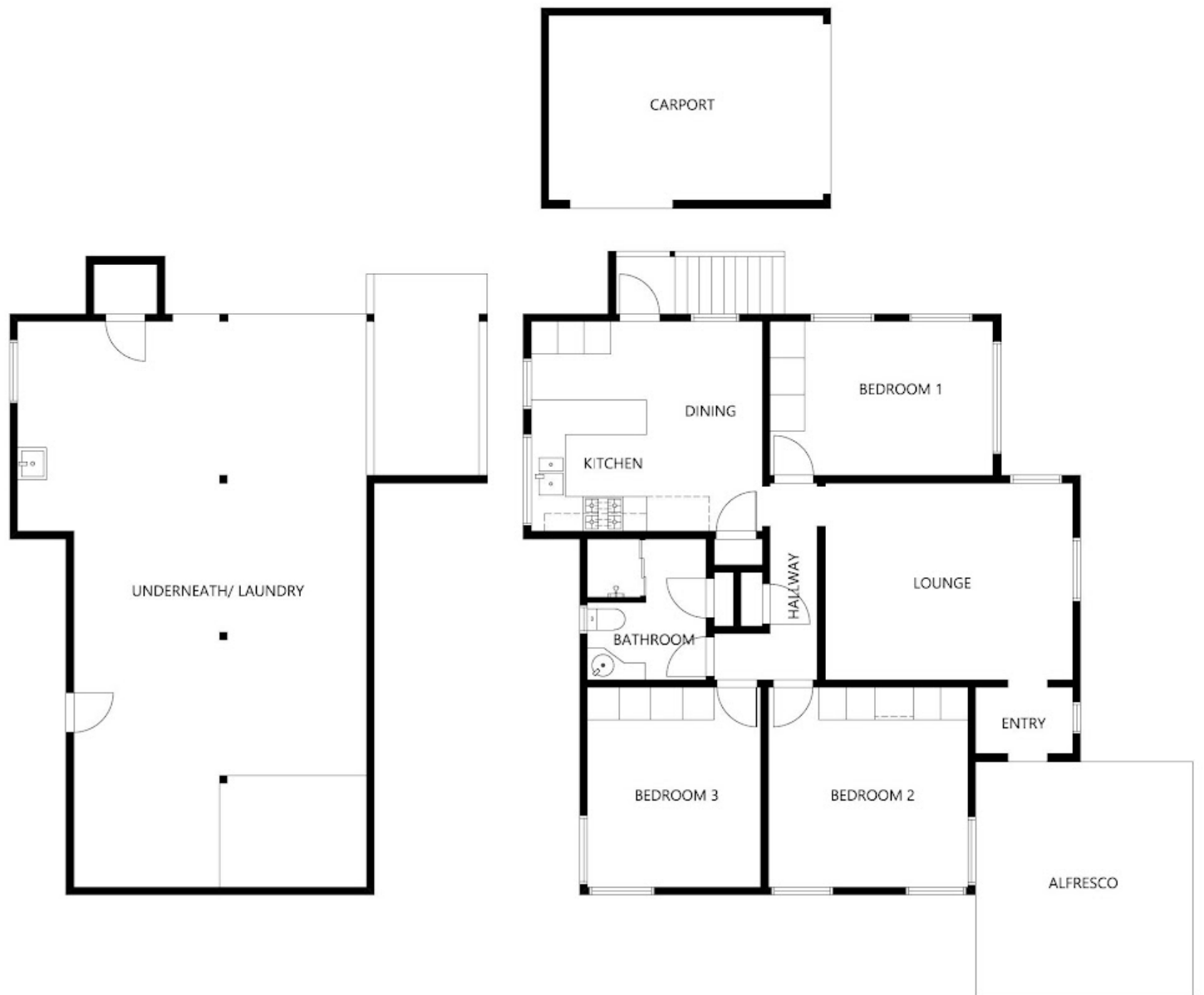

Disclaimer: Please note this floor plan is for marketing purposes and is to be used as a guide only. All dimensions are estimates only and may not be exact measurements.

GROUND FLOOR

FLOOR PLAN IS PROVIDED AS INDICATIVE LAYOUT ONLY. MEASUREMENTS ARE NOT AVAILABLE, FLOORPLAN IS NOT TO SCALE.  
NO GUARANTEES PROVIDED ON ACCURACY

GAP RD.