



# SOLD

## UNDER OFFER

Enjoy Broadwater living at its best in this 4th floor, contemporary apartment, with Hinterland views. Silvershore is situated opposite the sandy Broadwater foreshore.

This modern apartment is flooded with natural light. The sleek, white entertainer's galley kitchen has ample storage, mirrored splashbacks, stainless steel appliances and gas cook top. The light and bright open plan living/dining area has patio doors that stack back completely to give the indoor/outdoor feeling that the Gold Coast lifestyle is all about and lead straight out to the generous private balcony, so its ideal for entertaining. Just sit back, relax with a glass of champagne and enjoy your sunset views.

The Master bedroom looks over the living area to the Hinterland beyond and has built in wardrobes, shutters and a 2-way en-suite bathroom. The study/multi purpose room/2nd bedroom has obscured sliding doors so can easily be used as a bedroom for your occasional guest.

Silvershore is positioned on Marine Parade with direct access to the Broadwater, walkways and parks and is only a stroll to restaurants and cafes, amenities and shops, Easy access to Griffith University, Gold Coast University Hospital, and Runaway Bay Shopping Centre and Harbour Town for outlet shopping.

Ideal apartment would suit the discerning owner-occupier, holiday get away/weekender or investment property

Apartment Features Include:-

- Spacious open plan living
- Modern gourmet kitchen
- Generous Master bedroom with triple mirrored wardrobes
- 2 way, walk through en-suite bathroom
- Bedroom 2/Study/Multi purpose room with sliding doors
- European laundry
- Ducted air-conditioning
- 1 very convenient underground parking space
- Low Body Corporate approx. \$95 per week

Silvershore Apartment Facilities Include:

1 BED | 1 BATH | 1 CAR

PRICE:  
\$350,000

OPEN FOR INSPECTION:  
N/A



**Francine Setchell**  
0408143464  
francine@atrealty.com.au  
[www.atrealty.com.au](http://www.atrealty.com.au)

Hinterland Views

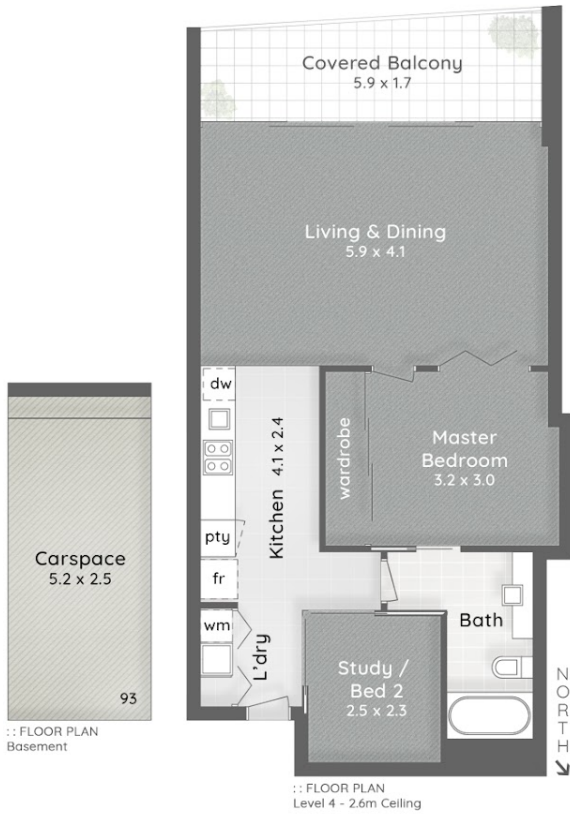

:: FLOOR PLAN Basement

:: FLOOR PLAN Level 4 - 2.6m Ceiling

POINTS OF INTEREST

1. SILVERSHORE
2. Harbour Town Outlet Shopping
3. Metro Market | 4. Quota Park
5. Harbourside Market
6. Biggera Waters Creek
7. Labrador Park Shopping Centre

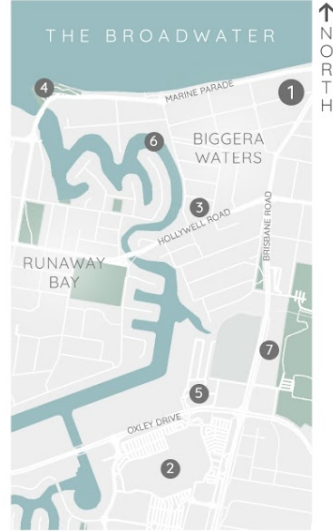

:: LOCATION MAP



Francine Setchell  
0408 143 464

SILVERSHORE

404/430 Marine Parade

BIGGERA WATERS

2 Bed

1 Bath

1 Car

Internal 66m<sup>2</sup>

Balcony 11m<sup>2</sup>

Total 77m<sup>2</sup> or 8 Squares

Carspace 14m<sup>2</sup>

puredesign plans for  
CONCEPTS purpose

No permission is given to use or alter this Floor Plan without the consent of Pure Design Concepts. The overall presentation style, layout, imagery, fonts, background, colours and terminology has been originally created by PDC and is subject to strict copyright. No ownership is taken for building design. All measurements are approximate & individuals should rely on their own information. Find out more at [puredesignconcepts.com.au](http://puredesignconcepts.com.au)

Disclaimer: Please note this floor plan is for marketing purposes and is to be used as a guide only. All dimensions are estimates only and may not be exact measurements.

Francine Setchell  
0408143464  
francine@atrealty.com.au  
[www.atrealty.com.au](http://www.atrealty.com.au)

