



SOLD

NEAR NEW, NOTHING TO DO !

BOOK YOUR PRIVATE INSPECTION NOW!!

Approx 7Mths young and 32sq on a single level.

Upon entry the quality and luxury of this stunning home is immediately evident by the high ceilings and beautiful oak timber flooring throughout. The master suite is a true parent's haven with large walk-in wardrobe and palatial open ensuite, with separate toilet. Featuring stunning decorative tiling, double vanity with stone bench tops a huge spa bath with oversized shower and is privately zoned at the front of the home.

Walking through the home you arrive at the formal lounge room where the filtered light streams through the plantation shutters making this room one you will enjoy spending time in. A separate study compliments the quiet end of the home.

The piece de resistance is the custom kitchen featuring 40mm black stone benchtops with white cabinetry and top quality Fisher and Paykal oven and range hood. The classic and very classy monochrome décor is highlighted by strip lighting and over bench pendant lights adding ambience to this enviable space. Not to mention the convenience of a butler's pantry where the quality is carried through.

A spacious and bright family living and dining area is adjacent to the open plan kitchen which provides a central hub for the family to come together.

A further three bedrooms and family bathroom with a separate third living area at the rear of the home to accommodate kids or teens is available to be utilised as your family needs.

Sliding doors lead out to the extensive merbau, covered outdoor entertaining area that can be used all year round. Just a few extras are mentioned here such as ducted refrigerated cooling and heating, internal access to the double garage and fully landscaped front and rear gardens.

This home is located walking distance to the newly constructed Eliston Community Centre opening soon as well as the Clyde Primary School due to open in 2022. Clyde Shops only 5 minutes' drive and Cranbourne train line extension scheduled to commence in the not too distance future, it is easy to see why the Hartleigh Estate is quickly becoming one of the most sort after estates in the rapidly growing outer south eastern suburbs.

Be quick to take this opportunity and secure this outstanding home.

4 BED | 2 BATH | 2 CAR

PRICE:

\$870,000

OPEN FOR INSPECTION:

N/A



Vincent Haupt

0409704667

vin@atrealty.com.au

www.atrealty.com.au

5 Stockfield Avenue CLYDE

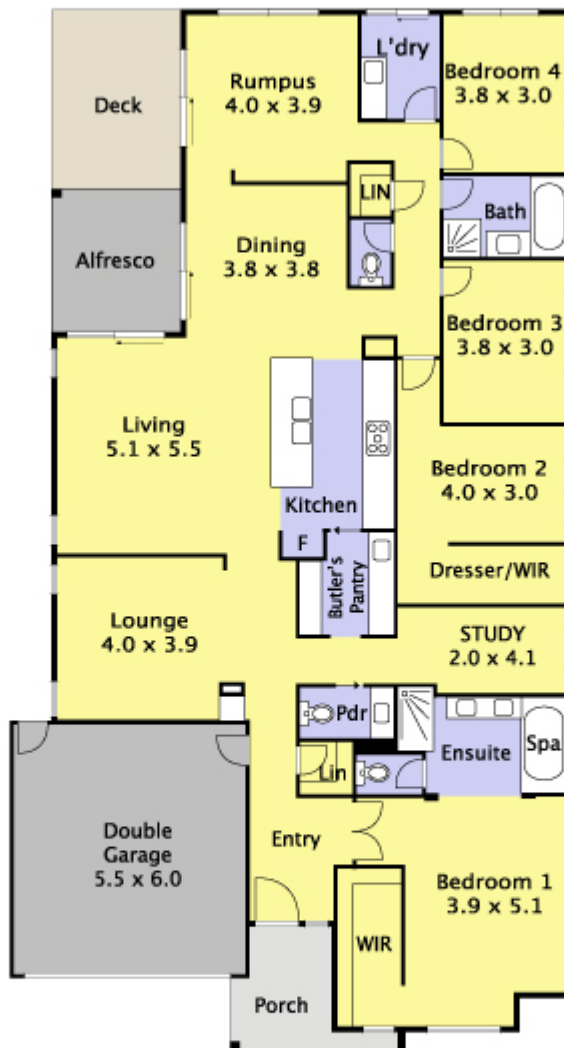

While every precaution has been taken to verify this information, it does not constitute any representation by the agent or vendor.

Disclaimer: Please note this floor plan is for marketing purposes and is to be used as a guide only. All dimensions are estimates only and may not be exact measurements.