



FOR SALE

"INVERARY PARK" A HISTORICAL PIECE OF TREASURE ETCHED INTO AUSTRALIAN HISTORY, LAST SOLD IN 1853

"INVERARY PARK" - A Magical Piece of Australian History

- * First settled Circa 1820
- * Last sold in 1853 - Owned by the same family today.
- * 460 Hectare property Located within 2 hours of Sydney, 30 mins to Goulburn and about 1.5 hours to Canberra
- * Historic Convict Built Homestead, built in 1834 - 6 bedroom 2 level home with ensuite, Spacious living areas.
- * 2 Outbuildings with Large Open Fire, laundry and shower. Basement/Wine Cellar
- * Original slab hut built in 1821 still on site.
- * 3 Stand Shearing Shed, Shearers Quarters - 2 bedrooms, bathroom, laundry, fireplace
- * Workshop + 2 x Machinery sheds & 2 Open bay sheds,
- * Spring/bore, 9 dams, 200,000 litres Water Tanks.
- * Options and suitable locations on site for an Air Strip
- * Carrying capacity 8.4 DSE (Dry Sheep Equivalent) per hectare.

(Inspections strictly by prior appointment only.)

Exclusive Listing Agent: Elias Sleiman on 0438184127

6 BED | 3 BATH | 7 CAR

PRICE:

Contact Agent

OPEN FOR INSPECTION:

N/A



Elias Sleiman

0438184127

elias@atrealty.com.au

www.ruralnational.com.au

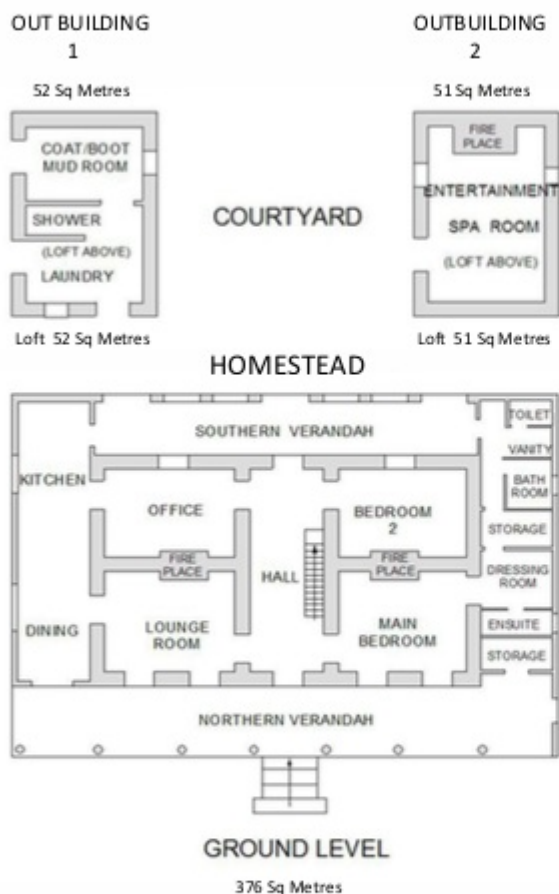

NB: Square Metres (Sq) approximate



INVERARY PARK
FLOOR...S.docx

Disclaimer: Please note this floor plan is for marketing purposes and is to be used as a guide only. All dimensions are estimates only and may not be exact measurements.