



SOLD

UNDER OFFER PENDING FINANCE--- CONTEMPORARY FAMILY HOME IN A MELBOURNE'S FAST GROWING SUBURB

It is without doubt that you will always find space to relax in this distinctive 38 squares approx. Carlisle built home. This substantial property has been architecturally designed, and offers a flexible floor plan that could easily accommodate the needs of an extended family. Two years young, this home comprise 5 bedrooms and 5 living zones plus a undercover alfresco for outdoor entertainment.

Worth to mention:

- 2.7m approx. Ceiling height to the Ground Floor and 2.6m approx. to the First Floor
- Guest Bedroom Downstairs and a Master with Ensuite, WIR and a Balcony on the first floor
- Large Open Plan Living Area Incorporating Dining and Large Living Room
- Stainless Steel Kitchen Appliances, Stone Benchtops (excluding laundry) and a Walk-in Pantry
- Brivis Ducted Heating with Add-on Brivis Evaporative Cooling Systems
- Floor to Ceiling Tiles to Bathrooms, Floorboards to Entry, Kitchen, Meals & Living
- Remote Controlled Double Lock-up Garage and a Undercover Alfresco Overlooking the Backyard
- Numerous of Choices of Education Providers and Massive Shopping Precinct in Close Proximity
- 456m² approx. land, 38.5 Squares or 358m² approx. building area, built in 2019

5 BED | 3 BATH | 2 CAR

PRICE:
\$888,000

OPEN FOR INSPECTION:
N/A



Dustin Tian
0433759026
autian@atrealty.com.au
www.atrealty.com.au

23 Pebblestone Circuit, Clyde North

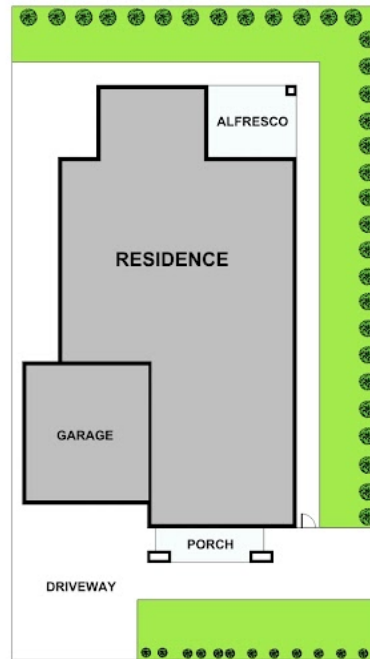

SITE PLAN



GROUND FLOOR



FIRST FLOOR

Disclaimer: Please note this floor plan is for marketing purposes and is to be used as a guide only. All dimensions are estimates only and may not be exact measurements.