

SOLD

BACK ON THE MARKET! GET IN QUICK!

Positioned in an enviable location in Mudgeeraba this single level family with a fresh, neutral aesthetic, sophisticated modern features and inclusions positioned on an approx. 2000sqm block in a quiet family friendly location.

Perfect for those who appreciate space without too much upkeep. Located in a discreet pocket of Mudgeeraba, the property offers beautifully appointed finishes, spacious living and tasteful contemporary elegance.

Featuring high ceilings, a bright neutral interior and an impressive floor plan, you will fall in love from the moment you drive up to the house. Families will love the flexibility, privacy and numerous options that the floorplan affords. Spacious open plan living and dining areas additional to the separate lounge area which services the three double bedrooms, perfect for a kids or teenagers area, private and quietly tucked away.

The spacious master bedroom is thoughtfully located at the back of the home with its own large walk-in robe, ensuite and heaps of natural light.

The outdoor entertaining area flows from the internal entertaining areas proving an ideal space for entertaining with family and friends enjoying summer barbeques.

There is ample room and access to add a pool or large shed if desired.

Homes of this quality on a large block close to all the conveniences of the Gold Coast are rare to come by.

Features:

Contemporary chef's kitchen with quality appliances including dishwasher, 900mm Smeg gas oven and cooktop

Stone benchtops

Butler's pantry, ample cupboard space and breakfast bar

Enormous open plan living and dining space

Spacious master bedroom with walk-in robe and ensuite featuring double shower, bath, double vanity and toilet

3 additional queen size bedrooms with built-in robes and ceiling fans

Main bathroom with shower, bath, vanity and toilet

Additional living space ideal for kids or teenagers

Separate laundry with stone benchtop and direct access outside

Tiled outdoor alfresco entertaining area with ceiling fan

Fenced flat grassed area with ample room and access for swimming pool

4 BED | 2 BATH | 2 CAR

PRICE:

\$1,250,000

OPEN FOR INSPECTION:

N/A



Conrad Hyslop

0427674262

conrad@atrealty.com.au

www.atrealty.com.au

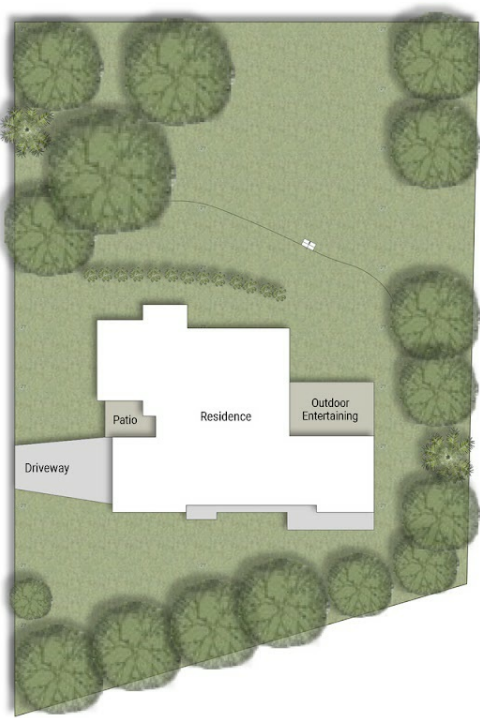

2a Nonga Court, Mudgeeraba.

Internal: 285m² | External: 44m² | Total: 329m²

Conrad Hyslop
0427 674 262



Plans shown are only indicative of layout. Dimensions are approximate.

Disclaimer: Please note this floor plan is for marketing purposes and is to be used as a guide only. All dimensions are estimates only and may not be exact measurements.

Conrad Hyslop
0427674262
 conrad@atrealty.com.au
www.atrealty.com.au

