



SOLD

PRACTICAL FAMILY ENTERTAINER

Promoting practicality with its open and airy design, this sunlit and spacious home provides the perfect family lifestyle with dual living zones and plenty of outdoor space for entertaining throughout the year.

Freshly painted and fitted with new carpets, the home is ready to be enjoyed and relishes a wonderful single level layout that leads you from the front door through to an inviting formal lounge room.

Large windows bring a sense of joy and vitality to the open plan kitchen, meals and family room where tiled flooring flows underfoot and stainless steel appliances are complemented by a dishwasher and breakfast bench.

Carried along the side of the home, the huge alfresco entertaining zone is ideal for hosting get-togethers with family and friends and offers direct access out to the level backyard where children can play in the sunshine.

Meeting the family's accommodation needs are the three robed bedrooms plus study/4th bedroom, with the master bedroom boasting a walk-in-robe and ensuite accompanied by a family bathroom, separate toilet and full-sized laundry.

Benefitting from the added appeal of ducted heating, split system air conditioning, garden shed, trailer/boat parking plus a double garage with internal access.

Enjoying outstanding family convenience, near Stud Park Shopping Centre, Rowville Primary, Rowville Secondary, extensive parkland, buses plus Monash and EastLink Freeways.

Photo ID required at all open for inspections.

3 BED | 2 BATH | 2 CAR

PRICE:
\$915,000

OPEN FOR INSPECTION:
N/A



Marko Ghattas
0403170130
marko@atrealty.com.au
www.lucianorealty.com.au

5/148 Waradgery Drive ROWVILLE

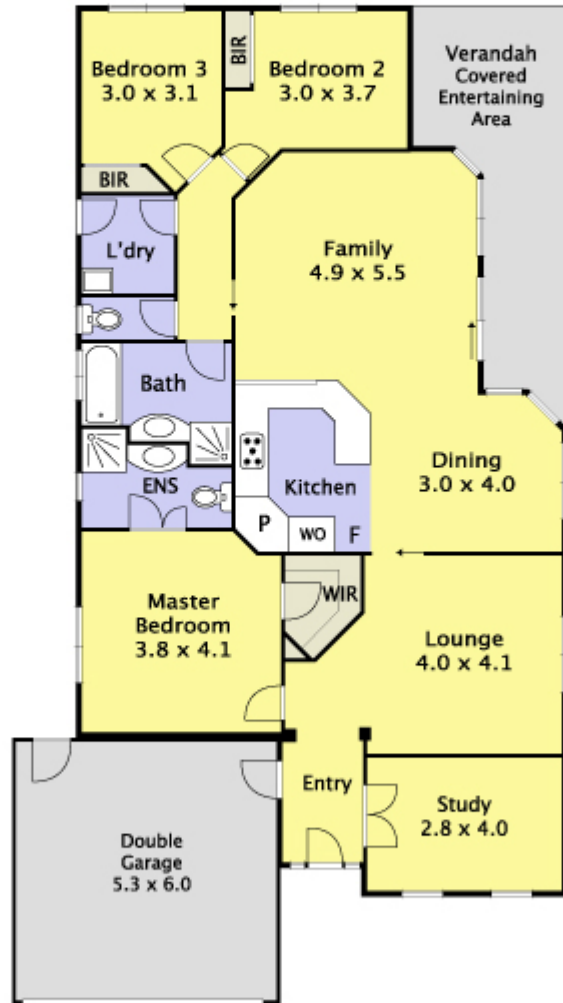
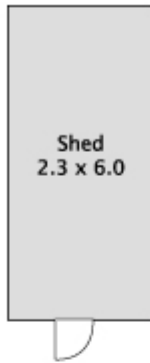

"While every precaution has been taken to verify this information, it does not constitute any representation by the agent or vendor".

Disclaimer: Please note this floor plan is for marketing purposes and is to be used as a guide only. All dimensions are estimates only and may not be exact measurements.