

FOR SALE

THIS CLASSIC SPACIOUS HOME IDEALLY SITUATED IN CLEVELAND, ON 977SQM BLOCK WITH ITS PRIVATE BACK YARD, CAN BECOME YOUR PRIVATE OASIS.

An Entertainers dream, combining indoor and outdoor living.
 The Spacious kitchen flows to the laundry and dining area.
 4 Large bedrooms, 2 with walk in robes, and ceiling fans.
 A Well laid out separate, Main bathroom, toilet, and hand basin, to accommodate all the family.
 Master bedroom with en-suite.
 Multiple living areas.
 Undercover, fully enclosed outdoor and barbeque area.
 Double lock up garage, with built in wall to floor cupboards, and an extra carport.
 Security screens throughout, and a fully fenced back yard.
 Airconditioned, master bedroom and family areas.
 Multiple linen cupboards.
 Extra toilet in the laundry.
 Shed to house, all gardening tools.
 6 kw solar panels.
 Possible splitter block. (Subject to council approval)
 Room for a pool.

This house has all you would need for a growing family or a gardener's dream. Privacy, position, suitable for all those needing extra storage, looking for a big block, to kick a ball, build a vegie patch, or possibly a granny flat, the list goes on.
 Not to mention a position that is all a few minutes' drive to, the waterfront, Raby Bay Marina, Cleveland Central Shopping Centre, 7 minutes to the Cleveland train station, and the beautiful Lighthouse. Multiple schools to pick from in the area. A 5-minute walk and you have reached the Henry Ziegenfusz Park.
 There are plenty of reasons to inspect this fantastic property.
 Please give me a call if you wish to know more about this unique property.

4 BED | 2 BATH | 3 CAR

PRICE:
Property Preview

OPEN FOR INSPECTION:
N/A



Alice Vazanellis
0409490480
 alice@atrealty.com.au
www.atrealty.com.au

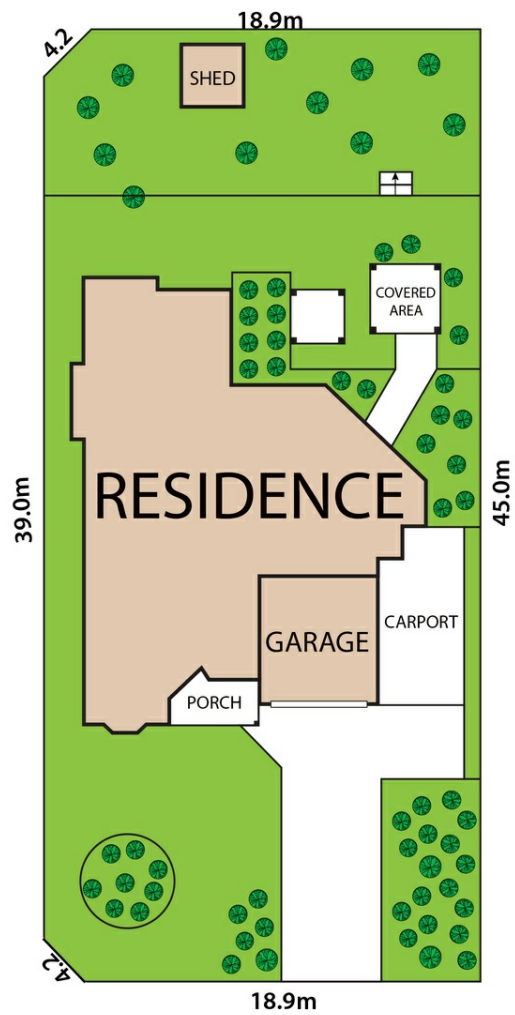
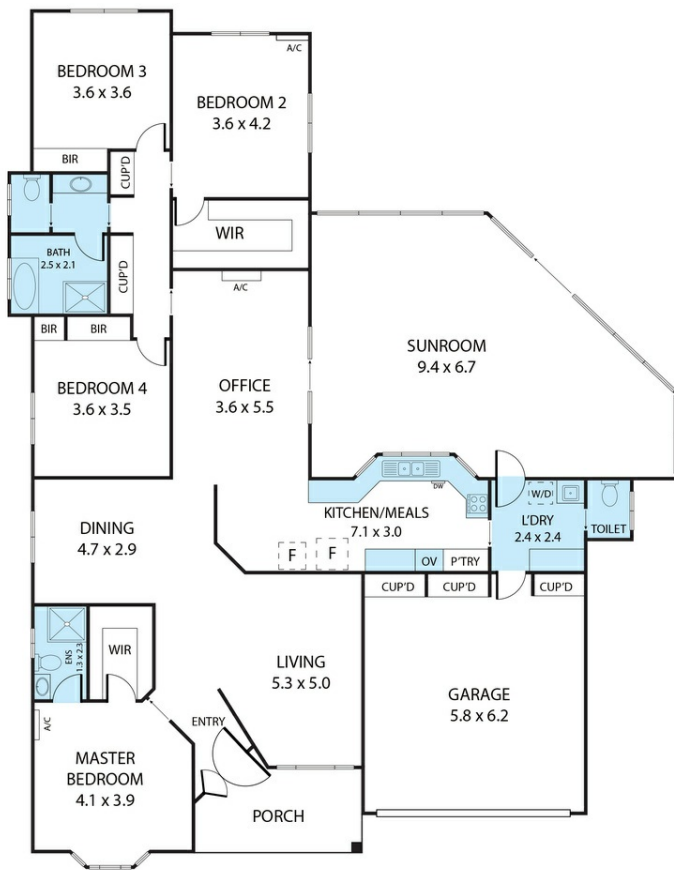

Total:
977.0m²

56 Long Street, Cleveland 4163

Whilst every attempt has been made to ensure the accuracy of the floor plan contained here, measurements of doors, windows, rooms and any other items are approximate and no responsibility is taken for any error, omission, or misstatement. This plan is for illustrative purposes only and should be used as such by any prospective purchaser.

Disclaimer: Please note this floor plan is for marketing purposes and is to be used as a guide only. All dimensions are estimates only and may not be exact measurements.