



SOLD

CASHMERE RETREAT

Presenting to the market this exclusive haven situated in the sought after estate of Greenwoods. This home offers privacy and seclusion complete with wallabies and koalas.

Positioned at the end of a quiet cul-de-sac this home offers a lifestyle of elegance, sophistication and tranquillity, from the moment you enter you will appreciate the ambience of home.

Immaculately presented inside and out, this architecturally designed home boasts four generous bedrooms, three bathrooms and a study there is plenty of room for the growing or extended family. The Master bedroom spoils you with a walk-in robe as well as an additional built in robe, double shower, his and hers vanity and access to the deck/pool whilst waking up to the sounds of nature. Bedrooms two and three are generous in size and offer built in robes and fans. Bedroom four is downstairs with its own ensuite and external access.

Within the open plan living area is a functional kitchen with gas cooking appliances, dishwasher and walk in pantry designed to meet the demands of modern living and entertaining. The family cook will feel a part of the festivities boasting servery bi-fold windows out to the expansive alfresco deck whilst overlooking the sparkling inground saltwater pool with a back drop of bushland.

Entertaining is a breeze bringing the outside in with large bi-fold glass doors, huge entertaining deck and three separate living areas you are spoilt for choice. This home offers the versatility to be arranged to suit your needs with the additional creature comforts of ducted air conditioning, polished timber floors, high angle ceilings and well positioned windows you will love it!

Call Natalie today to arrange a private inspection, you will not be disappointed.

At a glance:

- Extensive use of glass to capitalise on the outlook
- Ducted Air Conditioning
- Polished Timber Floors
- Expansive Deck and Alfresco Entertaining area
- 3 Living Areas Plus Study
- Inground Saltwater Pool

4 BED | 3 BATH | 2 CAR

PRICE:
\$799,000

OPEN FOR INSPECTION:
N/A



Natalie Johnston
0419689309
natalie@atrealty.com.au
[Natalieatrealty](#)

Whilst every attempt has been made to ensure the accuracy of the floor plan contained here, measurements of doors, windows rooms and any other items and structures are approximate and no responsibility is taken for any error, omission or mis-statement. Bathroom and kitchen fittings, cupboards and door types and laundry appliances and windows are tokens and approximate the actual fitting installed.
 This plan is for illustrative purposes and should be used as such by any prospective buyer.
 Plan drawn by Eagle Eye Photography Service, www.eagleeyeHQ.com.au Copyright 2018.
 All rights reserved.
 No reproduction without license, contact photographer for more information.

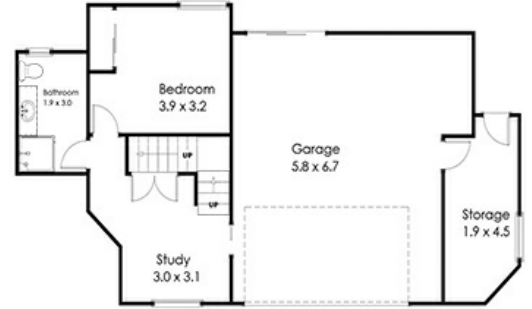

10 Pheasant Circuit Cashmere 4500

10 Pheasant Circuit Cashmere 4500

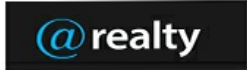

Disclaimer: Please note this floor plan is for marketing purposes and is to be used as a guide only. All dimensions are estimates only and may not be exact measurements.

Natalie Johnston
 0419689309
 natalie@atrealty.com.au
[Natalieatrealty](https://www.atrealty.com.au)

