

49 TUDOR COURT, EDITHVALE, VIC, 3196



SOLD

PERFECT LOCATION

With an abundance of potential to create something unique in a secretive location adored by locals, this brilliant home truly has it all. A fresh and functional update unites with an old-world character and charm, with soaring ceilings and a certain cottage appeal only adding to the allure of this quaint and private home.

A well-designed floorplan consists of a large formal lounge, separate dining and kitchen area with induction cooking and dishwasher, inviting the imaginative new owner to open the space and maximise the space on hand, with two roomy and robed bedrooms, the master with walk-through robe to the dual-access bathroom sitting to one side. The potential inside to renovate further will bring instant value to most buyers, while outside the rear yard's vast reach is overlooked by the covered and paved entertainment area, the perfect place to enjoy a morning coffee or the afternoon sun.

A remote double garage, three rainwater tanks, underfloor heating, refrigerated cooling, split-system air conditioning in the living room finish a wonderful home, backing onto the Edithvale Wetlands, and moments from Rossdale and Edithvale Public golfing, chic cafes and bars, boutique shops, Edithvale Station and Primary School, and the exceptional Edithvale Beach.

2 BED | 1 BATH | 2 CAR

PRICE:
\$730,000

OPEN FOR INSPECTION:
N/A



Brodie Morris
0414001040
morrisresidential@atrealty.com.au
www.atrealty.com.au

49 Tudor Court, Edithvale

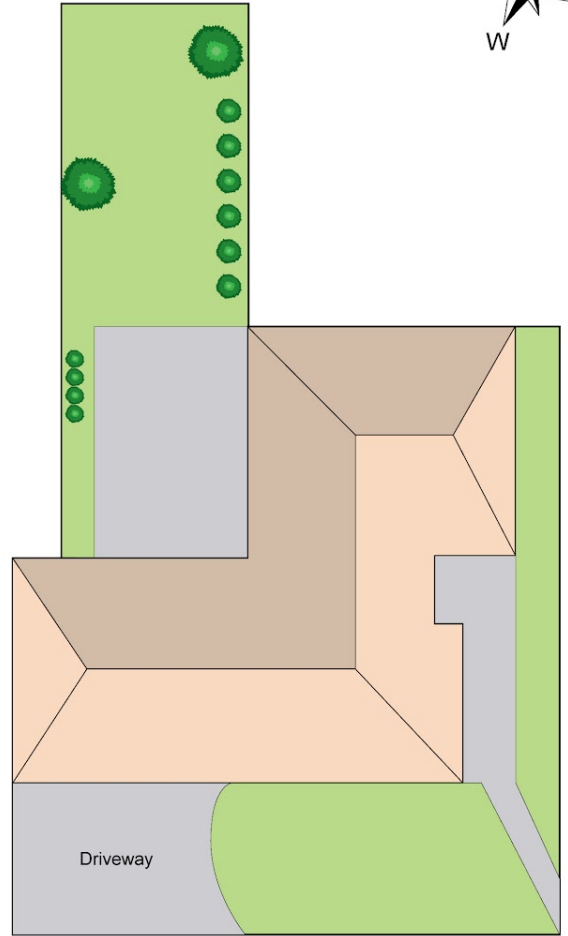
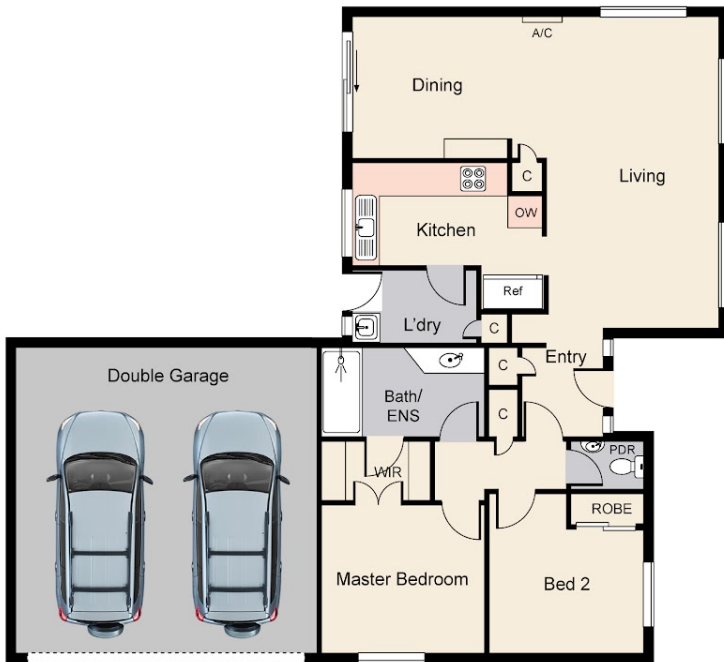

Disclaimer: Floor Plan measurements are approximate and are for illustrative purposes only.

Disclaimer: Please note this floor plan is for marketing purposes and is to be used as a guide only. All dimensions are estimates only and may not be exact measurements.