



SOLD

BEAUTIFUL FAMILY HOME OR INVESTMENT PROPERTY FOR CHRISTMAS?

Looking for an Investment Property or Place to call home within the Beautiful Nambucca Valley prior to Christmas?

Welcome to 4 Cottage Close.

This Newly Renovated 3 Bedroom Property with detached Office/Studio is ready to for you to move straight in and make your own.

Positioned neatly on a 603sqm approx. block, set back from the street within a family friendly Cul-de-sac in the heart of Nambucca Heads, this property is ideally located within seconds to designated walking tracks which lead to Nambucca's Finest River, Clubs, Parks, Cafes, Shopping, Education and Health Facilities.

Boasting new "Hybrid" Flooring Throughout, Freshly Painted, and newly installed and equipped kitchen ensures there is neither time nor money to spend for the future owner.

The Main residence offers a generous size bathroom, 3 bedrooms with Built-ins while the Detached Original Builders Shed has been lovingly and extensively renovated into a versatile space that along with toilet and shower facilities within the Garage, offer both present and future floor plan flexibility, ideally lending itself to the professional or as a teenage retreat for the growing family.

The Outdoor Undercover area and low maintenance fully fenced, tiered backyard will have you spending more time enjoying the outlook rather than maintaining lawns while the Reverse Cycle Air Conditioning is sure to keep you cool in summer and warm in winter, without the worry of rising power prices as the large 6.6kw Solar System will keep electricity costs to an absolute minimum.

Opportunities in the current Market are scarce.

Call now and secure an inspection to your future Nambucca Heads Lifestyle.

4 BED | 1 BATH | 1 CAR

PRICE:
\$640,000

OPEN FOR INSPECTION:
N/A



Simon McPherson
0432073130

simonmcpherson@atrealty.com.au
www.atrealty.com.au

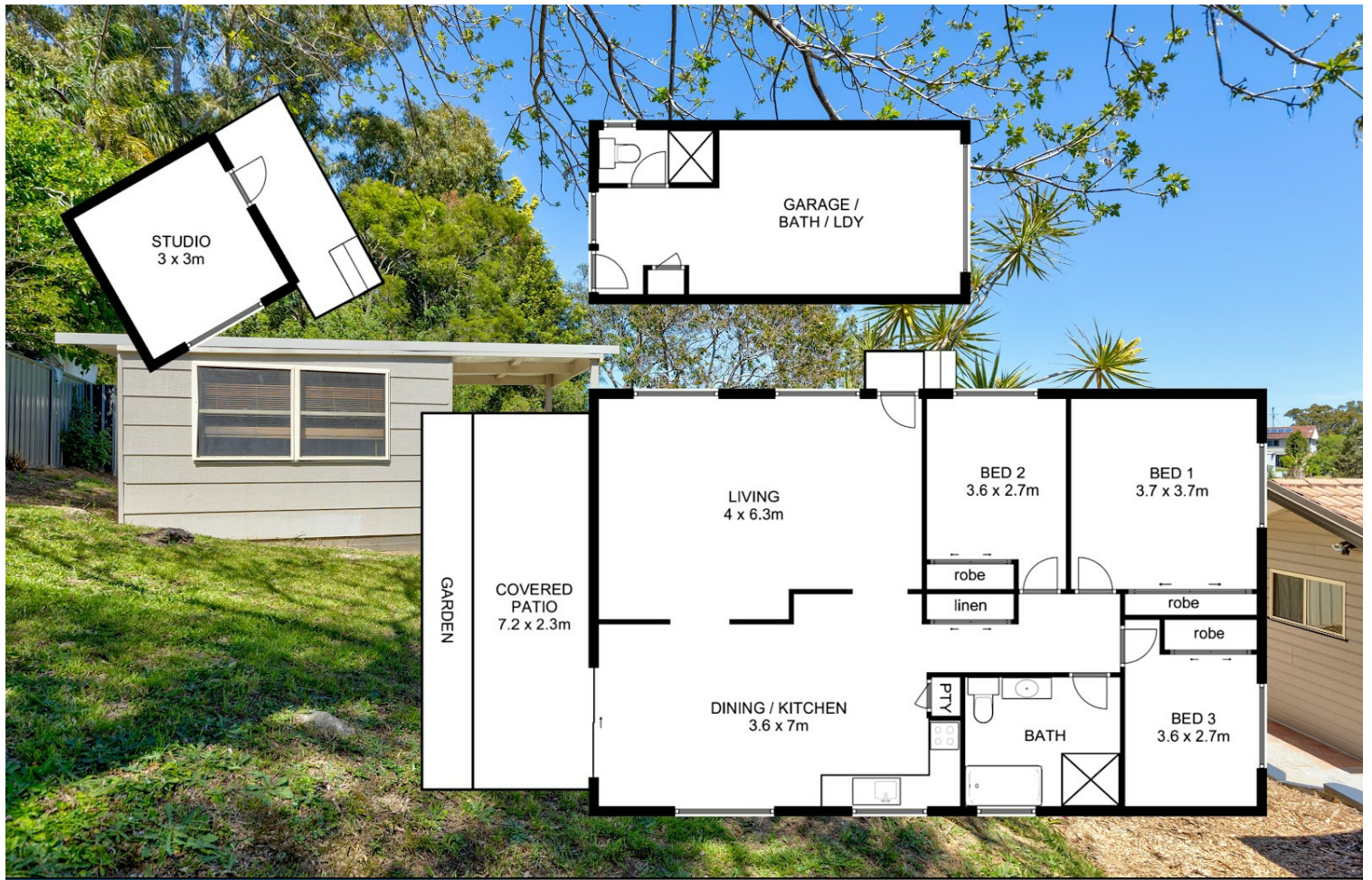

@realty

4 Cottage Close, Nambucca Heads NSW

Disclaimer: Please note this floor plan is for marketing purposes and is to be used as a guide only. All dimensions are estimates only and may not be exact measurements.

Simon McPherson
0432073130
simonmcpherson@atrealty.com.au
www.atrealty.com.au

@realty