



SOLD

TRENDY APARTMENT - LINEAR PARK LOCATION

- * Enjoy a Fantastic Lifestyle ! With Linear Park right on your doorstep you can Walk, Jog, Ride your Bike or just Sit, Relax and Listen to the Birds Sing.
 - * The apartment comprises of an open plan living and dining area with reverse cycle air conditioning and sliding door leading out to Alfresco Area.
 - * Well appointed modern kitchen, quality stainless steel Bosch appliances, dishwasher and plenty of cupboards.
 - * There are two spacious bedrooms both with reverse cycle air conditioning and mirror built-in robes.
 - * The large roomy bathroom has a double shower, vanity and toilet, the modern European Style Laundry is compact and tucked away behind bi-fold doors.
 - * Outside we have a paved and covered Alfresco Area for entertaining and BBQ's, and one allocated carparking space.
 - * This Immaculate 2 bedroom ground floor apartment is located close to the O'Bahn and only a short drive to St Peters Bakery, Walkerville Shopping Center & City and would be an Ideal 1st Home, Investment or Retirement Retreat.
 - * Call Terry Webster (your local agent) on 0419 993 357 for more information or a private inspection.
- RLA 269823

2 BED | 1 BATH | 1 CAR

PRICE:
\$365,000

OPEN FOR INSPECTION:
N/A



Terry Webster
0419993357
terrywebster@atrealty.com.au
www.atrealty.com.au
RLA: 269823

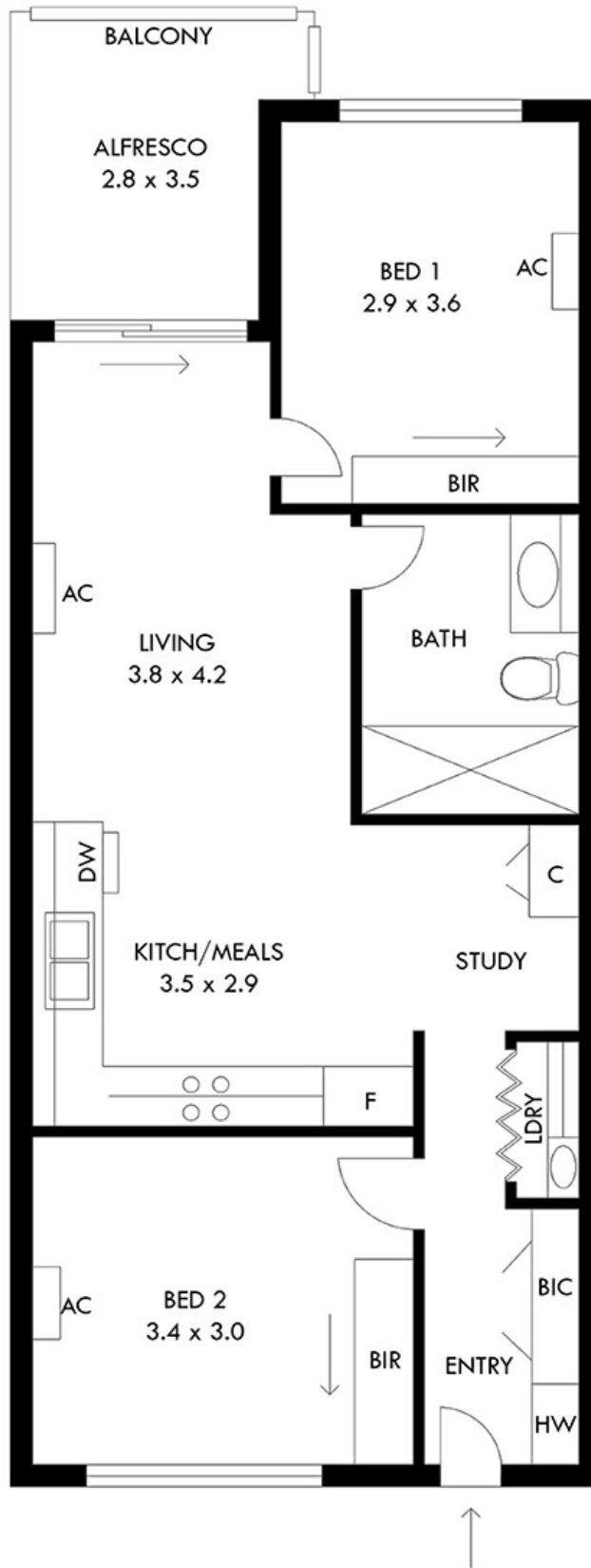

AREA (Approx.)	m ²
LIVING	57.6

Disclaimer: Please note this floor plan is for marketing purposes and is to be used as a guide only. All dimensions are estimates only and may not be exact measurements.

1- 9 Arabella Ct, Marden

Terry Webster
 0419993357
 terrywebster@atrealty.com.au
www.atrealty.com.au

