

# FOR SALE

## BIG BLOCK, POTENTIAL, POSITION

With approx. 25 metre frontage on this great 1012m2 block you will be full of ideas to make this your perfect home. The house is in need of a full renovation so you can choose the look you want. The space inside the house is generous for a 3 bedroom home with formal lounge, dining and kitchen.

The three bedrooms are a great size and there is plenty of room for extending or build a granny flat in the huge yard. Side access is possible on both sides of the house and it's a great high position in a great street. Walking distance to the hyperdome, restaurant's and bus stop.

Beyond the 1012m2 grounds, enjoy the spoils of this quiet and leafy suburb just 27 mins from the CBD and about 30 minutes to the Gold Coast. This premium Shailer Park location offers proximity to local shops like the Hyperdome and cafes, along with quality schools such as St Matthews, Chisholm College, John Paul College and Calvary Christian College. You can even walk to public transport options.

Call Leanne to secure a booking to view this great property.

3 BED | 1 BATH | 2 CAR

PRICE:  
SUBMIT OFFERS

OPEN FOR INSPECTION:  
N/A



**Leanne Smith**  
**0428750122**  
leannesmithproperty@atrealty.com.au  
[www.atrealty.com.au](http://www.atrealty.com.au)

### Note

This plan is an illustration  
and is to be used as a guide  
to layout only.

Room dimensions are  
approximations.

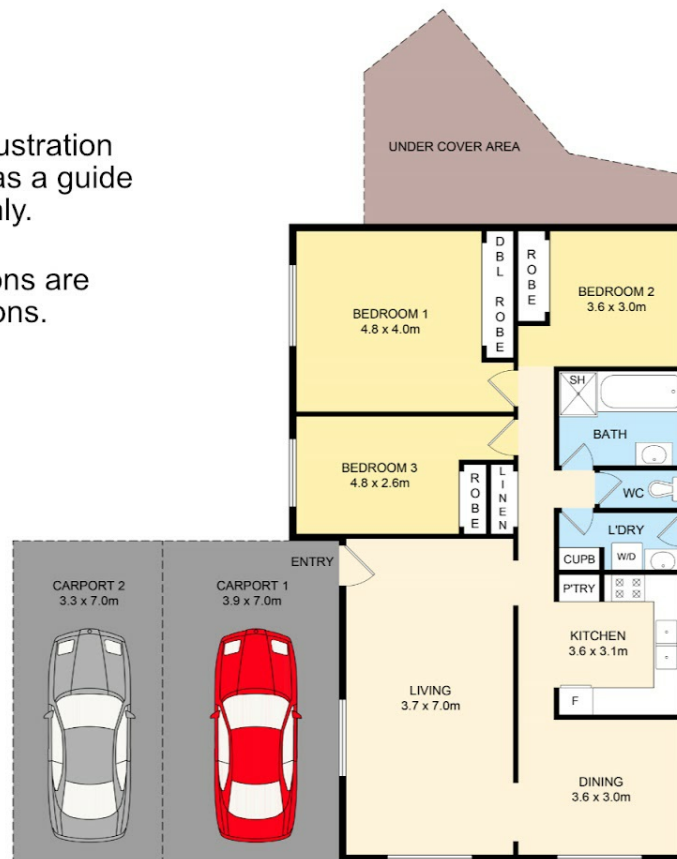

58 BORAMBIL ROAD

Disclaimer: Please note this floor plan is for marketing purposes and is to be used as a guide only. All dimensions are estimates only and may not be exact measurements.