



SOLD

WALKING DISTANCE TO THE BEACH IN NORTH HAVEN!

Positioned on a generous 727m2 block with access to rear yard via drive through garage, this unique home offers endless versatility and opportunity to enhance, renovate and engage the wonderful lifestyle on offer, perfectly located between the beach, river, and shops.

The moment you walk into this home you notice the large open plan living with lots of natural light filtering through the windows along with the ocean breezes.

- Large kitchen with island bench, electric cook top and oven, dishwasher, and plenty of cupboard and bench space.
- Neat and tidy original bathroom with shower/bath
- Light and airy master bedroom, walk in wardrobe with bathroom access.
- 2nd bedroom has access to the rear sunroom, ceiling fan and built in wardrobe
- 3rd bedroom has built in wardrobe and ceiling fan
- Gas bayonet for heater in living area
- Rear yard access via drive through garage
- Solar hot water system
- Inground concrete swimming pool
- rear covered sunroom perfect for summer BBQ's and entertaining near the pool.
- Level backyard, fully fenced and set on a generous 727m2 block
- Single garage with plenty of extra storage space suitable for bikes, tinny, or motor bike.

Conveniently situated 100m to Camden Haven River and 900m to Grants Beach, this central address offers easy access to schools, parks, buses, cafes (Brew haven Café only at end of Edith St, perfect for morning coffee). and restaurants. The lifestyle location has plenty to offer with village shopping, coastal walkways and beaches, as well as direct route to Port Macquarie (via Ocean Drive).

RATES:
Port Macquarie Hastings Council rates: Approx \$2800 p.a
Rental potential: \$480pw to \$500pw

3 BED | 1 BATH | 1 CAR

PRICE:
\$760,000

OPEN FOR INSPECTION:
N/A



Jenny - OLD Magill
0490403052
jennymagill@atrealty.com.au
jennymagill.com.au

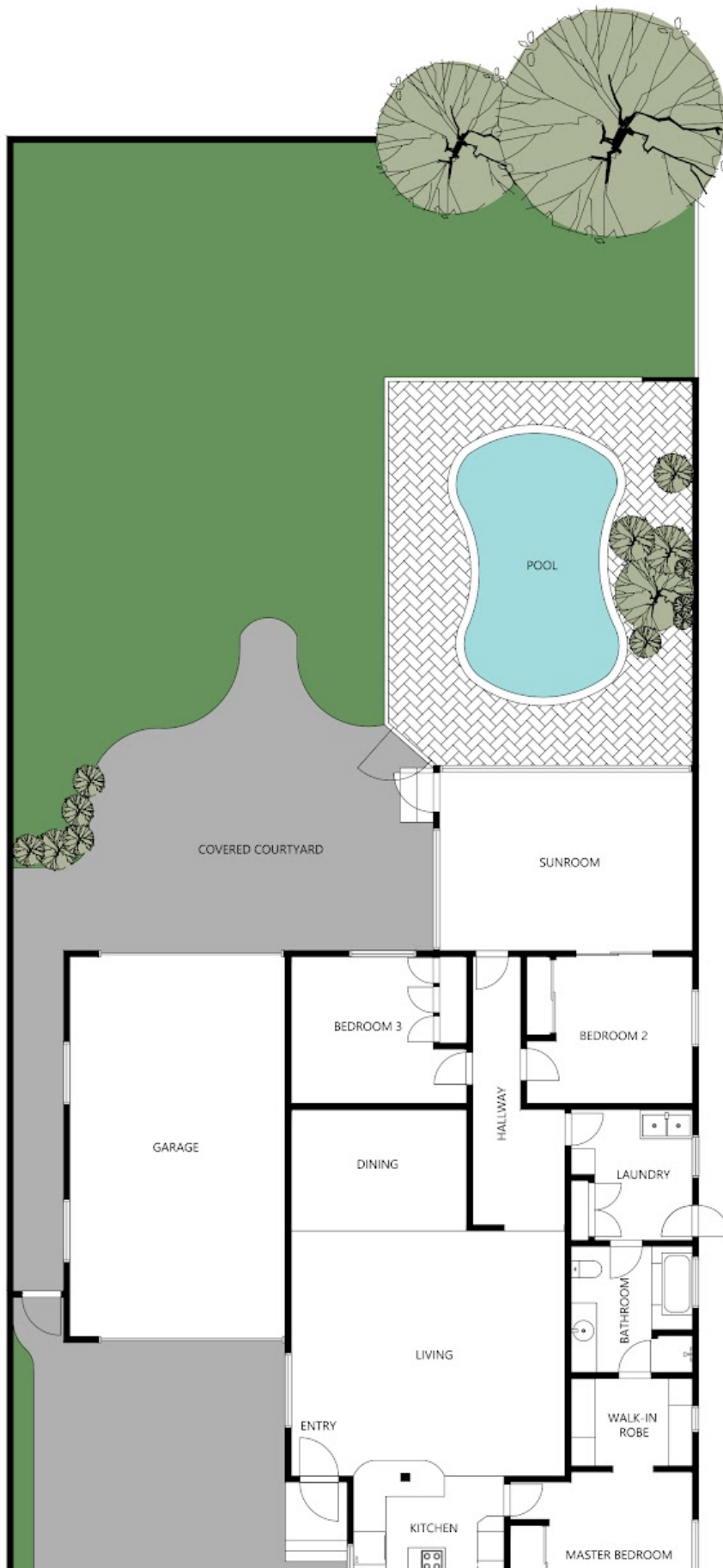

Disclaimer: Please note this floor plan is for marketing purposes and is to be used as a guide only. All dimensions are estimates only and may not be exact measurements.

Jenny - OLD Magill
0490403052
jennymagill@atrealty.com.au
jennymagill.com.au

@realty



GROUND FLOOR

FLOOR PLAN IS PROVIDED AS INDICATIVE LAYOUT ONLY. MEASUREMENTS ARE NOT AVAILABLE. FLOORPLAN IS NOT TO SCALE.
NO GUARANTEES PROVIDED ON ACCURACY