

SOLD

SOLD IN 6 DAYS IN FULL LOCKDOWN

4 Buyers just missed out on this property and are ready to buy now in Cape Paterson - contact us ASAP

For more detailed information on this property visit the dedicated property website at 1pinnacleclose.com

Locations In Cape Paterson Don't Come Much Better Than This

Fully renovated and ready for you to move straight in and enjoy! You'll love the hardwood floors on the upper and lower living areas, the custom timber vanities with washbasins commissioned by Matilda Chambers to compliment the brass tapware and porcelain tiles, and the hidden European laundry that vanishes leaving nothing but clean lines - we could go on, but most of all you are going to LOVE the lifestyle that this very special location in Cape Paterson provides.

Situated on the fringe of the Cape Eco Development you'll benefit from the amazing granitic sand walk & cycleways that traverse the region all the way down to the beaches that are accessible from a gate in your own back garden! Just park the car and forget everything! The creature comforts are here too with a stunning new kitchen with a 6 burner gas oven and stone bench tops and pantry. The upper living also features a powder room and WC as well as new reverse cycle heating and cooling on both upper and lower levels and a state of the art heat pump hot water system with an oversize tank to make sure you never run out of hot water when you and your guests are showering of the sand from your beach walks.

Act quickly and register and qualify NOW as locations like these are rare in Cape Paterson.

4 BED | 1 BATH | 2 CAR

PRICE:
\$836,000

OPEN FOR INSPECTION:
N/A



Leo Edwards
0472523445
leo@atrealty.com.au
www.atrealty.com.au

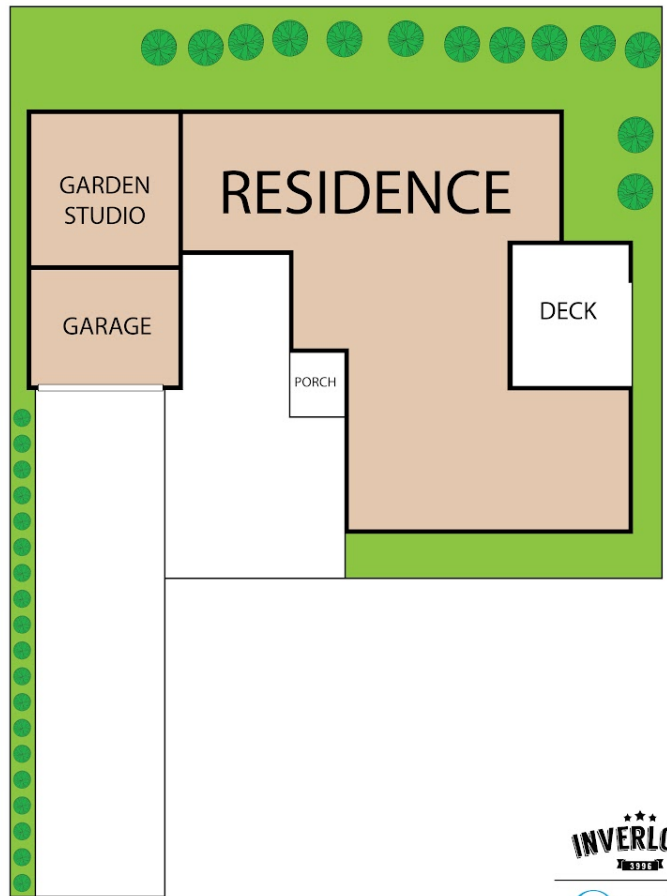
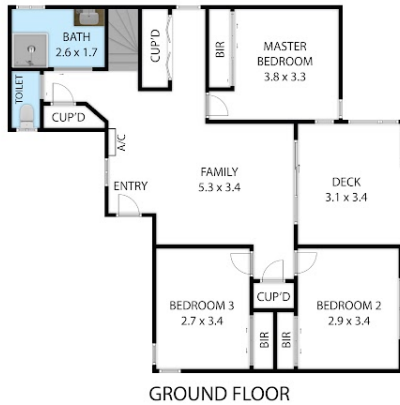
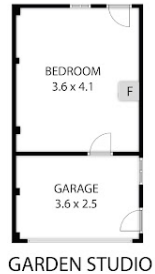

Unit 2/1 Pinnacle Close, Cape Paterson 3995
TOTAL APPROX. FLOOR AREA 131 SQ.M

Whilst every attempt has been made to ensure the accuracy of the floor plan contained here, measurements of doors, windows, rooms and any other items are approximate and no responsibility is taken for any error, omission, or misstatement. This plan is for illustrative purposes only and should be used as such by any prospective purchaser.

INVERLOCH
RESIDENTIAL

@realty

Disclaimer: Please note this floor plan is for marketing purposes and is to be used as a guide only. All dimensions are estimates only and may not be exact measurements.

Leo Edwards
0472523445
leo@atrealty.com.au
www.atrealty.com.au

@realty