

# 1/17 POOLE ROAD GLASS HOUSE MOUNTAINS



## FOR SALE

### CUITE 3 BED DUPLEX IN THE BEAUTIFUL GLASSHOUSE MOUNTAINS

This wonderful warm light filled 3 bed duplex in the Glasshouse Mountains is walking distance to the school and shops. Stunning views of the Glasshouse Mountains at your doorstep with walking tracks and lookouts to explore.

This single side of the duplex is 3 bedrooms, 2 bathrooms with Ensuite for the master and a single garage, with exclusive fully fenced backyard. It is in a quiet location with quality fresh air and the sound of birds singing in the trees. There is also additional parking space for another car in the driveway.

The station is less than 1km away with trains to Brisbane and Nambour so is great for commuters.

Half an hour to Caloundra that is 31km away

33 minutes to Mooloolaba

1 hour to Brisbane CBD driving and one hour 10 minutes via the train

An inspection is a must if your looking to get into the market.

Rates are approximately \$2,100pa

Body corporate is just the building insurance shared between the other owner. The cost of this is about \$900pa. No admin, sinking fund or body corporate manager.

**3 BED | 2 BATH | 2 CAR**

#### PRICE:

Offers in the mid \$550,000's

#### OPEN FOR INSPECTION:

N/A



**Chris Pullen**

**0434449455**

[chris.bluewaveproperty@atrealty.com.au](mailto:chris.bluewaveproperty@atrealty.com.au)

[www.atrealty.com.au](http://www.atrealty.com.au)

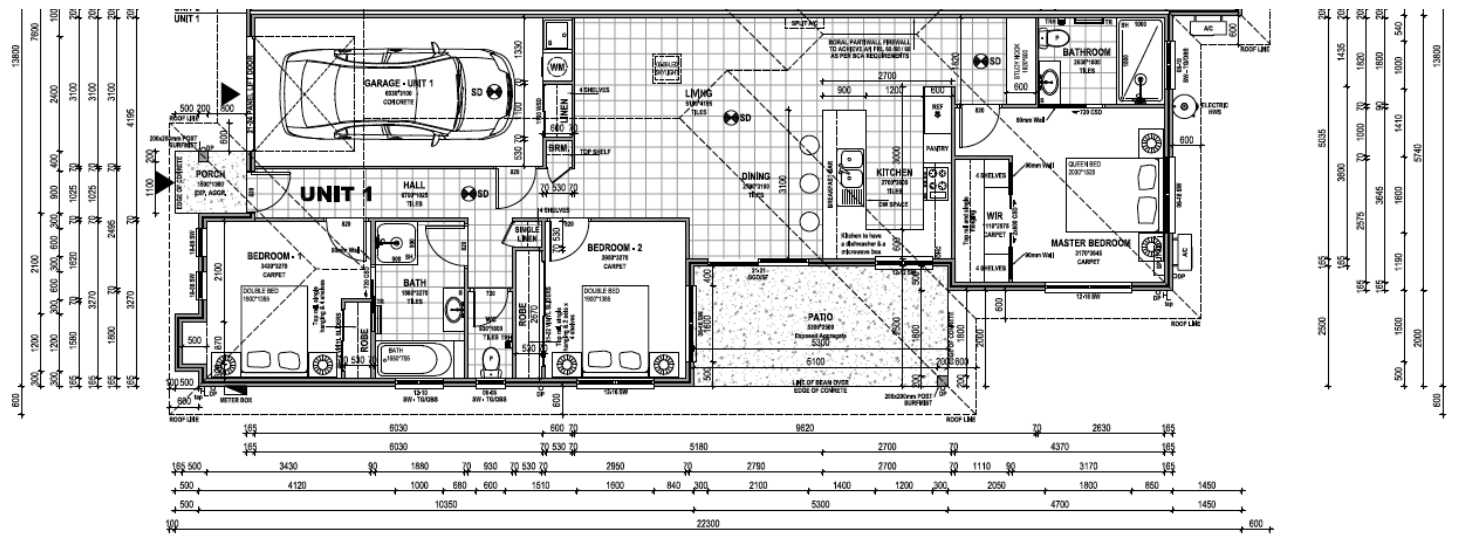

Disclaimer: Please note this floor plan is for marketing purposes and is to be used as a guide only. All dimensions are estimates only and may not be exact measurements.