



SOLD

**IF SIZE COUNTS - COUNT ON THIS ONE !
OPTIONS GALORE & SO MUCH MORE ! 2339 M2**

- A GENUINE LARGE FAMILY HOME IS WHAT WE HAVE ON OFFER.
- Blue ribbon location, set amongst quality homes in a desirable neighborhood
- Designed to seamlessly combine multiple open plan living spaces featuring 9 foot ceilings
- Separate front entry to home business / bedroom / granny flat/ gym area offers versatility (S.T.C.A.)
- Massive established garden area, ideal for enjoying family activities and room for a pool or two.
- Spacious Original kitchen boasting storage galore, updated appliances & amazing bench space
- Master bedroom impresses with double door access, walk-in robe and en suite
- unique floor plan provides possibilities for blended families
- Near new ducted air conditioning ensures comfort and convenience
- Only 10 minutes to the lavis lane entry of 4 x 4 heaven Stockton Beach
- Enjoy beautiful sunrises and breezes from the premium elevated position
- Minutes to multiple Quality School options and down the hill to Pacific Dunes Golf Course
- Vendors are ready to commit elsewhere and we are priced to sell

Whilst all care has been taken in publishing this information all intending buyers must rely solely on their own inquiries prior to making any decision to purchase. The agent accepts no responsibility for any inaccuracy or omission

Current Covid 19 restrictions and protocols will be strictly observed

6 BED | 3 BATH | 4 CAR

PRICE:
\$1,150,000

OPEN FOR INSPECTION:
N/A



Tony Hoare
0432144148
tonyhoare@atrealty.com.au
www.atrealty.com.au

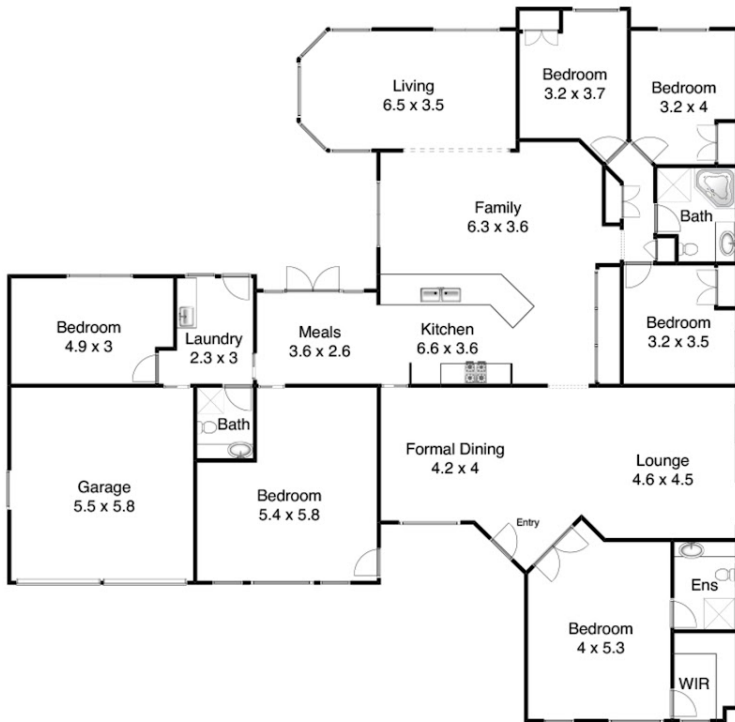

Site Plan

38 Sylvan Avenue,
Medowie



Measurements are approximate and are to be used as a guide only



Disclaimer: Please note this floor plan is for marketing purposes and is to be used as a guide only. All dimensions are estimates only and may not be exact measurements.

Tony Hoare
0432144148
tonyhoare@atrealty.com.au
www.atrealty.com.au

