

1105/72 GLENDOWER STREET GILEAD



FOR SALE

RETIREMENT NEVER LOOKED OR FELT SO GOOD

Features Include:

- Located in the popular gated community known as Gilead Retirement Village
- Caters to over 55's
- Integrated 24 hour emergency call system
- Entry video system
- Two generously proportioned bedrooms with built in robes
- Master suite includes an ensuite
- Study / activity room
- Expansive open plan living and dining
- Spacious balcony with spectacular views of lush greenery & includes an electric blind
- Well appointed galley style kitchen with ample cupboard & bench space
- Soft closing cupboards
- Fully integrated dishwasher
- LED touch control stainless steel oven
- Built in stainless steel oven
- Bright & airy main bathroom with floating vanity
- Internal laundry
- Ducted air conditioning
- Pet friendly (by request)
- Double car space
- Storage cage

Mount Gilead Retirement Village allows you to live out your retirement the way you want to. It's friendly community is widely known and its popularity has never wavered. You are spoilt for choice with the facilities they have to offer which include the community favourite..... The golf course! You have use of the state of the art wellness centre which includes low impact exercise equipment & a swimming pool. Enjoy a meal with your new friends at the clubhouse which has just been extended or check out the community shed. It has been designed to enrich your life. This home is one to put at the top of your inspection list.

Agency Central believes that all the information contained herein is true & correct to the best of our ability however we encourage all interested parties to carry out their own enquiries.

2 BED | 2 BATH | 2 CAR

PRICE:

\$540,000 - \$570,000

OPEN FOR INSPECTION:

N/A



Huss Al Salemi

0411699419

huss@atrealty.com.au

www.agencycentral.com.au

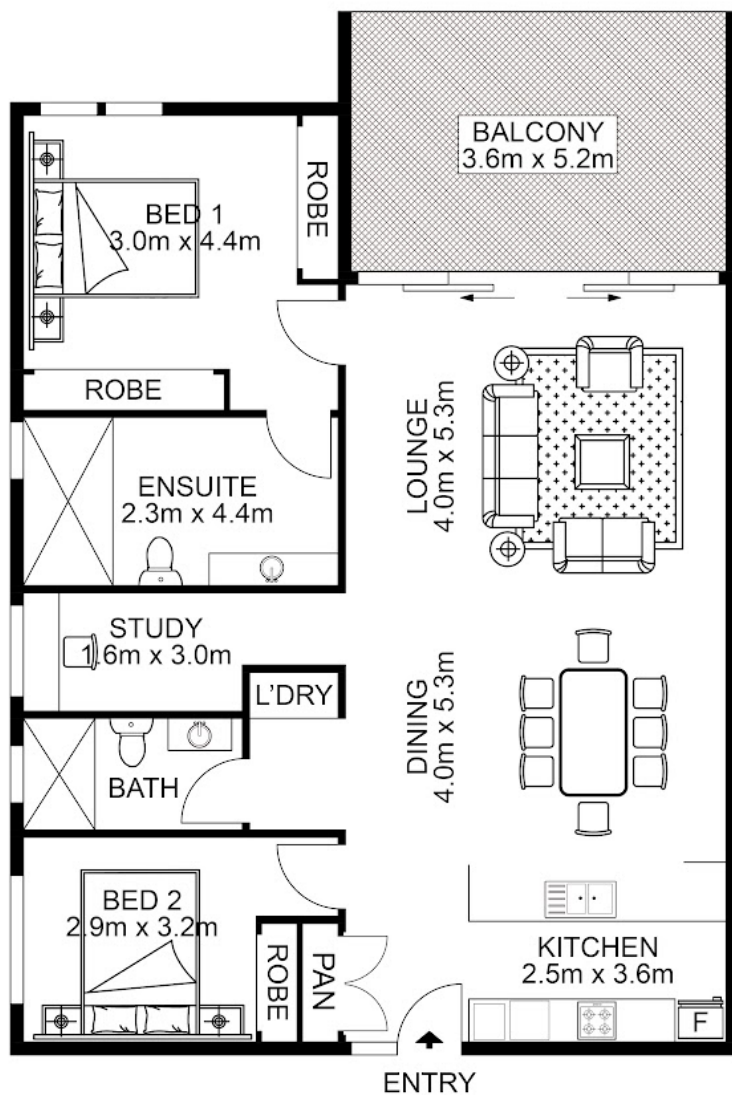

TOTAL SIZE
128m²

 AGENCY

Disclaimer: Please note this floor plan is for marketing purposes and is to be used as a guide only. All dimensions are estimates only and may not be exact measurements.

1105/72 Glendower Street, Gilead

Huss Al Salemi • All measurements are approximate • Drawn for marketing purposes only

0411699419

huss@atrealty.com.au

www.agencycentral.com.au

 @realty