



SOLD

LOW MAINTENANCE LIVING WITH JACUZZI ENTERTAINMENT!

- Call to book your inspection! See the advertised time available!
- Closing Date Sale! (Wed 27/10/21) Unless Sold Prior!
- QR Code Entry! Photo ID Upon Request!
- All Covid-19 Safety plans adhered to by the agent!

This magnificent 4Beds, 2Bath, 2Toilet, 2Living, with Alfresco terrace, hot tub spa bath and double garage is set on 417m2 and has its own street frontage. Comprising open plan kitchen with stone bench tops, stainless-steel appliances, Island bench with large breakfast bar and meals dining area, large spacious lounge living area with easy access to a sensational outdoor alfresco entertaining area.

Featuring a large & spacious alfresco area with separate Bali hut, 6-seater spa hot tub, just perfect for aching muscles, partying or relaxing with your favored beverage.

Other features include. Master with full ensuite, generous bedrooms all with robes, family bathroom room, laundry, and toilet, 2.7mtr ceilings, tiles to living areas, wet areas and entry, carpet to bedrooms, gas ducted heating, cooling, solar panels, plenty of storage cupboards, established garden and so much more.

Only an inspection will reveal the quality and feel of this unique size unit. Hurry! First to inspect will buy!

Thinking of selling now or in the future? For a free-market appraisal Call Lou 0417-166-668 / Leanne 0404-261 469 or email lou@atrealty.com.au Statement of information will be available upon request.

Disclaimer: Inspection times and property availability are subject to change without notice. All information contained herein is gathered from sources we believe to be reliable. We cannot guarantee its accuracy and interested parties should make and rely on their own enquiries.

4 BED | 2 BATH | 2 CAR

PRICE:
\$850,000

OPEN FOR INSPECTION:
N/A



Lou Rinnovasi
0417166668
lou@atrealty.com.au
www.atrealty.com.au

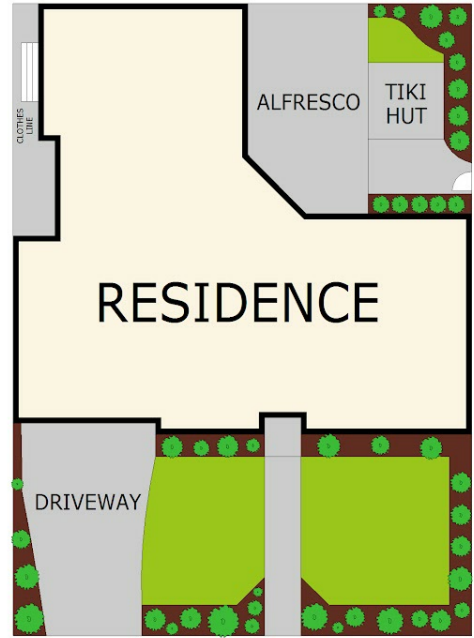

SITE PLAN

GROUND FLOOR



Scale in metres. Indicative only. Dimensions are approximate. All information contained herein is gathered from sources we believe to be reliable. However we cannot guarantee its accuracy and interested parties should rely on their own enquiries.

Residence	- 137 m ²
Garage	- 32 m ²
Alfresco	- 30 m ²
Tiki Hut	- 7 m ²
Total	- 206 m ²



1/19 Louisa Street, Kilsyth

Disclaimer: Please note this floor plan is for marketing purposes and is to be used as a guide only. All dimensions are estimates only and may not be exact measurements.