

6 CRACKNELL STREET, WILTON, NSW, 2571



**SOLD**

## PICTURE PERFECT

This brand new custom built Jeff Matthews Home has been designed with precision and sophistication. The quality of the home is evident upon entry, from the stunning coffered ceilings to its vibrant interiors can be adorned from room to room. Spread over an expansive floorplan, its use of space has been cleverly maximised to ensure the highest level of comfort and practicality is experienced throughout the home. Catered to those seeking an idyllic family lifestyle, this exquisite abode is sure to impress.

### Features Include:

- Front porch overlooks the manicured gardens
- Four generously proportioned bedrooms all with built in robes
- Master bedroom includes a walk in robe & ensuite with dual basins
- Study or 5th bedroom includes a built in robe
- Media room with access to the front porch
- Expansive open plan family & dining room
- Gourmet galley style kitchen with ample cupboard & bench space
- Breakfast bar overlooking the dining area
- 900ml Dual fuel black oven
- Gas cooktop
- Black dishwasher
- Butlers pantry with a second sink
- Quality fixtures & fittings
- Activity room / kids playroom
- Modern designed bathroom with freestanding luxury bath tub, dual basins & a frameless shower
- Powder room
- Laundry includes built in cabinetry
- Ducted air conditioning
- Extra wide hallways
- Coffered ceilings in both living rooms
- Tiled throughout
- Alfresco entertaining
- Low maintenance backyard
- Side access
- Triple garage with remote, internal access & drive through access to backyard

**4 BED | 2 BATH | 3 CAR**

**PRICE:**  
**\$1,420,000**

**OPEN FOR INSPECTION:**  
**N/A**



**Adam Bryant**  
**0455672323**  
adam@atrealty.com.au  
[www.atrealty.com.au](http://www.atrealty.com.au)

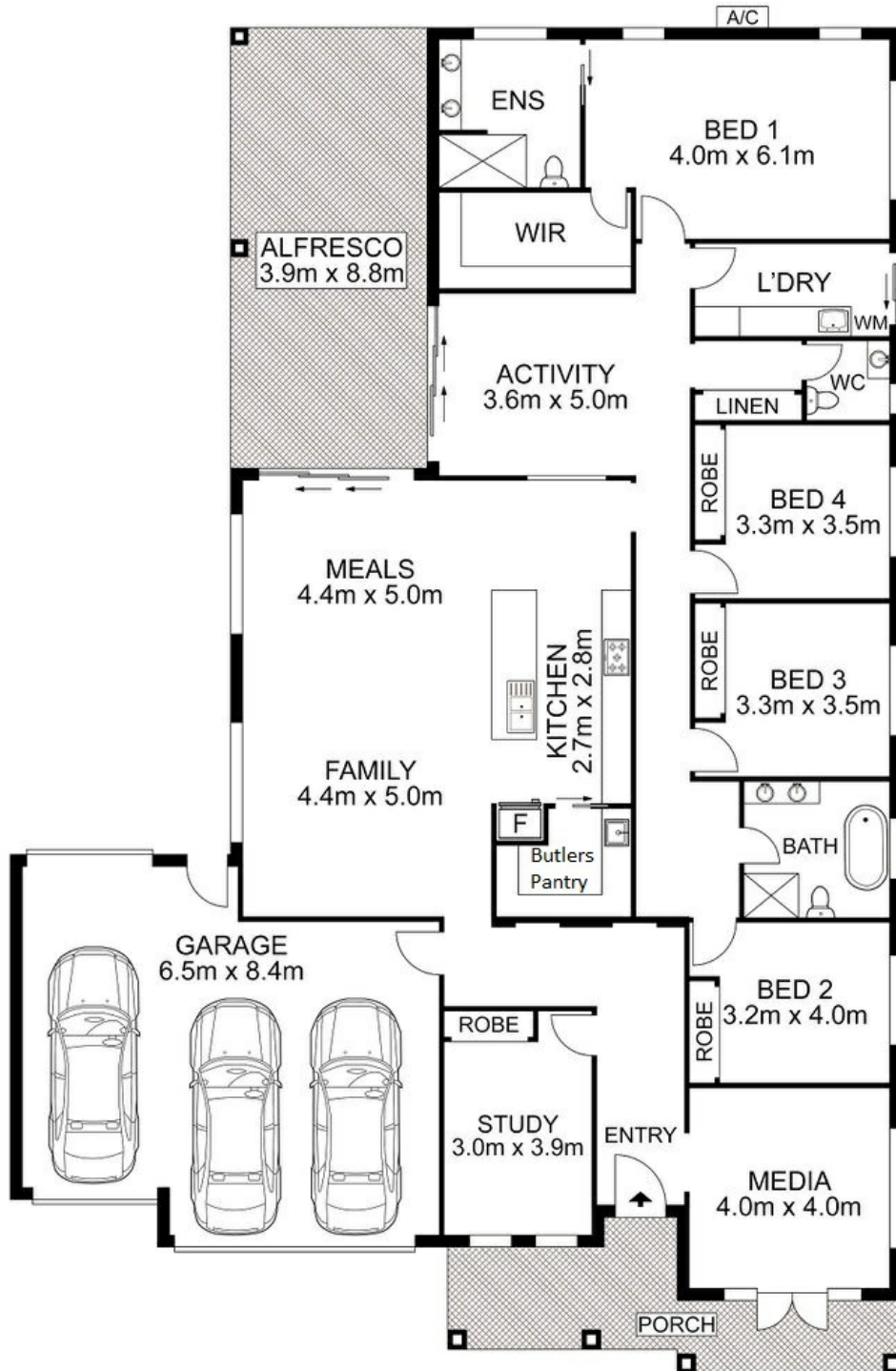

 AGENCY

Disclaimer: Please note this floor plan is for marketing purposes and is to be used as a guide only. All dimensions are estimates only and may not be exact measurements.

6 Cracknell Street, Wilton

Adam Bryant • All measurements are approximate • Drawn for marketing purposes only

0455672323

adam@atrealty.com.au

[www.atrealty.com.au](http://www.atrealty.com.au)

