

FOR SALE

WELCOME TO ORMEAU – THE PLACE TO LIVE

You could be living in this Gold Coast hidden gem, this beautiful highset Queensland style designed home is a cut above others. New to the market, built for a modern convenient family lifestyle featuring a large rear entertaining deck, six seat spa overlooking the serenity of a 'bush-change' escape and secure under house work area.

Features of the home includes:

- * Four (4) bedrooms all with ceiling fans
- * Separate lounge room with front porch access
- * Master bedroom with ensuite and walk-in wardrobe with air conditioned
- * Bathroom has separate shower and large bath
- * Galley kitchen with large pantry, ample cupboard space and dishwasher
- * Open plan kitchen dining with air conditioning and opening to the entertainment deck
- * Large private entertaining desk with access from the dining area
- * Landscaped gardens with watering system
- * Six (6) seat spa looking out over bush opposite
- * Under house double lock up garage
- * 5,000lt rain water tank
- * Security screens & door
- * Secure under house with large work area & benches
- * Fully fenced

About Ormeau

Ormeau is halfway between Brisbane and Gold Coast – very convenient to the Gold Coast beaches and Brisbane. Normally it takes 30-40 minutes (approximately) to get to Brisbane city and to the glorious golden beaches from Southport, Surfers Paradise and Broadbeach.

Local schools include State primary and high, Independent, Catholic and Christian Collage

Ormeau has just about got everything from Ormeau rail station, Coles shopping Centre only 4 min drive, childcares, parks only 2 min walk, doctors, dentists, vet, restaurants, skate park to country fairs, Christmas carols, free open air movie nights and heaps of other community activities, - you name it Ormeau's got it or getting it. Residents say 'It is so much fun to live in here - we love it', 'love it so quiet and good for family and good atmosphere'

4 BED | 2 BATH | 2 CAR

PRICE:

Offers over \$499,500

OPEN FOR INSPECTION:

N/A



Lynne Wenban

0409008272

lynnewenban@atrealty.com.au

www.atrealty.com.au

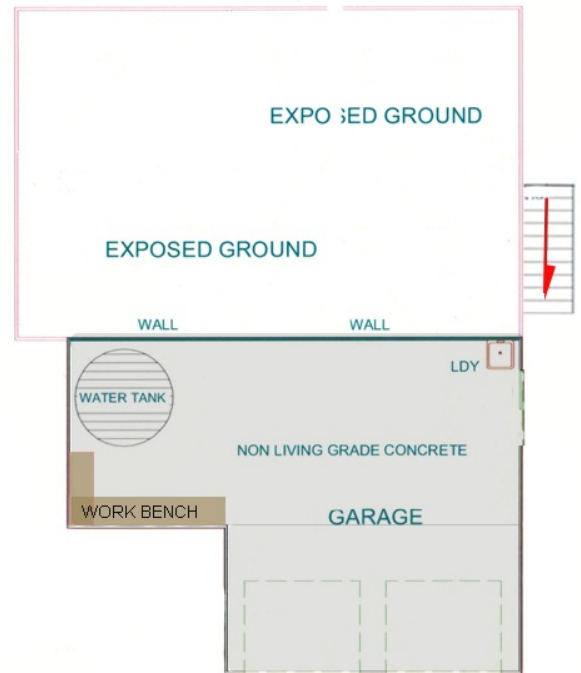

Disclaimer: Please note this floor plan is for marketing purposes and is to be used as a guide only. All dimensions are estimates only and may not be exact measurements.