



SOLD

EFFORTLESS ENTERTAINING INDULGENCE

Available for inspection by appointment only. Please contact the agent to arrange a time.

A showpiece of unrivalled entertaining excellence, this elite family home prides itself on delivering an array of stylish living zones that effortlessly amalgamate with outdoor entertaining to create a home for every season with a focus on carefree enjoyment.

Instantly contemporary, the home's extensive design delivers a wonderful sense of connection with a fashionable kitchen opening onto a huge dining zone and showcasing the glamour of stone benches, Bosch 900mm oven/stove, Miele dishwasher, plumbing for your fridge plus a deep breakfast bench.

A cohesive flow of space guides you through to the family room and adjacent rumpus room, while triple stacker doors stretch out from the three zones onto a covered entertaining deck and alfresco zone with adjoining synthetic turf and stylish firepit area with trickling water feature.

A fabulous mancave/home office complements the backyard and offers the perfect space for hobby enthusiast or to run a home business, while a study with fitted desk is further complemented on the ground floor by a theatre room boasts a projector, screen, recessed speakers and an extra study nook.

The addition of a powder room and laundry/3rd bathroom provide convenience for guests, while the upper level embraces a retreat plus four robed bedrooms, including a master bedroom with balcony, concealed walk-in-robe and dual vanity ensuite, supplemented by a spa bathroom and separate toilet.

Quality equipped with zoned ducted heating, evaporative cooling, split system air conditioning, ducted vacuum, hidden water tanks, alarm, CCTV cameras, high ceilings, extensive storage plus a double garage with internal access.

Peacefully placed whilst convenient to Heany Park Primary, Rowville Secondary, Wellington Village, Churchill-Waverley Golf Course, buses, reserves plus easy freeway access.

Photo ID required at all open for inspections.

5 BED | 3 BATH | 2 CAR

PRICE:
\$1,330,000

OPEN FOR INSPECTION:
N/A



Marko Ghattas
0403170130

marko@atrealty.com.au

www.lucianorealty.com.au

12 Perri Raso Rise ROWVILLE

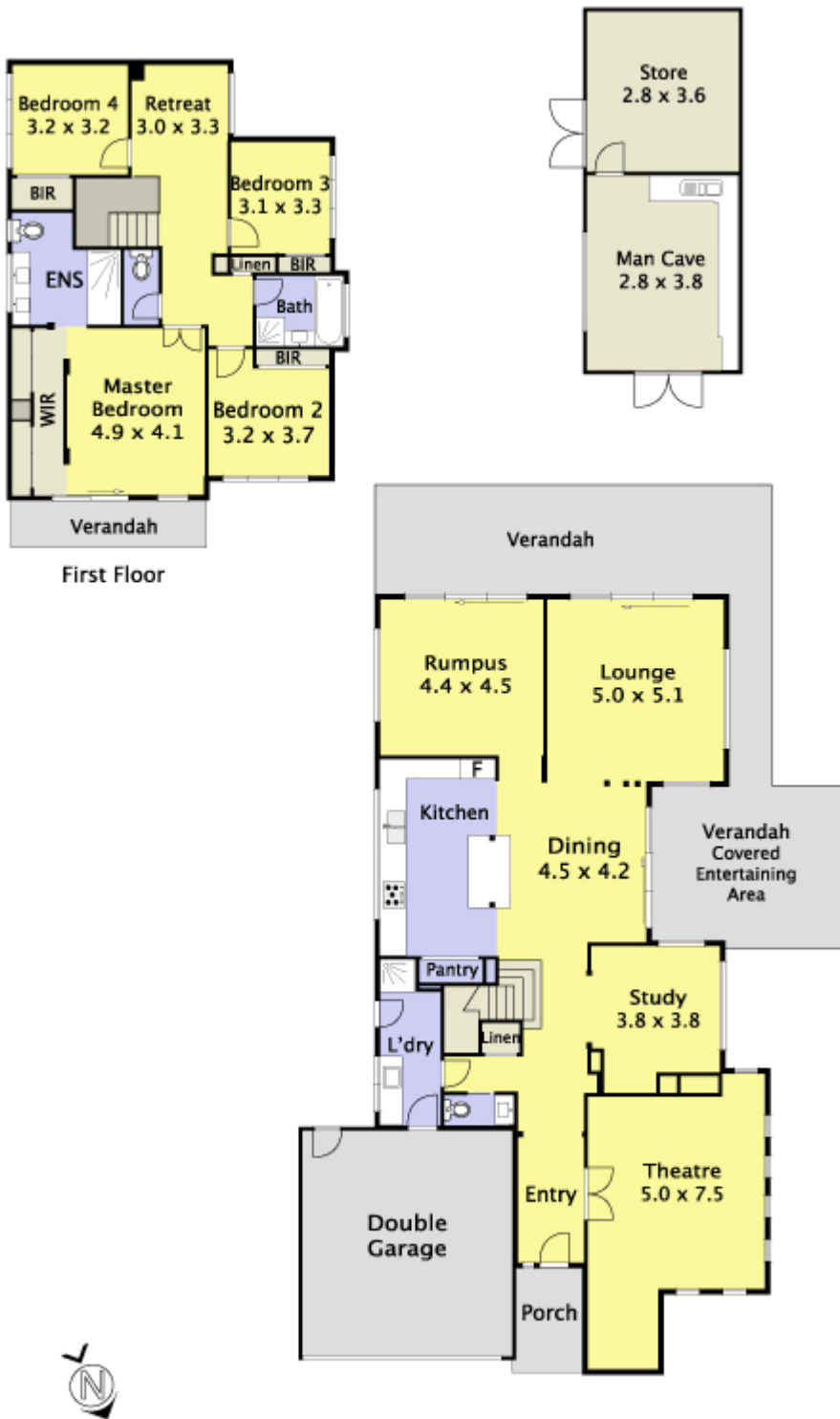

While every precaution has been taken to verify this information, it does not constitute any representation by the agent or vendor.

Disclaimer: Please note this floor plan is for marketing purposes and is to be used as a guide only. All dimensions are estimates only and may not be exact measurements.