

197 EXCELSIOR PARADE, HINDMARSH ISLAND, SA, 5214



SOLD

LAND, LOCATION, LEISURE AT ITS BEST - SOLD !

UNDER CONTRACT.....Imagine building your dream home or holiday / investment property (STCC) on this amazing allotment and living the DREAM !

This opportunity to secure a wonderful positioned, and preferred NORTH facing allotment on a WELL ELEVATED part of the Hutchinson Lagoon with wide SWEEPING VIEWS across and down the lagoon to the hills into the horizon and with sun setting views, is something to see to believe!

The property is surrounded by appealing many ELITE properties and has its own LARGER size, fully fitted jetty for your recreational boating pleasures - the building location for the home has a LEVEL footprint and positioned for great VIEWING and with this greater elevation provides UNRESTRICTED VIEWS 180 degrees!

The property frontage is quite adequate with provision for many building options (STCC) at 13 metres wide and the waterfront is 12.68 metres and land area comfortable at 692 Square Metres.

With the popular township of Goolwa only minutes away and easy bridge access, this is an OPPORTUNITY too good to miss!

So if it is LIFESTYLE you wish and to be in a PRESTIGIOUS section of Coorong Quays estate, ELEVATED and surrounded by QUALITY properties and the chance to build your OWN custom design home(STCC) , then don't miss this one, as its one of the last to offer these quality features and WATERFRONT allotments are VERY LIMITED to acquire!

COVID-19 - Regulations around the Covid-19 requirements are to be followed by all interested / third parties including the wearing of masks and you are advised not to make face to face contact or inspections if you are experiencing symptoms or awaiting a test result or received a positive test result.

Disclaimer - All information provided by the Agent, Agency and associates, is done in good faith and based upon provided information, but no warranties or assurances or guarantees regarding

0 BED | 0 BATH | 0 CAR

PRICE:
\$360,000

OPEN FOR INSPECTION:
N/A



Armin Breakwell
0401235590
xiting@atrealty.com.au
www.atrealty.com.au
RLA: 269823

DP 64849

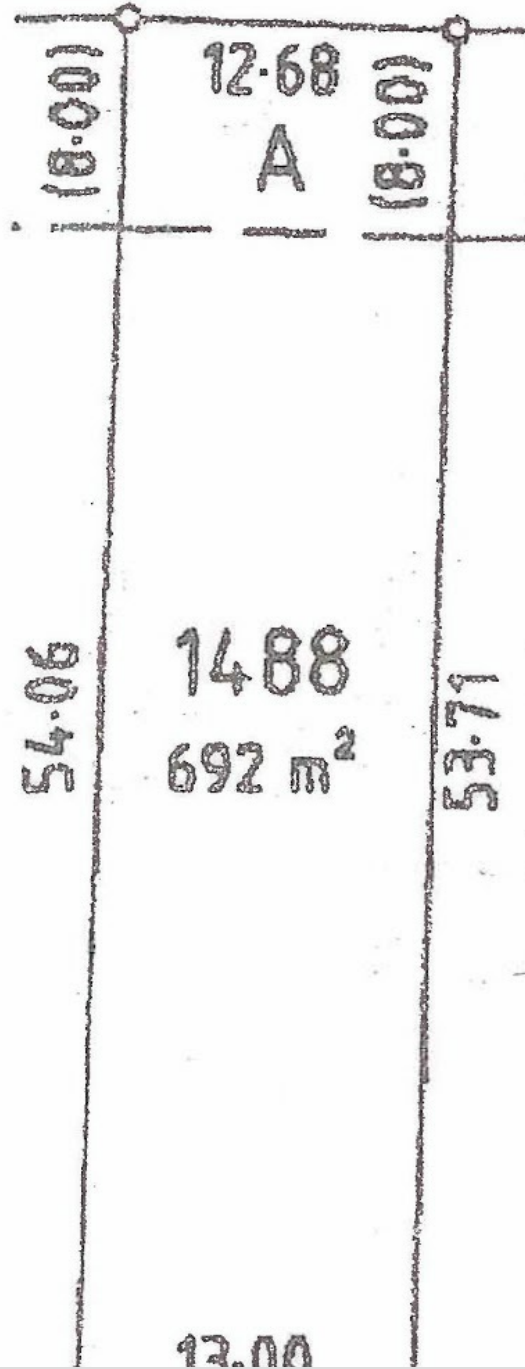

Disclaimer: Please note this floor plan is for marketing purposes and is to be used as a guide only. All dimensions are estimates only and may not be exact measurements.

